

Length  
Distance depends on  
Pieces the water @

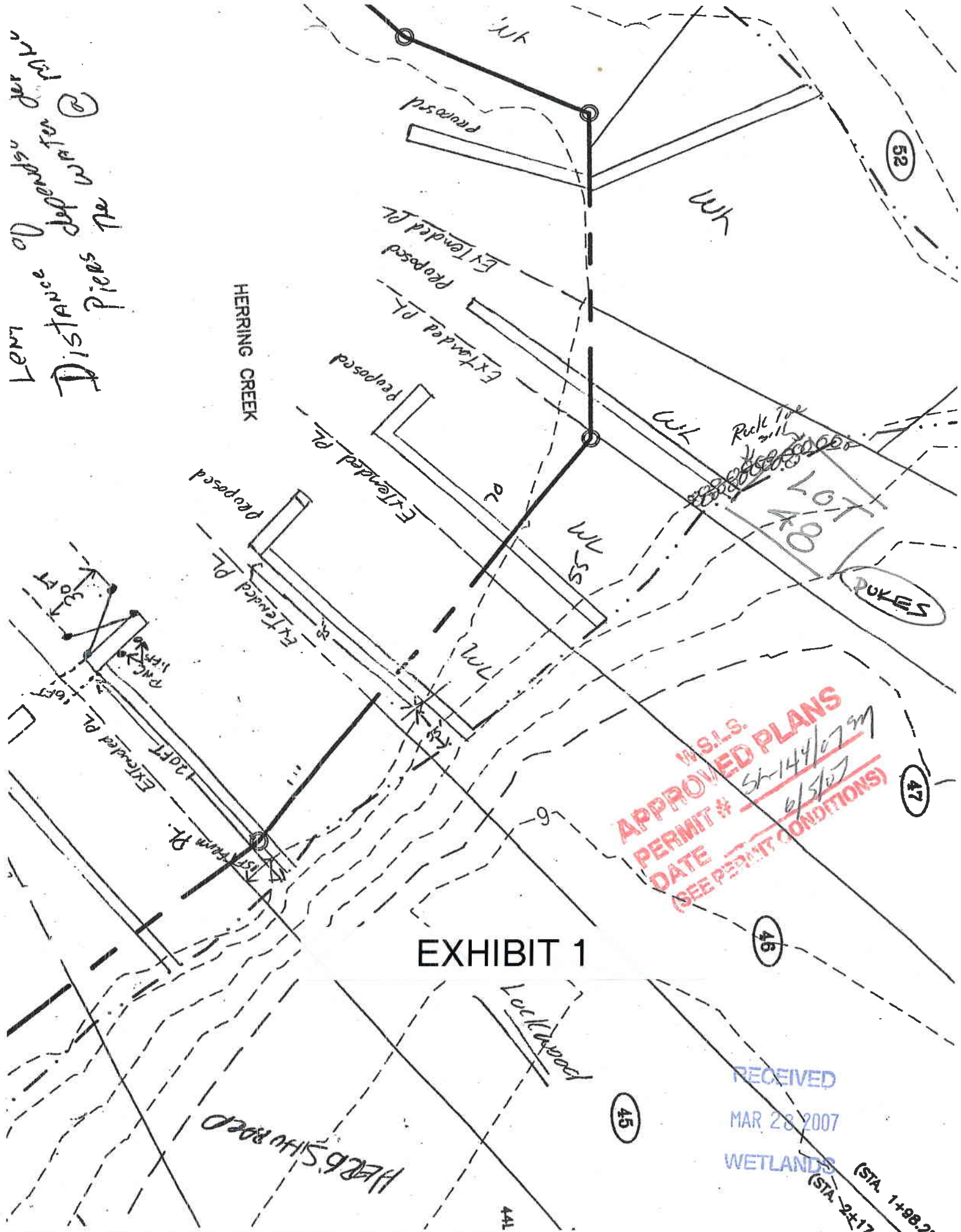

# EXHIBIT 1

MSLS  
**APPROVED PLANS**  
PERMIT # SH-144/07  
DATE 6/5/07  
(SEE PERMIT CONDITIONS)

RECEIVED  
MAR 28 2007

WETLANDS  
(STA. 1+98.2)  
(STA. 2+17)

HERB SILVIO ROAD

Lockwood

HERRING CREEK

52

47

46

45

LOT 48

DUKES

441

LOT 48



UPLANDS

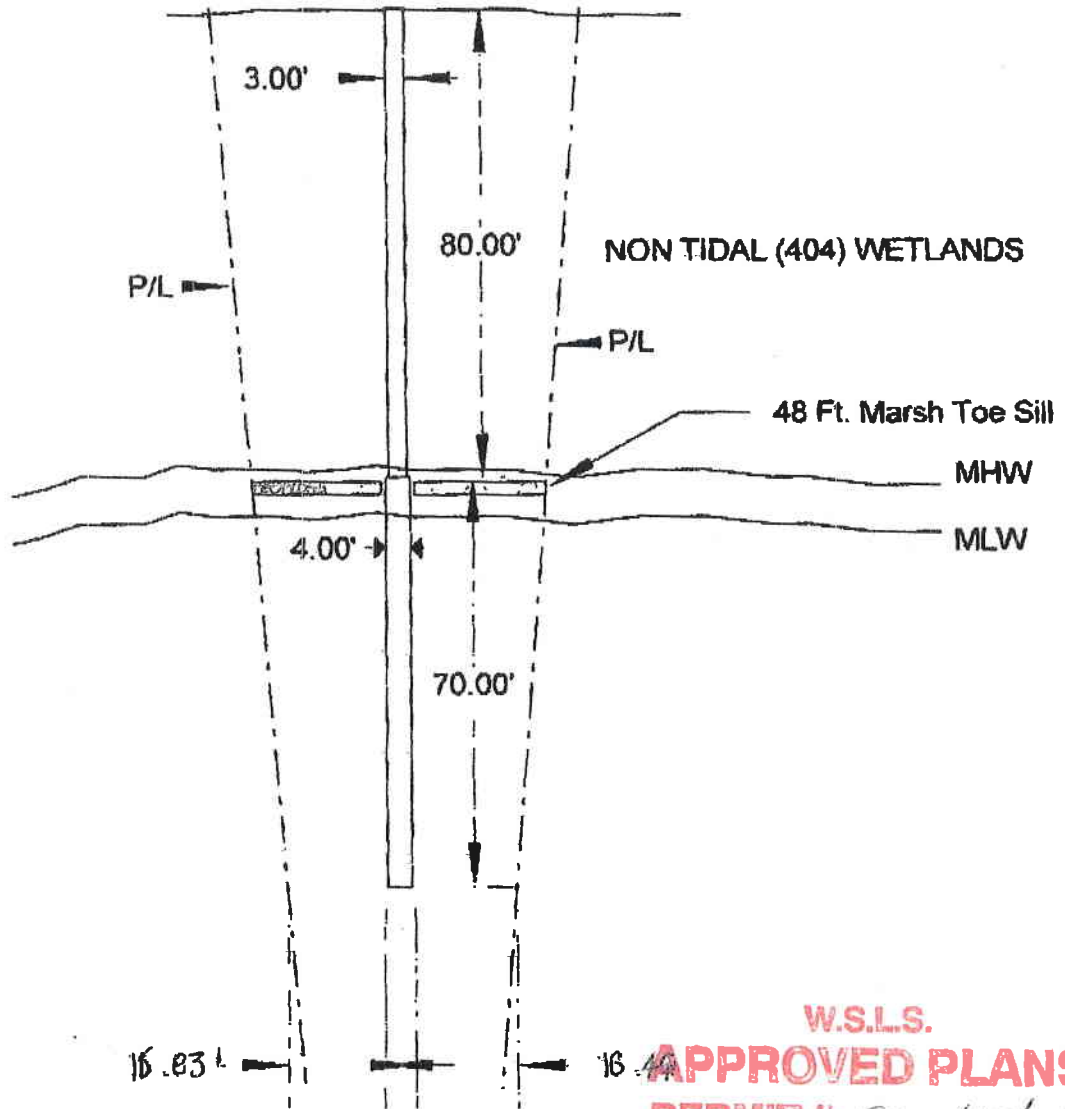

W.S.L.S.  
**APPROVED PLANS**  
 PERMIT # SL-144/07SM  
 DATE 6/5/07  
 (SEE PERMIT CONDITIONS)

HERRING CREEK  
EBB~FLOW

# EXHIBIT 2

Proposed Walkway & Pier  
 Harold Dukes, Jr.  
 At: Lot 48 Villages at Herring Creek  
 In: Herring Creek  
 TM 2-34-18.00-

VISION MARINE CONSTRUCTION INC.

2 Woodbridge Hills  
 Rehoboth Beach, DE. 19971

Scale: 1" = 30' Date: 05-30-07 Number: 53007-1

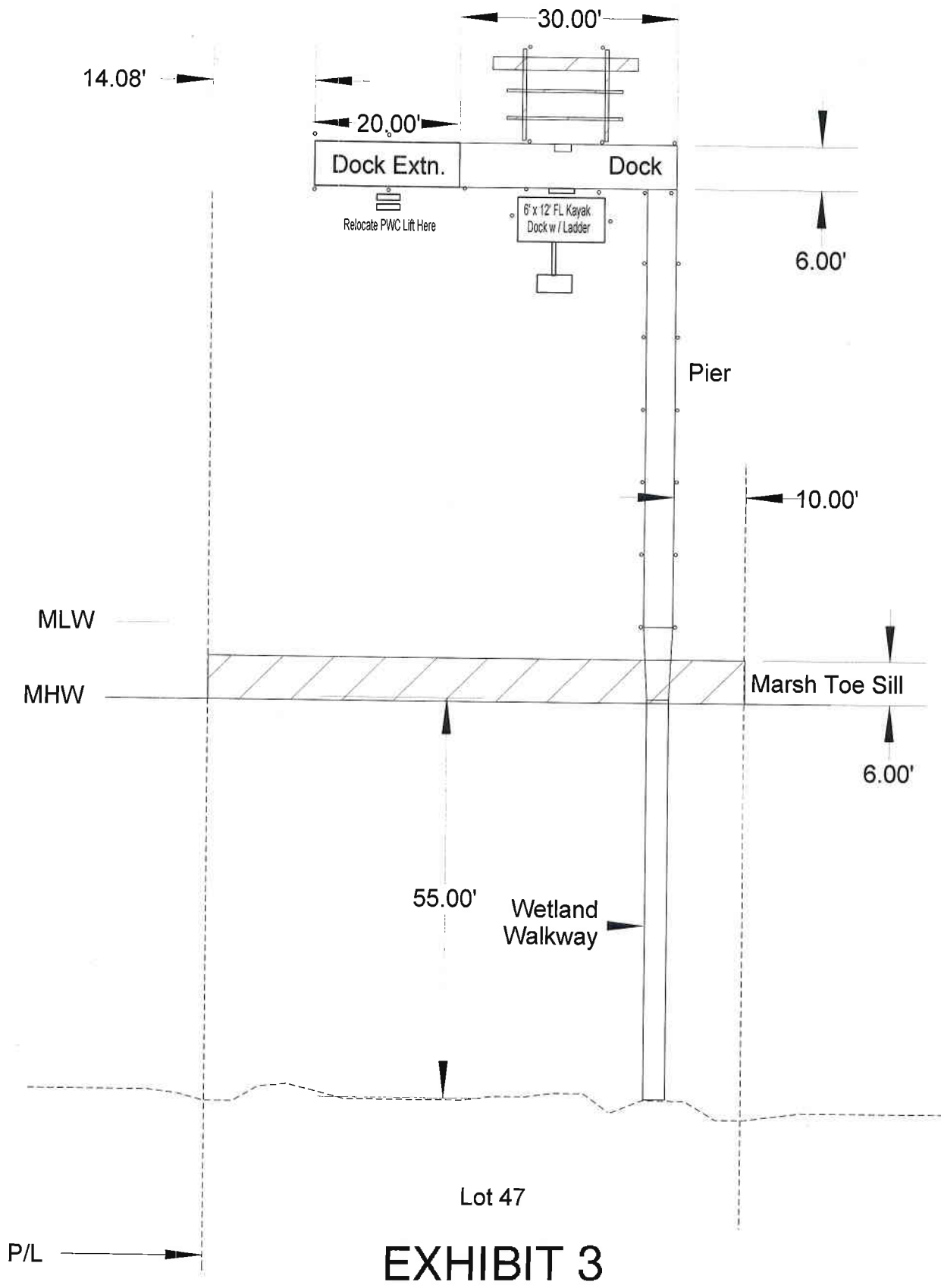

Proposed Dock Extension  
 Applicant: Carlo Businelli  
 Location: 23962 Sundance Lane  
 Lewes, DE 19958

PRECISION MARINE CONSTRUCTION INC.  
 Marine Contractors

202 Woodbridge Hills  
 Rehoboth Beach, DE 19971  
 DWRN Rob Whitford  
 Scale: 1" = 2 0' Date: 6-18-21