

Piney Neck Regional Wastewater Facility

Hans Medlarz email attachment showing chlorine contact chamber.



Chlorine contact chamber

Verification with Sussex County Planning and Zoning that there are no permits.



Parcel 233-6-00-123.00

2 messages

To: Ann Lepore <ann.lepore@sussexcountynj.de.gov>

Thu, May 6, 2021 at 9:16 AM

Ann,

Please verify if there are any permits for parcel 233-6-00-123.00. I cannot locate any on the county property search website.

Thank you,

Ann Lepore <ann.lepore@sussexcountynj.de.gov>
To: [Redacted]

Thu, May 6, 2021 at 9:21 AM

There are no permits for that parcel.

From: [Redacted]
Sent: Thursday, May 6, 2021 9:18 AM
To: Ann Lepore <ann.lepore@sussexcountynj.de.gov>
Subject: Parcel 233-6-00-123.00

CAUTION: This email originated from outside of the organization. Do not click links, open attachments, or reply unless you recognize the sender and know the content is safe. Contact the IT Helpdesk if you need assistance.

[Quoted text hidden]

Email with inspector Cody Letsinger informing him of the pit, requesting he take a photo, and recommending water be tested.



Piney Neck

3 messages

To: cody.letsinger@delaware.gov

Thu, May 13, 2021 at 4:26 PM

Cody,

The attached photo shows what appears to be an illegal borrow pit in the parcel adjacent to the Piney Neck wastewater facility with a path leading to it from the facility. You may want to have that water tested to see what's in it.

Thank you.

Don



Piney Neck.jpg
659K

Letsinger, Cody (DNREC) <Cody.Letsinger@delaware.gov>

Thu, May 13, 2021 at 4:38 PM

Thanks for the info/pictures Don! I'll review and forward this along.

-Cody

From: Nanya Bidness <nbidness@gmail.com>

Sent: Thursday, May 13, 2021 4:26 PM

To: Letsinger, Cody (DNREC) <Cody.Letsinger@delaware.gov>

Subject: Piney Neck

(Quoted text hidden)

To: "Letsinger, Cody (DNREC)" <Cody.Letsinger@delaware.gov>

Tue, May 18, 2021 at 8:10 AM

Thank you, Cody. I really appreciate you trying to help. The next time you inspect Piney Neck, please take a photograph of the path that leads into the woods toward that borrow pit. I would like to see what it looks like from the facility.

Don
(Quoted text hidden)

Piney Neck Regional Wastewater Facility
No permits on County website.



SUSSEX COUNTY
D I L A W A R L

Home Property Records Search

Profile
Sales
Owners
Land
Agriculture
Residential
Outbuildings
Values
Permits
Sketch
Map
Documents

PARID: 233-6.00-123.00
DAVIDSON NORMAN EDWARD JR &
BENITA

ROLL: RP

-- No Data --

Piney Neck Regional Wastewater Facility
Location of Parcel 233-6.00-123.00 on County website

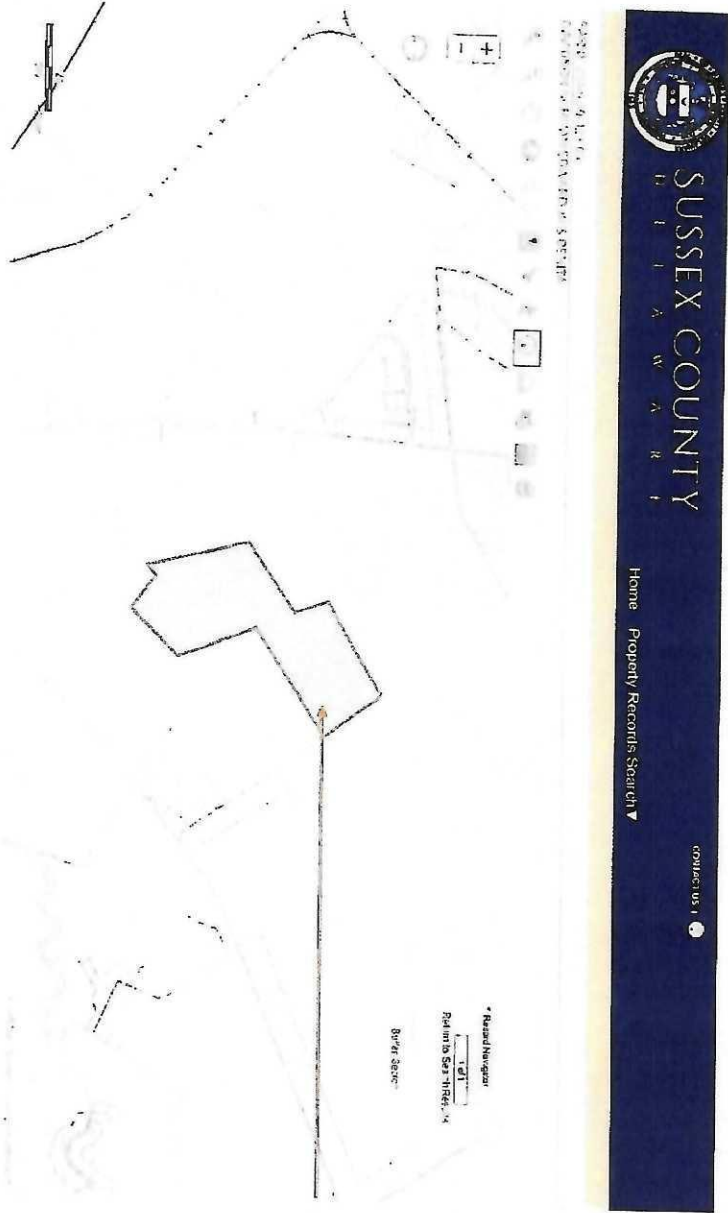

Approximate location of pit