

RECEIPT

DATE

10/09/25

No.

713676

RECEIVED FROM

CyberGrunch, Inc.

\$

1550.00

One thousand five hundred fifty and 00/100

DOLLARS

☐ FOR RENT☒ FOR

DE-SW-1752

ACCOUNT	
PAYMENT	
BAL. DUE	

☐ CASH☒ CHECK☐ MONEY ORDER☐ CREDIT CARD

FROM

2267

TO

BY

MM

3-11

CyberCrunch, Inc
1628 Roseytown Road, Unit 5
Greensburg, PA 15601

RECEIVED

OCT 09 2025

DNREC - WHS

Date: September 30th 2025

Delaware Department of Natural Resources and Environmental Control (DNREC)
Compliance and Permitting Section (CAPS)
89 Kings Highway
Dover, DE 19901

Re: Permit Renewal DE-SW-1752 — Submission with FOIA Redactions

Subject: Redacted Public Version Pursuant to 8 DE Admin. Code § 900

Dear DNREC-CAPS,

CyberCrunch, Inc. hereby submits its **Solid Waste Transporter Permit Renewal Application**. A check is enclosed for the applicable renewal fee. Consistent with DNREC's Important Notice, **two versions** are included:

1. **Unredacted** application and attachments for DNREC review.
2. **Public redacted** version prepared under **8 DE Admin. Code § 900** and **29 Del. C. Ch. 100**.

Confidentiality request. Under § 900 (including §§ 6.2.1–6.2.4), CyberCrunch respectfully requests confidential treatment for limited information that is not necessary for public understanding and whose disclosure would risk competitive or personal harm. Redactions are narrowly tailored to:

- **PII** (e.g., driver names, dates of birth, residential addresses), consistent with DNREC's stated redaction practice.
- **Confidential business information** and non-public corporate details whose release could create a competitive disadvantage.

All redactions are clearly marked in the public version. Non-exempt information remains available to support transparency during the 15-day public notice period and thereafter.

Please direct any FOIA or permitting correspondence to:

Serdar Bankaci
President, CyberCrunch, Inc.
1628 Roseytown Road Unit 5, Greensburg, PA 15601
(866) 925-2354 ext 1 [REDACTED]

If DNREC determines that any redacted material may be subject to disclosure, we respectfully request notice and an opportunity to further support our claim before release.

Thank you for your consideration.

Sincerely,

Serdar Bankaci
President, CyberCrunch, Inc.
1628 Roseytown Road Unit 5, Greensburg, PA 15601
(866) 925-2354 ext 1 | [REDACTED]

IMPORTANT NOTICE

The Delaware Department of Natural Resources and Environmental Control (DNREC) Compliance and Permitting Section (CAPS) is dedicated to overseeing the waste transportation permit process. We carefully receive, review, and provide comments regarding submitted permit applications, requiring a complete application prior to public notice. It is important for transporters submitting applications to DNREC-CAPS to understand that all permit applications will now be publicly accessible during the required 15-day public notice period and are also subject to release under DNREC's Freedom of Information Act (FOIA) afterward.

To improve transparency, DNREC now publishes legal notices on its website that include the names of transporters applying for permits, along with convenient links to the original permit applications. This approach is designed to promote open communication and build public trust.

Before releasing each permit application, DNREC-CAPS ensures that all personally identifiable information (PII)-such as driver names, birthdates, and Social Security numbers-is properly redacted.

Transporters who wish to keep other certain information in their permit applications confidential-excluding personally identifiable information (PII) which is being redacted-must explicitly request confidentiality when they submit their original application. This request must comply with DNREC's Freedom of Information Act (FOIA) regulations. For detailed policies and procedures regarding confidentiality requests, refer to 8 DE Admin. Code § 900, titled *Policies and Procedures Regarding FOIA Requests*.

Please note that any request to hold specific information as confidential must be made in writing at the time you submit your original waste transporter application to DNREC-CAPS. Your request must include a justification for why the information should be kept confidential, as required by Subsections 6.2.1 through 6.2.4 of the *Policies and Procedures Regarding FOIA Requests*.

Additionally, if you are making a confidentiality claim, you are required to submit two applications: the original waste transporter permit application and a second version of the original application that redacts the information you wish to keep confidential.

We appreciate your cooperation in this matter.



SOLID WASTE TRANSPORTER PERMIT APPLICATION

Language Preference:

Instructions: You must complete this application in its entirety and attach all applicable documentation. (Note: For applicants renewing an existing permit, this application requires the submission of updated information and documentation. References to material submitted under previous applications are no longer accepted.)

The application must be signed by the company owner or a corporate officer. A check or money order payable to the "State of Delaware" must accompany this application and be sent to:

Delaware Department of Natural Resources and Environmental Control
Compliance and Permitting Section
89 Kings Highway
Dover, DE 19901

1. Type of Permit

- ☐ New - **SCRAP TIRES ONLY** Submit a check or money order, payable to the "State of Delaware," in the amount of \$75.00.
- ☐ New - **ALL OTHERS** Submit a check or money order, payable to the "State of Delaware" in the amount of \$350.00.
- ☒ Renewal: Permit # DE-SW- 1752_____ Expiration Date 12/31/2025_____

Please indicate the term for which you desire your permit to be issued. Submit a check or money order, payable to the "State of Delaware," for the indicated permit fee.

SCRAP TIRES ONLY

- ☐ One Year - \$75.00
- ☐ Two Years - \$125.00
- ☐ Three Years - \$175.00
- ☐ Four Years - \$225.00
- ☐ Five Years - \$275.00

ALL OTHERS

- ☐ One Year - \$350.00
- ☐ Two Years - \$650.00
- ☐ Three Years - \$950.00
- ☐ Four Years - \$1250.00
- ☒ Five Years - \$1550.00

2. Release to Public

Do you wish to be included on the list of transporters that is provided to persons requesting a list of Delaware permitted solid waste transporters? ☐ Yes ☒ No

3. Company Information

Company Name CyberCrunch, Inc. _____

Location Address:	Mailing Address:
1628 Roseytown Road Unit 5, Greensburg PA 15601	1628 Roseytown Road Unit 5, Greensburg PA 15601
950 TOWNSHIP LINE ROAD, SUITE 103 UPPER CHICHESTER TWP, PA 19013	1628 Roseytown Road Unit 5, Greensburg PA 15601

Contact: Serdar Bankaci _____ Title: President _____

Business Phone: 866-925-2354 _____ Fax: _____

E-mail: info@ccrcyber.com _____

24 hr Emergency Contact Phone: 866-925-2354 x1 _____

4. Company Ownership Information

(a). Please indicate the company type:

☐ Proprietorship

☐ Partnership

☒ Corporation - If company is a corporation, indicate city, state, and date of incorporation.

City: Wilmington _____ State: DE _____ Date: 12/29/2024 _____

☐ Municipality

☐ Public institution

☐ Limited Liability Corporation (LLC) State: _____

☐ Other: (must specify) _____

(b). For each Owner, Partner, or Corporate Officer, attach a list with name, title, mailing address, date of birth, and % ownership. Include all stockholders owning greater than 5% outstanding shares.

☒ Attachment _____

(c). If company is owned by or affiliated with a parent company, attach parent company name, address & mailing address, and % ownership.

☐ Attachment _____

☒ No parent company

5. Company locations in Delaware

List name and *street* address of each company location, including freight terminals, within the State of Delaware.

- ☐ Attachment _____
X No Delaware locations

6. Company Affiliates

List name, location and mailing addresses, nature of business relationship of all company Affiliates, which affiliates are engaged in the business of waste transport, treatment, storage, disposal, recovery or reclamation. (Affiliated companies are defined as those companies owned by the same owners, corporate officers, or parent company.)

- ☐ Attachment _____
X No affiliates

7. Type of Waste to be Transported

(a). Check all that apply. Refer to Delaware's *Regulations Governing Solid Waste* for definitions of waste categories.

- ☐ Residential waste
X Commercial waste (from **non-manufacturing, non-processing** businesses and offices)
☐ Industrial waste (from a manufacturing or industrial process)
☐ Dry waste: ☐ construction/demolition debris
☐ trees/stumps
☐ other (must specify) _____
☐ Ash: ☐ municipal incinerator
☐ coal ash
☐ other (must specify) _____
☐ Infectious waste
☐ Non-hazardous petroleum-hydrocarbon contaminated soils
☐ Asbestos-containing waste
☐ Scrap Tires

(b). Does your company collect and transport residential (household) waste from single family homes, condominiums and apartment complexes in Delaware? ☐ Yes X No

(c). If you answered "YES" to question 7.b., above, does your company provide recycling services to those customers? ☐ Yes ☐ No ☐ N/A

(d). If you offer recycling services, does your company collect and transport the recyclables separately from the waste generated by your customers? ☐ Yes X No

(e). If you offer recycling services, are the recyclables ultimately taken to an incinerator (waste-to- energy) or landfill? ☐ Yes X No

8. Treatment, Storage, and Disposal Facilities

- (a). Do you cross state lines with the waste? ☒ Yes ☐ No
- (b). Identify in an attachment **all** solid waste Treatment, Storage, Disposal Facilities, Reclamation Facilities and Transfer Stations to which the waste will be transported.
- ☐ Delaware Solid Waste Authority locations: (attachment) _____
 - ☐ Clean Earth of New Castle, Inc. (thermal treatment facility for PHC-soils)
 - ☐ Delaware Recyclable Products, Inc. (dry waste, commercial, industrial, and PHC-soils)
 - ☐ Other in-state solid waste facilities, including private facilities: (attachment) _____
 - ☒ Out of state solid waste TSD facilities: (attachment) CyberCrunch Inc, 1628 Roseytown Road Unit 5, Greensburg PA 15601

9. Other Transporter Permits

- (a). Attach a copy of your home state solid waste transporter permit. (N/A if Delaware is your home state.)
- ☒ Attachment _____
- ☐ Not applicable-No transporter permit required for these solid waste types in our home state.
- (b). List solid waste transporter permits held in other states.
- ☐ Attachment _____
- ☒ No transporter permits in other states
- (c). Indicate your Federal DOT number and Motor Carrier number:
- DOT# 4322627 _____ MC# MC-1686608
- ☐ N/A If N/A, please provide an explanation, on the following page, as to why you are not required to have a DOT or MC number.

10. Proof of Financial Responsibility

The transporter must submit proof of financial responsibility as established in section 7.2.4 of Delaware's *Regulations Governing Solid Waste*. This proof may be established by a Certificate of Insurance, with MCS-90 endorsement where applicable, or by other means approved by the Department. (The Certificate of Insurance must identify the **Department of Natural Resources and Environmental Control, Compliance and Permitting Section** as the certificate holder.)

- (a). Are you for-hire in interstate commerce? ☐ Yes ☒ No (For-Hire means you are in the business of transporting, for compensation or payment, wastes generated by a company other than your own.)
- (b). Do you transport in the State of Delaware Only (Intrastate)? ☐ Yes ☒ No
- (c). Do you transport Interstate? ☒ Yes ☐ No

- (d). Certificate of Insurance must be attached and include minimum automobile liability coverage as follows:

	FOR-HIRE INTERSTATE	ALL OTHERS
Residential Waste	\$750,000.00 + MCS-90 <input type="checkbox"/>	\$350,000.00 <input type="checkbox"/>
Commercial Waste	\$750,000.00 + MCS-90 <input type="checkbox"/>	\$350,000.00 <input checked="" type="checkbox"/>
Industrial Waste	\$750,000.00 + MCS-90 <input type="checkbox"/>	\$350,000.00 <input type="checkbox"/>
Dry Waste	\$750,000.00 + MCS-90 <input type="checkbox"/>	\$350,000.00 <input type="checkbox"/>
Ash	\$750,000.00 + MCS-90 <input type="checkbox"/>	\$350,000.00 <input type="checkbox"/>
Infectious Waste	\$1,000,000.00 + MCS-90 <input type="checkbox"/>	\$750,000.00 + MCS-90 <input type="checkbox"/>
Non-Hazardous Petroleum	\$750,000.00 + MCS-90 <input type="checkbox"/>	\$350,000.00 <input type="checkbox"/>
Contaminated Soils	\$1,000,000.00 + MCS-90 <input type="checkbox"/>	\$350,000.00 <input type="checkbox"/>
Asbestos	(For Hire & Private)	\$350,000.00 <input type="checkbox"/>
Scrap Tires Only	\$350,000.00 <input type="checkbox"/>	\$350,000.00 <input type="checkbox"/>

11. Spill Control and Safety

List all spill control and safety equipment that will be carried on each vehicle. (**Note:** Separate lists by type of vehicle and type of waste may be required.) Attach a copy of the Spill Control Plan. The Spill Control Plan **must** contain the following elements: (1) List of safety and spill control equipment carried in the vehicle, (2) Driver preventive measures, (3) Driver immediate corrective actions, (4) Company internal communications, (5) Company external communications including the **Delaware Emergency Reporting Numbers: 1-800-662-8802 and 302-739-9401**, and (6) Cleanup and decontamination measures.

Spill Control Plan: Attachment X_____

12. Driver Training

IN SUMMARY OR OUTLINE FORM, describe the procedures that your company takes to ensure that all company drivers are safe and competent drivers. Small owner-operators may describe their years of experience and driving record in lieu of a formal program.

- Include requirements for special licenses (e.g. CDL, including any special endorsements), any special training received, including dates training was received (e.g. asbestos training), and any ongoing company programs. (e.g. weekly safety meetings or annual refresher courses);
- Include your company procedure for periodic checks of the driver's records for moving violations, and your company policy on progressive counseling/discipline based on points;
- Describe how drivers are instructed in the following:
 - Knowledge of proper handling procedures for the type of solid waste being transported.
 - Familiarity with the approved accidental discharge containment plan. (Spill Control Plan)
 - Familiarity with the conditions of the solid waste transporter's permit.

Driver Training, attachment X_____

13. Vehicle Identification

On the form provided with this application, list **MAKE, MODEL, YEAR, SERIAL NUMBER, LICENSE PLATE NUMBER, STATE OF REGISTRATION, MANUFACTURER'S GVWR** and **OWNERSHIP** of all vehicles used for the transportation of solid waste. You must list both motorized and container units. (If you maintain a list of company vehicles in a computer database you may submit a print out of the vehicles provided it contains the information requested herein.)

NOTE: You must notify CAPS in writing of any changes to information contained within this application, such as additions or deletions of vehicles, in accordance with conditions of the issued permit.

X Vehicle List Attached

14. Vehicle Operator Information

Is a list of all vehicle operators attached?

X Yes One driver - [REDACTED]

What tax form do you submit to the IRS for your vehicle operators?

X Form W-2

☐ Form 1099-Misc

☐ Other

15. Environmental Record

List all criminal citations, arrests, convictions, civil or administrative violations, and civil or administrative enforcement actions, and the disposition(s) thereof for the violation or alleged violation of any environmental statute, regulation, permit, license, approval, or order, regardless of the state in which it occurred. Indicate whether it was a local, state, or federal violation or alleged violation. List all such items for the applicant, and if the applicant is other than an individual, for any employee while employed by the applicant, or any partner, officer, or director of the applicant as an individual or for any former business of such partner, officer, or director. For civil or administrative violations or alleged violations, list all such items for the last five (5) years from the date of the application. Information submitted under this section is subject to verification. **Failure to submit complete and accurate information may lead to permit denial or revocation.**

☐ Attachment _____

X No violations within the specified time period

16. Certification

I certify under penalty of law that I have personally examined and am familiar with the information submitted in this application and all attachments and that, upon personal knowledge and information, the information is true, accurate, and complete. I am aware that there are significant penalties for submitting false information.

**Signature  Date 10/8/2025

Print Name Serdar Bankaci Title President

****A legal owner or corporate officer must sign the application****

Use this form, or other format which provides the same information, to answer the VEHICLE IDENTIFICATION requirement of the application. List all vehicles, both motorized and container (if a license plate is required on the container) to be used to haul solid waste in the state of Delaware. In addition, list the vehicle owner, owner's address, and domicile address if different from the company address provided in the application.

[illegible]

CyberCrunch Spill Control Plan for Solid Waste Haulers
(1) *Spill Control and Safety Equipment Carried in Each Vehicle*

Each CyberCrunch vehicle shall carry the following safety and spill response equipment:

1. Reflectors and/or flares
2. Spill cleanup kit (broom, dustpan, sealed container, gloves)
3. Fire extinguisher
4. First aid kit
5. Heavy-duty gloves and hard hat
6. Flashlight

(2) *Load Containment*

All loads will be **enclosed, covered, or tarped** to prevent accidental discharge of waste during transport to the disposal facility.

(3) *Pre-Trip Inspections*

Before transport, the driver will perform the following inspections:

1. Complete vehicle inspection, including a full walk-around
2. Inspection of the load to ensure it is fully contained, secured, and strapped

(4) *Emergency or Spill Response*

If an accident or emergency occurs resulting in a partial or full load spill, and the driver is uninjured, the driver shall immediately contact the designated company coordinator:

Name: Serdar Bankaci

Phone: [REDACTED]

(5) *Notification Procedures*

The designated coordinator will contact the **state and municipal authorities** where the accident occurred.

If the spill or accident has the potential to cause **environmental damage** (due to the nature of the waste, the location, or other contributing factors such as leaking oil, gasoline, or hydraulic fluid), the coordinator must notify the appropriate **state emergency response team** by calling one of the following numbers:

- **Delaware:**
 - 911
 - (302) 739-9401
 - 1-800-662-8802

(Other emergency contact numbers may be listed as applicable; however, the Delaware numbers above must be included in the Spill Control Plan.)

(6) Plan Availability

This **Spill Control and Safety Plan** will be carried in all vehicles, along with the **solid waste transportation permit**.

CyberCrunch exclusively operates **box trucks under 26,000 GVWR**.

Each driver must possess:

- A **valid Class C driver's license**
- A **valid medical card**

All drivers receive **material handling** and **hazard mitigation** training, as well as **quarterly safety training**.

- **Last Material Handling Training Conducted:** 03/19/2025
- **Last Hazard Mitigation Training Conducted:** 03/19/2025

(b) Driving Record and Qualification Standards

CyberCrunch conducts **driving record checks** both **upon hire** and **annually**.

- **Disqualification Criteria:**
 - Drivers with **more than two (2) major traffic violations** within a **three-year period** will be **disqualified from driving**.
 - Drivers with **DWI/DUI violations** will be **disqualified for a minimum of five (5) years**.

(c) Driver Instruction and Training Content

Drivers are instructed on the following topics as part of their training and onboarding process:

1. **Material Handling and Waste Transport**
 - Hands-on training for handling **electronic waste** and other solid waste materials transported by CyberCrunch.
 - Topics include:
 - Identification of hazards
 - Proper packaging and labeling
 - Emergency response procedures
 - **Specific modules:**
 - i. CRT monitor cleanup and handling
 - ii. Data security
 - iii. Battery packaging and cleanup
2. **Spill Control Plan**
 - Written and verbal instruction reviewing the **CyberCrunch Spill Control Plan** (see Section 11).
3. **Solid Waste Transporter's Permit**
 - Written and verbal training on the **Solid Waste Transporter's Permit** and related compliance obligations.

Ownership Information (Confidential)

Owner Name	Title	Mailing Address	Date of Birth	Ownership Percentage
Serdar Bankaci	President	[REDACTED]	[REDACTED]	[REDACTED]
Joseph Connors	CEO	[REDACTED]	[REDACTED]	[REDACTED]

There are no individual owners with 5% or more holdings.

10/10/2025

CYBERCRUNCH INC
1628 ROSEYTOWN ROAD
UNIT 5
GREENSBURG, PA 15601-7584
(724) 244-7071

NON-NEGOTIABLE

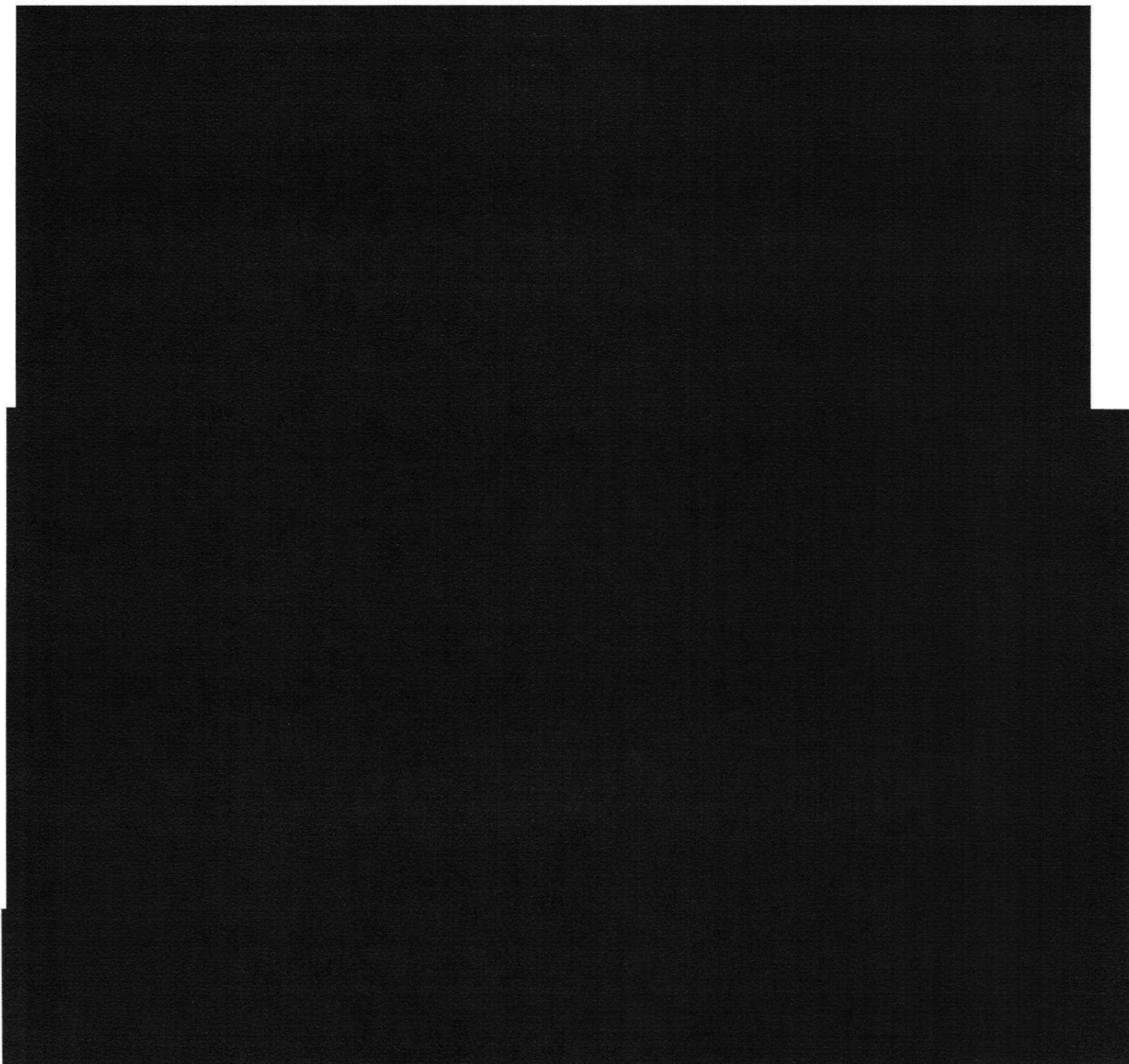

CyberCrunch, Inc
1628 Roseytown Road, Unit 5
Greensburg, PA 15601

RECEIVED

OCT 09 2025

DNREC - WHS

Date: September 30th 2025

Delaware Department of Natural Resources and Environmental Control (DNREC)
Compliance and Permitting Section (CAPS)
89 Kings Highway
Dover, DE 19901

Re: Permit Renewal DE-SW-1752 — Submission with FOIA Redactions

Subject: Redacted Public Version Pursuant to 8 DE Admin. Code § 900

Dear DNREC-CAPS,

CyberCrunch, Inc. hereby submits its **Solid Waste Transporter Permit Renewal Application**. A check is enclosed for the applicable renewal fee. Consistent with DNREC's Important Notice, **two versions** are included:

1. **Unredacted** application and attachments for DNREC review.
2. **Public redacted** version prepared under **8 DE Admin. Code § 900** and **29 Del. C. Ch. 100**.

Confidentiality request. Under § 900 (including §§ 6.2.1–6.2.4), CyberCrunch respectfully requests confidential treatment for limited information that is not necessary for public understanding and whose disclosure would risk competitive or personal harm. Redactions are narrowly tailored to:

- **PII** (e.g., driver names, dates of birth, residential addresses), consistent with DNREC's stated redaction practice.
- **Confidential business information** and non-public corporate details whose release could create a competitive disadvantage.

All redactions are clearly marked in the public version. Non-exempt information remains available to support transparency during the 15-day public notice period and thereafter.

Please direct any FOIA or permitting correspondence to:

Serdar Bankaci
President, CyberCrunch, Inc.
1628 Roseytown Road Unit 5, Greensburg, PA 15601
(866) 925-2354 ext 1 [REDACTED]

If DNREC determines that any redacted material may be subject to disclosure, we respectfully request notice and an opportunity to further support our claim before release.

Thank you for your consideration.

Sincerely,

Serdar Bankaci
President, CyberCrunch, Inc.
1628 Roseytown Road Unit 5, Greensburg, PA 15601
(866) 925-2354 ext 1 | [REDACTED]

IMPORTANT NOTICE

The Delaware Department of Natural Resources and Environmental Control (DNREC) Compliance and Permitting Section (CAPS) is dedicated to overseeing the waste transportation permit process. We carefully receive, review, and provide comments regarding submitted permit applications, requiring a complete application prior to public notice. It is important for transporters submitting applications to DNREC-CAPS to understand that all permit applications will now be publicly accessible during the required 15-day public notice period and are also subject to release under DNREC's Freedom of Information Act (FOIA) afterward.

To improve transparency, DNREC now publishes legal notices on its website that include the names of transporters applying for permits, along with convenient links to the original permit applications. This approach is designed to promote open communication and build public trust.

Before releasing each permit application, DNREC-CAPS ensures that all personally identifiable information (PII)-such as driver names, birthdates, and Social Security numbers-is properly redacted.

Transporters who wish to keep other certain information in their permit applications confidential-excluding personally identifiable information (PII) which is being redacted-must explicitly request confidentiality when they submit their original application. This request must comply with DNREC's Freedom of Information Act (FOIA) regulations. For detailed policies and procedures regarding confidentiality requests, refer to 8 DE Admin. Code § 900, titled *Policies and Procedures Regarding FOIA Requests*.

Please note that any request to hold specific information as confidential must be made in writing at the time you submit your original waste transporter application to DNREC-CAPS. Your request must include a justification for why the information should be kept confidential, as required by Subsections 6.2.1 through 6.2.4 of the *Policies and Procedures Regarding FOIA Requests*.

Additionally, if you are making a confidentiality claim, you are required to submit two applications: the original waste transporter permit application and a second version of the original application that redacts the information you wish to keep confidential.

We appreciate your cooperation in this matter.



SOLID WASTE TRANSPORTER PERMIT APPLICATION

Language Preference:

Instructions: You must complete this application in its entirety and attach all applicable documentation. (**Note:** For applicants renewing an existing permit, this application requires the submission of updated information and documentation. References to material submitted under previous applications are no longer accepted.)

The application must be signed by the company owner or a corporate officer. A check or money order payable to the **"State of Delaware"** must accompany this application and be sent to:

Delaware Department of Natural Resources and Environmental Control
Compliance and Permitting Section
89 Kings Highway
Dover, DE 19901

1. Type of Permit

- ☐ New – **SCRAP TIRES ONLY** Submit a check or money order, payable to the "State of Delaware," in the amount of \$75.00.
- ☐ New – **ALL OTHERS** Submit a check or money order, payable to the "State of Delaware" in the amount of \$350.00.
- ☒ Renewal: Permit # DE-SW- 1752_____ Expiration Date 12/31/2025_____

Please indicate the term for which you desire your permit to be issued. Submit a check or money order, payable to the "State of Delaware," for the indicated permit fee.

SCRAP TIRES ONLY

- ☐ One Year - \$75.00
- ☐ Two Years - \$125.00
- ☐ Three Years - \$175.00
- ☐ Four Years - \$225.00
- ☐ Five Years - \$275.00

ALL OTHERS

- ☐ One Year - \$350.00
- ☐ Two Years - \$650.00
- ☐ Three Years - \$950.00
- ☐ Four Years - \$1250.00
- ☒ Five Years - \$1550.00

2. Release to Public

Do you wish to be included on the list of transporters that is provided to persons requesting a list of Delaware permitted solid waste transporters? ☐ Yes ☒ No

3. Company Information

Company Name CyberCrunch, Inc _____

Location Address:	Mailing Address:
1628 Roseytown Road Unit 5, Greensburg PA 15601	1628 Roseytown Road Unit 5, Greensburg PA 15601
950 TOWNSHIP LINE ROAD, SUITE 103 UPPER CHICHESTER TWP, PA 19013	1628 Roseytown Road Unit 5, Greensburg PA 15601

Contact: Serdar Bankaci _____ Title: President _____

Business Phone: 866-925-2354 _____ Fax: _____

E-mail: info@ccrcyber.com _____

24 hr Emergency Contact Phone: 866-925-2354 x1 _____

4. Company Ownership Information

(a). Please indicate the company type:

☐ Proprietorship

☐ Partnership

☒ Corporation - If company is a corporation, indicate city, state, and date of incorporation.

City: Wilmington _____ State: DE _____ Date: 12/29/2024 _____

☐ Municipality

☐ Public institution

☐ Limited Liability Corporation (LLC) State: _____

☐ Other: (must specify) _____

(b). For each Owner, Partner, or Corporate Officer, attach a list with name, title, mailing address, date of birth, and % ownership. Include all stockholders owning greater than 5% outstanding shares.

☒ Attachment _____

(c). If company is owned by or affiliated with a parent company, attach parent company name, address & mailing address, and % ownership.

☐ Attachment _____

☒ No parent company

5. Company locations in Delaware

List name and *street* address of each company location, including freight terminals, within the State of Delaware.

- ☐ Attachment _____
☒ No Delaware locations

6. Company Affiliates

List name, location and mailing addresses, nature of business relationship of all company Affiliates, which affiliates are engaged in the business of waste transport, treatment, storage, disposal, recovery or reclamation. (Affiliated companies are defined as those companies owned by the same owners, corporate officers, or parent company.)

- ☐ Attachment _____
☒ No affiliates

7. Type of Waste to be Transported

(a). Check all that apply. Refer to Delaware's *Regulations Governing Solid Waste* for definitions of waste categories.

- ☐ Residential waste
☒ Commercial waste (from **non-manufacturing, non-processing** businesses and offices)
☐ Industrial waste (from a manufacturing or industrial process)
☐ Dry waste: ☐ construction/demolition debris
☐ trees/stumps
☐ other (must specify) _____
☐ Ash: ☐ municipal incinerator
☐ coal ash
☐ other (must specify) _____
☐ Infectious waste
☐ Non-hazardous petroleum-hydrocarbon contaminated soils
☐ Asbestos-containing waste
☐ Scrap Tires

(b). Does your company collect and transport residential (household) waste from single family homes, condominiums and apartment complexes in Delaware? ☐ Yes ☒ No

(c). If you answered "YES" to question 7.b., above, does your company provide recycling services to those customers? ☐ Yes ☐ No ☐ N/A

(d). If you offer recycling services, does your company collect and transport the recyclables separately from the waste generated by your customers? ☐ Yes ☒ No

(e). If you offer recycling services, are the recyclables ultimately taken to an incinerator (waste-to- energy) or landfill? ☐ Yes ☒ No

8. Treatment, Storage, and Disposal Facilities

- (a). Do you cross state lines with the waste? ☒ Yes ☐ No
- (b). Identify in an attachment **all** solid waste Treatment, Storage, Disposal Facilities, Reclamation Facilities and Transfer Stations to which the waste will be transported.
- ☐ Delaware Solid Waste Authority locations: (attachment) _____
 - ☐ Clean Earth of New Castle, Inc. (thermal treatment facility for PHC-soils)
 - ☐ Delaware Recyclable Products, Inc. (dry waste, commercial, industrial, and PHC-soils)
 - ☐ Other in-state solid waste facilities, including private facilities: (attachment) _____
 - ☒ Out of state solid waste TSD facilities: (attachment) CyberCrunch Inc, 1628 Roseytown Road Unit 5, Greensburg PA 15601

9. Other Transporter Permits

- (a). Attach a copy of your home state solid waste transporter permit. (N/A if Delaware is your home state.)
- ☒ Attachment _____
- ☐ Not applicable-No transporter permit required for these solid waste types in our home state.
- (b). List solid waste transporter permits held in other states.
- ☐ Attachment _____
- ☒ No transporter permits in other states
- (c). Indicate your Federal DOT number and Motor Carrier number:
- DOT# 4322627 _____ MC# MC-1686608
- ☐ N/A If N/A, please provide an explanation, on the following page, as to why you are not required to have a DOT or MC number.

10. Proof of Financial Responsibility

The transporter must submit proof of financial responsibility as established in section 7.2.4 of Delaware's *Regulations Governing Solid Waste*. This proof may be established by a Certificate of Insurance, with MCS-90 endorsement where applicable, or by other means approved by the Department. (The Certificate of Insurance must identify the **Department of Natural Resources and Environmental Control, Compliance and Permitting Section** as the certificate holder.)

- (a). Are you for-hire in interstate commerce? ☐ Yes ☒ No (For-Hire means you are in the business of transporting, for compensation or payment, wastes generated by a company other than your own.)
- (b). Do you transport in the State of Delaware Only (Intrastate)? ☐ Yes ☒ No
- (c). Do you transport Interstate? ☒ Yes ☐ No

- (d). Certificate of Insurance must be attached and include minimum automobile liability coverage as follows:

	FOR-HIRE INTERSTATE	ALL OTHERS
Residential Waste	\$750,000.00 + MCS-90 <input type="checkbox"/>	\$350,000.00 <input type="checkbox"/>
Commercial Waste	\$750,000.00 + MCS-90 <input type="checkbox"/>	\$350,000.00 <input checked="" type="checkbox"/>
Industrial Waste	\$750,000.00 + MCS-90 <input type="checkbox"/>	\$350,000.00 <input type="checkbox"/>
Dry Waste	\$750,000.00 + MCS-90 <input type="checkbox"/>	\$350,000.00 <input type="checkbox"/>
Ash	\$750,000.00 + MCS-90 <input type="checkbox"/>	\$350,000.00 <input type="checkbox"/>
Infectious Waste	\$1,000,000.00 + MCS-90 <input type="checkbox"/>	\$750,000.00 + MCS-90 <input type="checkbox"/>
Non-Hazardous Petroleum	\$750,000.00 + MCS-90 <input type="checkbox"/>	\$350,000.00 <input type="checkbox"/>
Contaminated Soils	\$1,000,000.00 + MCS-90 <input type="checkbox"/>	\$350,000.00 <input type="checkbox"/>
Asbestos	(For Hire & Private)	\$350,000.00 <input type="checkbox"/>
Scrap Tires Only	\$350,000.00 <input type="checkbox"/>	\$350,000.00 <input type="checkbox"/>

11. Spill Control and Safety

List all spill control and safety equipment that will be carried on each vehicle. (**Note:** Separate lists by type of vehicle and type of waste may be required.) Attach a copy of the Spill Control Plan. The Spill Control Plan **must** contain the following elements: (1) List of safety and spill control equipment carried in the vehicle, (2) Driver preventive measures, (3) Driver immediate corrective actions, (4) Company internal communications, (5) Company external communications including the **Delaware Emergency Reporting Numbers: 1-800-662-8802 and 302-739-9401**, and (6) Cleanup and decontamination measures.

Spill Control Plan: Attachment X_____

12. Driver Training

IN SUMMARY OR OUTLINE FORM, describe the procedures that your company takes to ensure that all company drivers are safe and competent drivers. Small owner-operators may describe their years of experience and driving record in lieu of a formal program.

- (a). Include requirements for special licenses (e.g. CDL, including any special endorsements), any special training received, including dates training was received (e.g. asbestos training), and any ongoing company programs. (e.g. weekly safety meetings or annual refresher courses);
- (b). Include your company procedure for periodic checks of the driver's records for moving violations, and your company policy on progressive counseling/discipline based on points;
- (c). Describe how drivers are instructed in the following:
 - (i) Knowledge of proper handling procedures for the type of solid waste being transported.
 - (ii) Familiarity with the approved accidental discharge containment plan. (Spill Control Plan)
 - (iii) Familiarity with the conditions of the solid waste transporter's permit.

Driver Training, attachment X_____

13. Vehicle Identification

On the form provided with this application, list **MAKE, MODEL, YEAR, SERIAL NUMBER, LICENSE PLATE NUMBER, STATE OF REGISTRATION, MANUFACTURER'S GVWR and OWNERSHIP** of all vehicles used for the transportation of solid waste. You must list both motorized and container units. (If you maintain a list of company vehicles in a computer database you may submit a print out of the vehicles provided it contains the information requested herein.)

NOTE: You must notify CAPS in writing of any changes to information contained within this application, such as additions or deletions of vehicles, in accordance with conditions of the issued permit.

X Vehicle List Attached

14. Vehicle Operator Information

Is a list of all vehicle operators attached? X Yes One driver - 

What tax form do you submit to the IRS for your vehicle operators?

X Form W-2

☐ Form 1099-Misc

☐ Other

15. Environmental Record

List all criminal citations, arrests, convictions, civil or administrative violations, and civil or administrative enforcement actions, and the disposition(s) thereof for the violation or alleged violation of any environmental statute, regulation, permit, license, approval, or order, regardless of the state in which it occurred. Indicate whether it was a local, state, or federal violation or alleged violation. List all such items for the applicant, and if the applicant is other than an individual, for any employee while employed by the applicant, or any partner, officer, or director of the applicant as an individual or for any former business of such partner, officer, or director. For civil or administrative violations or alleged violations, list all such items for the last five (5) years from the date of the application. Information submitted under this section is subject to verification. **Failure to submit complete and accurate information may lead to permit denial or revocation.**

☐ Attachment _____

X No violations within the specified time period

16. Certification

I certify under penalty of law that I have personally examined and am familiar with the information submitted in this application and all attachments and that, upon personal knowledge and information, the information is true, accurate, and complete. I am aware that there are significant penalties for submitting false information.

**Signature  Date 10/8/2025

Print Name Serdar Bankaci Title President

****A legal owner or corporate officer must sign the application****

Use this form, or other format which provides the same information, to answer the VEHICLE IDENTIFICATION requirement of the application. List all vehicles, both motorized and container (if a license plate is required on the container) to be used to haul solid waste in the state of Delaware. In addition, list the vehicle owner, owner's address, and domicile address if different from the company address provided in the application.

[illegible]

CyberCrunch Spill Control Plan for Solid Waste Haulers

(1) Spill Control and Safety Equipment Carried in Each Vehicle

Each CyberCrunch vehicle shall carry the following safety and spill response equipment:

1. Reflectors and/or flares
2. Spill cleanup kit (broom, dustpan, sealed container, gloves)
3. Fire extinguisher
4. First aid kit
5. Heavy-duty gloves and hard hat
6. Flashlight

(2) Load Containment

All loads will be **enclosed, covered, or tarped** to prevent accidental discharge of waste during transport to the disposal facility.

(3) Pre-Trip Inspections

Before transport, the driver will perform the following inspections:

1. Complete vehicle inspection, including a full walk-around
2. Inspection of the load to ensure it is fully contained, secured, and strapped

(4) Emergency or Spill Response

If an accident or emergency occurs resulting in a partial or full load spill, and the driver is uninjured, the driver shall immediately contact the designated company coordinator:

Name: Serdar Bankaci

Phone: [REDACTED]

(5) Notification Procedures

The designated coordinator will contact the **state and municipal authorities** where the accident occurred.

If the spill or accident has the potential to cause **environmental damage** (due to the nature of the waste, the location, or other contributing factors such as leaking oil, gasoline, or hydraulic fluid), the coordinator must notify the appropriate **state emergency response team** by calling one of the following numbers:

- **Delaware:**
 - 911
 - (302) 739-9401
 - 1-800-662-8802

(Other emergency contact numbers may be listed as applicable; however, the Delaware numbers above must be included in the Spill Control Plan.)

(6) Plan Availability

This **Spill Control and Safety Plan** will be carried in all vehicles, along with the **solid waste transportation permit**.

CyberCrunch exclusively operates **box trucks under 26,000 GVWR**.

Each driver must possess:

- A **valid Class C driver's license**
- A **valid medical card**

All drivers receive **material handling** and **hazard mitigation** training, as well as **quarterly safety training**.

- **Last Material Handling Training Conducted:** 03/19/2025
- **Last Hazard Mitigation Training Conducted:** 03/19/2025

(b) Driving Record and Qualification Standards

CyberCrunch conducts **driving record checks** both **upon hire** and **annually**.

- **Disqualification Criteria:**
 - Drivers with **more than two (2) major traffic violations** within a **three-year period** will be **disqualified from driving**.
 - Drivers with **DWI/DUI violations** will be **disqualified for a minimum of five (5) years**.

(c) Driver Instruction and Training Content

Drivers are instructed on the following topics as part of their training and onboarding process:

1. **Material Handling and Waste Transport**
 - Hands-on training for handling **electronic waste** and other solid waste materials transported by CyberCrunch.
 - Topics include:
 - Identification of hazards
 - Proper packaging and labeling
 - Emergency response procedures
 - **Specific modules:**
 - i. CRT monitor cleanup and handling
 - ii. Data security
 - iii. Battery packaging and cleanup
2. **Spill Control Plan**
 - Written and verbal instruction reviewing the **CyberCrunch Spill Control Plan** (see Section 11).
3. **Solid Waste Transporter's Permit**
 - Written and verbal training on the **Solid Waste Transporter's Permit** and related compliance obligations.

Ownership Information (Confidential)

Owner Name	Title	Mailing Address	Date of Birth	Ownership Percentage
Serdar Bankaci	President			
Joseph Connors	CEO			

There are no individual owners with 5% or more holdings.

CYBERCRUNCH INC
1628 ROSEYTOWN ROAD
UNIT 5
GREENSBURG, PA 15601-7584
(724) 244-7071



ACORDTM**CERTIFICATE OF LIABILITY INSURANCE**

DATE (MM/DD/YYYY)

10/08/2025

THIS CERTIFICATE IS ISSUED AS A MATTER OF INFORMATION ONLY AND CONFERS NO RIGHTS UPON THE CERTIFICATE HOLDER. THIS CERTIFICATE DOES NOT AFFIRMATIVELY OR NEGATIVELY AMEND, EXTEND OR ALTER THE COVERAGE AFFORDED BY THE POLICIES BELOW. THIS CERTIFICATE OF INSURANCE DOES NOT CONSTITUTE A CONTRACT BETWEEN THE ISSUING INSURER(S), AUTHORIZED REPRESENTATIVE OR PRODUCER, AND THE CERTIFICATE HOLDER.

IMPORTANT: If the certificate holder is an ADDITIONAL INSURED, the policy(ies) must have ADDITIONAL INSURED provisions or be endorsed. If SUBROGATION IS WAIVED, subject to the terms and conditions of the policy, certain policies may require an endorsement. A statement on this certificate does not confer any rights to the certificate holder in lieu of such endorsement(s).

PRODUCER AssuredPartners of PA, LLC 501 Marketplace Avenue Suite 200 Coraopolis, PA 15108	CONTACT NAME: Stephanie Kuhn		
	PHONE (A/C, No, Ext): -	FAX (A/C, No):	
	E-MAIL ADDRESS: stephanie.kuhn@assuredpartners.com		
INSURED CyberCrunch Inc; Commonwealth Computer Recycling, LLC 1628 Roseytown Road, Unit 5 Greensburg, PA 15601	INSURER(S) AFFORDING COVERAGE		NAIC #
	INSURER A : Atlantic Specialty Insurance Company		27154
	INSURER B : New Jersey Casualty Insurance Company		10732
	INSURER C : The Hanover Insurance Company		22292
	INSURER D : At-Bay Specialty Insurance Company		19607
	INSURER E : QBE Specialty Insurance Company		11515
	INSURER F : ACE American Insurance Company		22667

COVERAGES		CERTIFICATE NUMBER:		REVISION NUMBER:		
THIS IS TO CERTIFY THAT THE POLICIES OF INSURANCE LISTED BELOW HAVE BEEN ISSUED TO THE INSURED NAMED ABOVE FOR THE POLICY PERIOD INDICATED. NOTWITHSTANDING ANY REQUIREMENT, TERM OR CONDITION OF ANY CONTRACT OR OTHER DOCUMENT WITH RESPECT TO WHICH THIS CERTIFICATE MAY BE ISSUED OR MAY PERTAIN, THE INSURANCE AFFORDED BY THE POLICIES DESCRIBED HEREIN IS SUBJECT TO ALL THE TERMS, EXCLUSIONS AND CONDITIONS OF SUCH POLICIES. LIMITS SHOWN MAY HAVE BEEN REDUCED BY PAID CLAIMS.						
INSR LTR	TYPE OF INSURANCE	ADDL SUBR INSR WVD	POLICY NUMBER	POLICY EFF (MM/DD/YYYY)	POLICY EXP (MM/DD/YYYY)	LIMITS
A	<input checked="" type="checkbox"/> COMMERCIAL GENERAL LIABILITY <input type="checkbox"/> CLAIMS-MADE <input checked="" type="checkbox"/> OCCUR GEN'L AGGREGATE LIMIT APPLIES PER: <input type="checkbox"/> POLICY <input type="checkbox"/> PRO-JECT <input type="checkbox"/> LOC OTHER:		7110182700003	08/05/2025	08/05/2026	EACH OCCURRENCE \$1,000,000 DAMAGE TO RENTED PREMISES (Ea occurrence) \$1,000,000 MED EXP (Any one person) \$15,000 PERSONAL & ADV INJURY \$1,000,000 GENERAL AGGREGATE \$2,000,000 PRODUCTS - COMP/OP AGG \$2,000,000 \$
A	<input checked="" type="checkbox"/> AUTOMOBILE LIABILITY <input checked="" type="checkbox"/> ANY AUTO OWNED AUTOS ONLY <input checked="" type="checkbox"/> HIRED AUTOS ONLY <input type="checkbox"/> SCHEDULED AUTOS <input checked="" type="checkbox"/> NON-OWNED AUTOS ONLY		7110182700003	08/05/2025	08/05/2026	COMBINED SINGLE LIMIT (Ea accident) \$1,000,000 BODILY INJURY (Per person) \$ BODILY INJURY (Per accident) \$ PROPERTY DAMAGE (Per accident) \$ \$
A	<input checked="" type="checkbox"/> UMBRELLA LIAB <input checked="" type="checkbox"/> EXCESS LIAB <input type="checkbox"/> DED <input type="checkbox"/> RETENTION \$		7110182700003	08/05/2025	08/05/2026	EACH OCCURRENCE \$5,000,000 AGGREGATE \$5,000,000 \$
B	WORKERS COMPENSATION AND EMPLOYERS' LIABILITY ANY PROPRIETOR/PARTNER/EXECUTIVE OFFICER/MEMBER EXCLUDED? <input checked="" type="checkbox"/> Y <input checked="" type="checkbox"/> N (Mandatory in NH) If yes, describe under DESCRIPTION OF OPERATIONS below	N/A	104262225	01/01/2025	01/01/2026	<input checked="" type="checkbox"/> PER STATUTE <input type="checkbox"/> OTH-ER E.L. EACH ACCIDENT \$1,000,000 E.L. DISEASE - EA EMPLOYEE \$1,000,000 E.L. DISEASE - POLICY LIMIT \$1,000,000
C	Inland Marine MTC		IHYJ50738900	08/05/2025	08/05/2026	\$250k Any one Convey
D	TechE&O/Cyber		AB678744402	08/05/2025	08/05/2026	\$5M Agg./\$5M Each Claim
E	Excess Tech/Cyber		CELP00179701749630	08/05/2025	08/05/2026	\$5M Agg./\$5M Each Claim

DESCRIPTION OF OPERATIONS / LOCATIONS / VEHICLES (ACORD 101, Additional Remarks Schedule, may be attached if more space is required)

F: Pollution Liability: CPMG47482525001: Effective 8/5/2024 to 8/5/2026: \$2M Agg./\$1M Each Claim

In respects to the General Liability and Auto, Waiver of Subrogation applies in favor of Delaware Department of Natural Resources and any other party listed as an indemnitee in the contract are included as additional insureds, on a primary/non-contributory basis by a written contract or agreement. Additional (See Attached Descriptions)

CERTIFICATE HOLDER	CANCELLATION
Delaware Department of Natural Resources 89 Kings Highway Dover, DE 19901	SHOULD ANY OF THE ABOVE DESCRIBED POLICIES BE CANCELLED BEFORE THE EXPIRATION DATE THEREOF, NOTICE WILL BE DELIVERED IN ACCORDANCE WITH THE POLICY PROVISIONS.
	AUTHORIZED REPRESENTATIVE 

DESCRIPTIONS (Continued from Page 1)

Insured is written on a blanket endorsement and provides status when required by written contract. Umbrella follows General Liability, Auto and Employers Liability.

Davis, DaQuan (DNREC)

From: Serdar Bankaci [REDACTED]>
Sent: Wednesday, October 15, 2025 12:51 PM
To: WHStranporters
Subject: Re: Missing Info- DE SW Transporter Permit Application (DE-SW-1752)
Attachments: certificate-of-lease.pdf; Countersigned Lease Documents Cybercrunch Schedule A 25-01 Replacement Lease Unit 511148 (1).pdf

Please find the lease documents attached and a photo of our PA Waste Hauler Permit

12:50 M 59%

95



Edit



J R Truck



030521

On-Site Fueling



On Mon, Oct 13, 2025 at 8:43 AM WHStranporters <WHStranporters@delaware.gov> wrote:

Thank you.



DaQuan L. Davis

Environmental Scientist

Division of Waste and Hazardous Substances

302-739-9403

WHStranporters@delaware.gov

89 Kings Hwy SW, Dover, DE 19901

dnrec.delaware.gov



From: Serdar Bankaci <serdarb@ccrcyber.com>

Sent: Friday, October 10, 2025 3:45 PM

To: WHStranporters <WHStranporters@delaware.gov>

Subject: Re: Missing Info- DE SW Transporter Permit Application (DE-SW-1752)

Received. I will forward these to you on Tuesday.

On Fri, Oct 10, 2025, 2:00 PM WHStranporters <WHStranporters@delaware.gov> wrote:

Hello,

Thank you for submitting your application for your Delaware solid waste transporter permit. Upon review, I have found that some information is missing or needs to be updated. Please address the items listed below:

- **Section 9(a)**- Please provide a copy of the company's home state (PA) solid waste transporter permit.
- **Section 13**- The Penske vehicle lease was not included.

Please provide the information requested above via e-mail within five (5) days.

Thank you,

DaQuan Davis



DaQuan L. Davis

Environmental Scientist

Division of Waste and Hazardous Substances

 302-739-9403

 WHStranporters@delaware.gov

 [89 Kings Hwy SW, Dover, DE 19901](#)

 dnrec.delaware.gov



Confidentiality Notice: the information contained in this email and any attachments may be legally privileged and confidential. If you are not an intended recipient, you are hereby notified that any dissemination, distribution, or copying of this e-mail is strictly prohibited. If you have received this e-mail in error, please notify the sender and permanently delete the e-mail and any attachments immediately. You should not retain, copy or use this e-mail or any attachments for any purpose, nor disclose all or any part of the contents to any other person.

Confidentiality Notice: the information contained in this email and any attachments may be legally privileged and confidential. If you are not an intended recipient, you are hereby notified that any dissemination, distribution, or copying of this e-mail is strictly prohibited. If you have received this e-mail in error, please notify the sender and permanently delete the e-mail and any attachments immediately. You should not retain, copy or use this e-mail or any attachments for any purpose, nor disclose all or any part of the contents to any other person.



CERTIFICATION OF LEASE

This is to certify that the Vehicular Equipment described below has been leased by:

CYBERCRUNCH INC

a PA Corporation, whose Principal Place of Business is at:

1628 ROSEYTOWN RD UNIT 5

GREENSBURG PA 15801

(hereinafter called Lessee) from Penske Truck Leasing Co., L.P. - Penske Leasing and Rental Co., whose Principal Place of business is at 2675 Morgantown Road, Reading, PA 19607 (hereinafter called Lessor).

This Certificate of Lease, executed this 13 day of October, 2025 for the below listed vehicle will be operated pursuant to the terms of agreement as set forth in the Vehicle Lease Service Agreement.

This Certificate of Lease shall remain in full effect for the term of the lease pursuant to VLSA Schedule Number 25-01, having a term of 60 months.

Master copies of the Vehicle Lease Service Agreement, Schedules and Addendums thereto are on file in both the home office of the Lessee and the Lessor.

Vehicle No.	Year	Make	Serial Number	Registration
511148	2026	ISUZU TRUCK	54DE5W1D8TSR00130	IN 3813182

Penske Truck Leasing Co., L.P.
Penske Leasing and Rental Co.
2675 Morgantown Road
Reading, PA 19607

By: _____
(Lessee)

By: 
Jeffrey G Spiegel
Vice President-Fleet Services
and Operating Tax



VEHICLE LEASE SERVICE AGREEMENT

Schedule "A" Contract Details No. 25-01

Cybercrunch Incorporated

Unless otherwise expressly stated, all values are on a per vehicle basis.

2026 ISUZU

NRR EFI SAGT DRYVAN WABASH ALUMINUM 18x91x96 w/TUKAWAY

Schedule A 25-01

VEHICLES	Quantity	1	SERVICES	Will Penske Provide Substitutes	Yes
	Lease Term	60 months		Washes Per Year	26
	Customer Domicile Location	UPPER CHICHESTER, PA		Paint and Letter Allowance	\$0(one time)
	PTL Service Location	PHILADELPHIA AIRPORT, PA			
CONTRACT	Original Agreed Value	\$109,151	LEGALIZATION	License Weight	19,500 lbs
	Depreciation Credit	\$836.00/month		License Type	Base
	Est. Annual Miles	25,000/year		License Allowance	\$610 /year (Penske)
	Est. Annual Reefer Hours	n/a		Fuel and Mileage Tax Reporting	Penske Responsible
PRICING	Fixed Lease Charge	\$2,105.00/mn		HVUT Allowance	N/A
	Variable Charge	\$ 0.109/mi		PPT Allowance	\$0/year
	Reefer Running Hourly Rate	\$ 0.0000/hour		States/Provinces of Travel : DC, DE, MD, NJ, NY, OH, PA, VA, WV	
	Reefer Standby Hourly Rate	\$ 0.0000/hour			

*Abbreviation Key: N/A = Not Applicable

ADDITIONAL TERMS

Notwithstanding any statement to the contrary in the Vehicle Lease Service Agreement (the "VLSA") identified below, with respect to each Vehicle described herein, this Schedule constitutes a separate instrument of lease between Penske and Customer on the terms set forth in the VLSA.

The specific Vehicle number, serial number, and in-service date for each schedule listed above will be provided separately to Customer by Penske after all vehicles on each Schedule "A" are placed in Customer's service.

Each Vehicle shall be operated according to the Estimated Annual Mileage/Vehicle("EAM") as listed on its Schedule "A". if at the anniversary of such Vehicle's In-Service Date, the actual miles operated by such Vehicle exceeds its total EAM by ten percent (10%), Customer shall pay Penske \$0.10 for each mile over the EAM, in addition to the mileage charges due under this VLSA.

Rates are only effective during the original agreed upon lease term. If Customer continues to operate Vehicles after expiration of the original lease term, the lease for the expired Vehicle will convert to a month to month term and the fixed lease charge and variable charges for each expired Vehicle will increase at charges that vary over time.

If after the date of this Schedule A, the manufacturer of a Vehicle imposes any increase in the price of the Vehicle or imposes any surcharges (whether relating to commodities, raw materials, tariffs, or otherwise), or in the event the Vehicle as delivered is of a newer model year than as set forth herein, Penske may make corresponding changes to the Original Agreed Value, Depreciation Credit Per Month, and/or Fixed Lease Charge for the affected Vehicle.

To the extent any Vehicle on this schedule requires Diesel Exhaust Fluid (DEF), Penske may provide Customer with DEF at Penske's rates then in effect, including any applicable taxes and fees, and the charges for DEF will appear on Customer's fuel invoice or otherwise be billed weekly.

Customer agrees to pay for initial fueling upon in-service. Customer may return the Vehicle(s) empty at end of term.

If Penske is designated to provide Fuel Tax Reporting, Customer agrees to submit Driver Trip Reports, toll receipts, and fuel receipts

U.S. ONLY:It is mutually agreed that the agreement to which this Schedule "A" is a part is an "installment lease contract" as defined in Article 2A of the Uniform Commercial Code.

Customer is responsible for and shall comply with local, State and Federal laws relating to emissions that apply to registration, operation and testing of the Vehicle and any of its equipment, including, but not limited to, California laws that apply to Transport Refrigeration Units.

The rates and charges set forth in this Schedule A are based on interest rates in effect as of date the Schedule is fully executed ("Effective Date"). If the In-Service Date for the Vehicle(s) occurs more than ninety (90) days after the Effective Date, then Penske may adjust the Fixed Lease Charge for the Vehicle as set forth below.

In the event that the Interest Rate in effect on the last day of the month immediately preceding the month in which In-Service Date for the Vehicle(s) occurs ("Rate Determination Date") is 50 basis points (0.50%) or more above the Interest Rate on the Effective Date, the initial annualized Fixed Lease Charge, shall be adjusted upward as follows: for each increase of one basis point (0.01%) in the Interest Rate, the Fixed Lease Charge shall be increased by \$0.072 for each \$1,000 of Original Agreed Value of the applicable Vehicle(s) and apportioned pursuant to the agreed upon billing cycle (whether that be monthly, quarterly or annually). For purposes of this section, "Interest Rate" shall be defined to mean the five-year (constant maturity) U.S. Treasury Note rate as published weekly in the Federal Reserve Statistical Release H.15 of Selected Interest Rates. In the event that Penske makes such an adjustment, Penske will communicate to Customer the adjusted Fixed Lease Charges pursuant to the agreed-upon billing cycle.

Effective 5/21/2025, this Schedule "A" is hereby made a part of the Vehicle Lease Service Agreement dated: 04/26/2017

Penske Truck Leasing Co. L.P.

CUSTOMER : Cybercrunch Incorporated

Signed by:
SIGNATURE: Christa Brand
89DD63473E074FD
TITLE: Sr Mgr- Contract Admin
DATE: 5/21/2025

DocuSigned by:
SIGNATURE: Serdar Bankaci
4DAA8B02276E42F
TITLE: President
DATE: 5/7/2025



**VEHICLE LEASE SERVICE AGREEMENT
Schedule "A" Amendments**

Schedule A - 25-01

THIS AMENDMENT is made this 7th day of May, 2025 to the VEHICLE LEASE SERVICE AGREEMENT dated as of 04/26/2017 (the "VLSA") between Penske Truck Leasing Co. L.P. ("PENSKE TRUCK LEASING") and Cybercrunch Incorporated ("CUSTOMER"). Intending to be legally bound, the parties agree that the VLSA is amended as follows:

Substitute Vehicle Included for Scheduled PM's and PA State Inspections

The vehicle contained on Schedule A Number 25-01 includes substitute vehicle to be provided for scheduled PM's and PA state inspections.

Schedule "A" annexed and made a part of VEHICLE LEASE SERVICE AGREEMENT dated 04/26/2017 between Cybercrunch Incorporated and Penske Truck Leasing Co. L.P. effective on 5/21/2025

Penske Truck Leasing Co. L.P.

CUSTOMER: Cybercrunch Incorporated

Signed by: Christa Brand
SIGNATURE 89DD63473E074FD

TITLE: Sr Mgr- Contract Admin

DATE: 5/21/2025

DocuSigned by: Serdar Bankaci
SIGNATURE 4DAA8B02276E42F

TITLE: President

DATE: 5/7/2025

Associate Name: George Moleski

Proposal Id: 876910

Page: 1 of 1

Date of Preparation: 05/07/2025

Printed Date: 05/07/2025



Vehicle Lease Service Agreement
Schedule "S" Vehicle Specifications for Schedule "A" No. 25-01
Penske Location: 6800 ESSINGTON AVE, PHILADELPHIA, PA 19153
Customer: Cybercrunch Incorporated

2026 ISUZU NRR EFI

Single Axle Truck

6,018 ETW / 19,500 GVW

AERODYNAMICS

Roof Aerodynamics NO ROOF MOUNTED AIR DEFLECTOR

BASE SPEC

Base Spec ISUZU NRR EFI COE CHASSIS

BRAKES

Anti-Lock HYDRAULIC BRAKE ANTILOCK

Brake Package BRAKE SYSTEM - HYDRAULIC - VACUUM + POWER ASSIST - 4-WHEEL DISC BRAKES WITH 4-CHANNEL ABS - MECHANICAL TRANSMISSION MOUNTED PARKING BRAKE - NON-ASBESTOS SEMI METALLIC LININGS

Front Brakes FRONT DISC BRAKES

Parking Brake PARKING BRAKE - MECHANICAL - Cable actuated, internal expanding drum type, transmission mounted

Rear Brakes REAR DISC BRAKES

CAB EXTERIOR

Cab Standard Cab - Gas

Cab Paint FACTORY PAINT - CAB EXTERIOR COLOR - ARCTIC WHITE

Cab Paint Protection NO CAB PAINT PROTECTION

Electric Horn SINGLE ELECTRIC HORN

Hood Mounted Grille MATTE SILVER GRILLE

Key Options (4) KEYS PER VEHICLE

Keyless Entry NO KEYLESS ENTRY

Primary Mirror Brackets MIRROR BRACKET FOR 96" WIDE BODY

Primary Mirrors MIRRORS - HEATED, DUAL 16" X 7" RETRACTABLE WITH INTEGRAL CONVEX SECTION - N SERIES

Windshield Wiper Motor 2 - SPEED ELECTRIC WIPERS

CAB EXTERIOR FLEET TRIM

ELECTRIC WINDSHIELD WASHER

TINTED GLASS

CAB INTERIOR

Additional Switches (1) AUXILIARY SWITCH FOR CONTROL OF BODY DOME LIGHTS

Cab A/C Package AIR CONDITIONING

Cab Floor Covering BLACK FLOOR MATS

Cruise Control CRUISE CONTROL

Door Window Regulator and Locks POWER DOOR LOCKS AND POWER WINDOWS

Driver Seat NON-SUSPENSION DRIVER SEAT WITH TWO SINGLE OCCUPANT FOLD DOWN SEATS WITH TRAY BACKS (Tricot Breathable Cloth)

Gauges ODOMETER

Interior Lighting DOME LIGHT

Interior Trim Level FLEET TRIM - N-SERIES GAS - DARK AND LIGHT GRAY ACCENTS WITH GRAY AND BLUE CROSS-PATTERN TRICOT SEAT FABRIC

Interior Visors DUAL PADDED SUN VISORS

Passenger Seat SPLIT TWO MAN PASSENGER SEAT - Reference picture for details

Radio RADIO - AM/FM/CD RADIO w/AUX INPUT, USB PORT AND BLUETOOTH

Seat Belts SEAT BELTS - DRIVER ONLY - HIGH VISIBILITY ORANGE (Passenger seat belt is standard color)

Steering Column STEERING COLUMN - TILT AND TELESOPING

CAB INTERIOR HEATER AND DEFROSTER

WARNING LIGHTS - ENGINE OIL AND WATER TEMPERATURE

HAZARD SWITCH

KEY STARTER SWITCH

DUAL INTERIOR GRAB HANDLES - DRIVER AND PASSENGER SIDE - N SERIES

VINYL PADDED DOOR PANEL WITH ARMREST - N SERIES

CLOTH HEADLINER

ENGINE

Engine GMPT - L8T - 6.6 LITER - 350 HP @ 4500 RPM, 425 lb/ft @ 3800 RPM

ENGINE EQUIPMENT

Air Cleaner AIR CLEANER - DRY PAPER SINGLE ELEMENT

THIS COPYRIGHT-PROTECTED WORK MAY NOT BE COPIED, REPRODUCED OR DISTRIBUTED WITHOUT WRITTEN CONSENT OF PENSKE TRUCK LEASING CO., L.P. ANY UNAUTHORIZED USE IS EXPRESSLY PROHIBITED AND SHALL BE CONSIDERED COPYRIGHT INFRINGEMENT

Proposal Id - 876910-2858-33333, AccountId - 6182704-2858-33333, Associate Name - George Moleski, Status - Quoted, DealItemId - 5534083-2858-33333, Printed Date - 05/07/2025



Vehicle Lease Service Agreement
Schedule "S" Vehicle Specifications for Schedule "A" No. 25-01
Penske Location: 6800 ESSINGTON AVE, PHILADELPHIA, PA 19153
Customer: Cybercrunch Incorporated

2026 ISUZU NRR EFI

Single Axle Truck

6,018 ETW / 19,500 GVW

ENGINE EQUIPMENT

Air Restriction Indicator	AIR FILTER MINDER
Alternator	170 AMP ALTERNATOR
Battery	(2) AGM ODYSSEY EXTREME 12V BATTERIES - 2300 CCA
Block Heater	NO BLOCK HEATER
Cold Weather Package	COLD WEATHER PACKAGE
Engine Coolant	ANTIFREEZE - LONG LIFE COOLANT ADDITIVE NITRATE FREE
Engine Fan Drive	VISCOUS FAN CLUTCH
Exhaust System	SINGLE HORIZONTAL ALUMINIZED STEEL WITH CATALYTIC CONVERTER AND OXYGEN SENSOR DEVICES
Starter	STARTER - 12 VOLT
ENGINE EQUIPMENT	2024 EMISSIONS ENGINE
	50 STATE EMISSIONS

FRAME / WHEEL BASE

Body Type	DRY FREIGHT
Cooling Unit Type	NO COOLING UNIT SELECTED
Frame	LADDER TYPE CHANNEL SECTION STRAIGHT FRAME - N-Series Gas - 33.5" WIDE, rivetless top flange, 5mm thick, side rail section 8.5 in. X 2.76 in. X 0.24 in., 44,000 psi yield strength, Rated RBM (per rail) 316,800 lb-in N-Series Gas
Front Bumper	BUMPER - WHITE
Rear Frame Overhang	43.0" REAR FRAME OVERHANG
Wheelbase	176" WHEELBASE - 153.5" CA

FUEL TANKS

Fuel Tank(s)	(1) - 38.6 GALLON TANK - MOUNTED BETWEEN FRAME RAILS - Stainless Steel
--------------	--

LIGHTING

Headlights	HEADLAMPS - LED - FLUSH SURFACE WITH INTEGRAL PARKING, TURN SIGNALS AND CORNERING LAMPS
Light Package	NO LIGHTING PACKAGE - INCANDESCENT LIGHTS FOR EXTERIOR LIGHTING (EXCLUDES HEADLIGHTS)
LIGHTING	LED CAB CLEARANCE / MARKER LIGHTS - N SERIES
	FLASHER - L.E.D. STYLE

MISCELLANEOUS

MA Domicile	VEHICLE(S) WILL NOT DOMICILE WITHIN THE COMMONWEALTH OF MASSACHUSETTS
DOT Number Classification	MY CUSTOMER'S DOT# IS ESTABLISHED AS INTERSTATE. This vehicle will travel between two or more states.
Registration Type	BASE PLATE IN NON-ACT STATE
Registration State	_NON-ACT STATE
Backup Alarm	BACK-UP ALARM - 97 dB
Collision Warning System	FORWARD COLLISION AND LANE DEPARTURE WARNING (PASSIVE ADVANCED DRIVER ASSISTANCE SYSTEM)
Corporate Predelivery and PDI Work	PENSKE IN-SERVICE
Lane Departure System	LANE DEPARTURE WARNING - Included with Collision Warning System
Model Year	2026 MODEL YEAR
Vehicle Stability Control	ELECTRONIC VEHICLE STABILITY CONTROL - EVSC monitors the truck's steering wheel angle, individual wheel rotation speed, lateral G forces and more. When the system senses the vehicle is at risk of losing stability it alerts the driver via an on-dash warning light and automatically reduces engine output and applies braking pressure as needed to help the truck maintain stability.
MISCELLANEOUS	E-Z SPEC
	TRAILER BRAKE PROVISIONS
	FIRE EXTINGUISHER AND TRIANGLE KIT MOUNTED IN REAR ORGANIZER
	SPARTAN MOTORS (SHYFT GROUP) DOT INSPECTION
	FACTORY PREDELIVERY CHARGE WITH PENSKE IN-SERVICE - N SERIES

PDI OPTIONS

Engine Exhaust Cat Protection	CAT CAGE NQR/NRR EFI - BUILT MORE MOD CENTER SUPPLY AND INSTALL
-------------------------------	---

POWER TRAIN

Front Axle	7,275 lb CAPACITY - STEEL DROP FORGED REVERSE ELLIOT - I-BEAM
Front Axle Lube	FRONT AXLE LUBE TYPE - GREASE

THIS COPYRIGHT-PROTECTED WORK MAY NOT BE COPIED, REPRODUCED OR DISTRIBUTED WITHOUT WRITTEN CONSENT OF PENSKE TRUCK LEASING CO., L.P. ANY UNAUTHORIZED USE IS EXPRESSLY PROHIBITED AND SHALL BE CONSIDERED COPYRIGHT INFRINGEMENT

Proposal Id - 876910-2858-33333, AccountId - 6182704-2858-33333, Associate Name - George Moleski, Status - Quoted, DealItemId - 5534083-2858-33333, Printed Date - 05/07/2025



Vehicle Lease Service Agreement
Schedule "S" Vehicle Specifications for Schedule "A" No. 25-01
Penske Location: 6800 ESSINGTON AVE, PHILADELPHIA, PA 19153
Customer: Cybercrunch Incorporated

2026 ISUZU NRR EFI

Single Axle Truck

6,018 ETW / 19,500 GVW

POWER TRAIN

Front Axle Oil Seals	FRONT SEALS - GREASE
Front Suspension	8,440 lb CAPACITY SEMI-ELLIPTICAL TAPERED LEAF SPRINGS
Power Steering	POWER STEERING
PTO Options	NO PTO OPTION
Rear Axle	14,550 lb CAPACITY REAR AXLE
Rear Axle Lube	REAR AXLE LUBE TYPE - OIL
Rear Axle Oil Seals	REAR SEALS - OIL
Rear Axle Ratio	5.375 REAR AXLE RATIO
Rear Suspension	14,550 lb CAPACITY SEMI-ELLIPTICAL MAIN AND AUXILIARY MULTI-LEAF SPRINGS, INCLUDES SHOCK ABSORBERS
Traction Control	NO LIMITED SLIP DIFFERENTIAL
Transmission	6 SPEED ALLISON AUTOMATIC TRANSMISSION - 1000 RDS
POWER TRAIN	FRONT AND REAR SHOCK ABSORBERS
	REAR AXLE MAGNETIC DRAIN PLUG
	FRONT STABILIZER BAR
	DECAL WITH FACTORY SETTINGS FOR CASTER, CAMBER AND TOE-IN

ROAD SPEED & CRUISE

Cruise	65 MPH CRUISE SPEED
Road Speed	65 MPH ROAD SPEED

TIRES & WHEELS

Front Hubs	STANDARD FRONT WHEEL HUBS
Front Tires	FRONT TIRES - OEM - 225/70R19.5G - 14 PLY
Front Wheels	FRONT WHEELS - 19.5" X 6" STEEL DISC
Rear Hubs	STANDARD REAR WHEEL HUBS
Rear Tires	REAR TIRES - OEM - 225/70R19.5G - 14 PLY
Rear Wheels	REAR WHEELS - 19.5" X 6" STEEL DISC
TIRES & WHEELS	WHITE WHEELS

VOCATION AND COMMODITY

Requested Gross Vehicle Weight	19,500 lbs
Vehicle Type	TRUCK APPLICATION

COLORS & CODES

CAB [White, 000]
 FRAME [Black, STD]
 FRONTWHEELS [White, 000]
 REARWHEELS [White, 000]

ENGINE PARAMETERS

CRUISE: [65 MPH]
 HORSEPOWER: [350 HORSE POWER]
 IDLE TIME: [0 MIN]
 PTO: [0 RPM]
 ROADSPEED: [65 MPH]
 TORQUE: [425 FT/LB]

THIS COPYRIGHT-PROTECTED WORK MAY NOT BE COPIED, REPRODUCED OR DISTRIBUTED WITHOUT WRITTEN CONSENT OF PENSKE TRUCK LEASING CO., L.P. ANY UNAUTHORIZED USE IS EXPRESSLY PROHIBITED AND SHALL BE CONSIDERED COPYRIGHT INFRINGEMENT

Proposal Id - 876910-2858-33333, AccountId - 6182704-2858-33333, Associate Name - George Moleski, Status - Quoted, DealItemId - 5534083-2858-33333, Printed Date - 05/07/2025



Vehicle Lease Service Agreement
Schedule "S" Vehicle Specifications for Schedule "A" No. 25-01
Penske Location: 6800 ESSINGTON AVE, PHILADELPHIA, PA 19153
Customer: Cybercrunch Incorporated

Selected Options

CAB EXTERIOR	
Key Options	(4) KEYS PER VEHICLE
CAB INTERIOR	
Seat Belts	SEAT BELTS - DRIVER ONLY - HIGH VISIBILITY ORANGE (Passenger seat belt is standard color)
MISCELLANEOUS	
MA Domicile	VEHICLE(S) WILL NOT DOMICILE WITHIN THE COMMONWEALTH OF MASSACHUSETTS
DOT Number Classification	MY CUSTOMER'S DOT# IS ESTABLISHED AS INTERSTATE. This vehicle will travel between two or more states.
Registration Type	BASE PLATE IN NON-ACT STATE
Registration State	_NON-ACT STATE

Schedule "S" annexed to and made a part of Vehicle Lease Service Agreement dated 04/26/2017 between Cybercrunch Incorporated and Penske Truck Leasing Co. L.P.

Penske Truck Leasing Co. L.P.

Signature

Christa Brand

89DD63473E074FD

Title:

Sr Mgr- Contract Admin

Date: **5/21/2025**

CUSTOMER: Cybercrunch Incorporated

Signature

Serdar Bankaci

4DAAB02276E42F

Title:

President

Date: **5/7/2025**

THIS COPYRIGHT-PROTECTED WORK MAY NOT BE COPIED, REPRODUCED OR DISTRIBUTED WITHOUT WRITTEN CONSENT OF PENSKE TRUCK LEASING CO., L.P. ANY UNAUTHORIZED USE IS EXPRESSLY PROHIBITED AND SHALL BE CONSIDERED COPYRIGHT INFRINGEMENT

Proposal Id - 876910-2858-33333, AccountId - 6182704-2858-33333, Associate Name - George Moleski, Status - Quoted, DealItemId - 5534083-2858-33333, Printed Date - 05/07/2025



Vehicle Lease Service Agreement
Schedule "S" Vehicle Specifications for Schedule "A" No. 25-01
Penske Location: 6800 ESSINGTON AVE, PHILADELPHIA, PA 19153
Customer: Cybercrunch Incorporated

2025 WABASH Freight Aluminum Van

Dry

3,321 ETW / 18' L x 91" H x 96" W

BASE SPEC

Base Spec 18' Dry Freight Aluminum Van

BODY DIMENSIONS

Body Dimension Notes	Note: Rear Door Opening Height and Width Dimensions with Overhead Door
Body Dimension Notes	Note: Interior width dimension includes 3/8" plywood lining on side walls.
Inside Body Height	91" Inside Body Height
Inside Body Length	18' 2" Inside Body Length
Inside Body Width	92 1/2" Inside Body Width
Rear Door Opening Height	85" High Rear Door Opening
Rear Door Opening Width	88" Wide Rear Door Opening
Length	18'
Height	91" High
Width	96" Wide

BODY EXTERIOR

Attic / Peak	NO ATTIC / PEAK
Body Color	PAINT BODY - PREPAINTED WHITE
Cab Color	CAB PAINTED O.E.M. COLOR
Conspicuity Tape	CONSPICUITY TAPE - FULL LENGTH EACH SIDE ON BOTTOM RAIL, ACROSS UNDERRIDE, ACROSS BOTTOM OF REAR DOOR AND 12" x 12" INVERTED L's ON UPPER REAR CORNERS
CrossView Mirrors	NO CROSS VIEW MIRROR
Dock Bumper	MAXON INTEGRATED LIFTGATE BUMPER WITH 2 SLIP RESISTANT STEPS
Grab Handles	GRAB HANDLES - (2) 12" GRAB HANDLES ONE CURBSIDE (RIGHT SIDE) AND ONE ROADSIDE (LEFT SIDE)
Front Corner Cap	MOLDED COMPOSITE FRONT CORNER CAP
Front Corner Post	FRONT CORNER POST - ALUMINUM 12" RADIUS WITH 5" ALUMINUM VERTICAL POSTS WITH HAT REINFORCED HORIZONTAL - INCLUDES INTERIOR PROTECTIVE WIRE COVER
Front Panels	FRONT WALL PANEL - FIBERGLASS REINFORCED PLYWOOD 1/2" CORE - EXTERIOR FINISH SMOOTH WHITE GELCOAT, INTERIOR FINISH SMOOTH WHITE RESIN.
Lighting	LIGHTS - L.E.D. LIGHTING PER FMVSS-108. AMBER AND RED CLEARANCE LIGHTS, PART # 36110 R/Y, LICENSE PLATE LIGHT, PART # 15041. LIGHTS RECESSED IN CORNER POSTS, RED TAIL LIGHT, PART # 60256R, L.E.D. BACK-UP LIGHT.
Load Lighting	NO LOAD LIGHT
Mounting	MOUNTING - TAPERED WOOD SLATS AND U-BOLTS
Object Detection System	NO REAR OBJECT DETECTION SYSTEM
Rear Frame	REAR FRAME - STAINLESS STEEL, BRUSHED #4 FINISH
Rear Landing Gear	NO REAR LANDING GEAR
Rear Vision Camera	BACK UP CAMERA SYSTEM - RVS Systems (SC-770613) WITH 7" LCD COLOR MONITOR - Note: All maintenance to the Back-Up Camera system is customer rebill
Rear Vision Camera Notes	Note: The flat monitor will be mounted overhead, in place of the rear view mirror, as a standard UNLESS the space does not allow for it. The alternative mounting location will be at the dash level.
Rear Vision Camera Guard	STAINLESS STEEL REAR CAMERA GUARD
Roof	ROOF - .032", ONE-PIECE ALUMINUM
Rub Rail	NO RUB RAIL
Safety Cone Holder	NO SAFETY CONE HOLDER
Safety Placards	NO SAFETY PLACARDS
Side Panels	SIDE WALL PANELS - PREPAINTED WHITE .040" ALUMINUM WITH Z-POSTS ON 24" CENTERS
Tree Limb Protectors	NO TREE LIMB PROTECTORS
Undercoating	PRE-COATED UNDERSTRUCTURE
Understructure	UNDERSTRUCTURE - 4" I-BEAM LONGITUDINALS, 3" I-BEAM CROSSMEMBERS ON 12" CENTERS WITH 12 GAUGE STEEL PAN OVER WHEEL AREA WITH CROSSMEMBERS ON 9" CENTERS AFTER REAR AXLE. MYLAR TAPE BETWEEN CROSSMEMBERS AND BOTTOM RAIL
Vents	NO VENTS
Wiring	WIRING - TRUCK-LITE, 10 YEAR WARRANTED, RETURN GROUND WIRING HARNESS, INCLUDING A 4-WAY TRAILER PLUG AT REAR FOR DRIVE-AWAY SERVICES - FULLY HARNESSSED
BODY EXTERIOR	RUBBER BLOCKS - ONE PAIR - 3" X 3" X 12" SOLID D-SHAPED, MOUNTED OUTBOARD, METAL REINFORCED
	REFLECTORS - PER FMVSS-108 REGULATIONS

THIS COPYRIGHT-PROTECTED WORK MAY NOT BE COPIED, REPRODUCED OR DISTRIBUTED WITHOUT WRITTEN CONSENT OF PENSKE TRUCK LEASING CO., L.P. ANY UNAUTHORIZED USE IS EXPRESSLY PROHIBITED AND SHALL BE CONSIDERED COPYRIGHT INFRINGEMENT

Proposal Id - 876910-2858-33333, AccountId - 6182704-2858-33333, Associate Name - George Moleski, Status - Quoted, DealItemId - 5534083-2858-33333, Printed Date - 05/07/2025



Vehicle Lease Service Agreement
Schedule "S" Vehicle Specifications for Schedule "A" No. 25-01
Penske Location: 6800 ESSINGTON AVE, PHILADELPHIA, PA 19153
Customer: Cybercrunch Incorporated

2025 WABASH Freight Aluminum Van

Dry

3,321 ETW / 18' L x 91" H x 96" W

BODY INTERIOR

Ceiling Lining	NO CEILING LINING
Dome Light	(1) - RECESSED LIGHT, WIRING IN LOOM, NEW STYLE GALVANIZED STEEL BRACKET
Dome Light Control	STANDARD OEM CHASSIS DASH MOUNTED SWITCH
Door Track Protector	NO REAR DOOR TRACK PROTECTORS
Floor Coating	NO FLOOR COATING
Flooring	1-1/8" LAMINATED HARDWOOD FLOOR WITH (2) 1/4" SCREWS PER BOARD PER CROSSMEMBER
Forklift Package	NO FORKLIFT PACKAGE
Front Wall E-Track	NO FRONT WALL E-TRACK
Front Wall Pallet Stops	NO PALLET STOPS
Front Wall Reinforcement	REINFORCEMENT - 12 GAUGE GALVANIZED STEEL, 20" HIGH WITH 2" RETURN LEG ATTACHED TO FRONT CROSSMEMBER (INCLUDED IN FORKLIFT PACKAGE)
Interior Slat Lining	INTERIOR LINING - 3/8" PLYWOOD FULL HEIGHT ON SIDES. INSTALL HORIZONTALLY WITH HAT SECTION REINFORCEMENT
Interior Slat Lining Attic	NO ATTIC SLAT LINING
Kickboard/Scuff Plate	KICKBOARD - SIDES AND FRONT 5/8" X 12" EARTHWISE PLASTIC
Kickboard/Scuff Plate - Additional Rows	NO ADDITIONAL KICKBOARD/SCUFF PLATE
Load Hold Bars	NO LOAD HOLD BARS
Roof Bows	ROOF BOWS - GALVANIZED STEEL ANTI-SNAG DESIGN ON 24" CENTERS
Side Wall E-Track	E-TRACK - SURFACE MOUNTED BOTH SIDES OF BODY - CUSTOMER MUST SPECIFY HEIGHT AND QUANTITY (3)
Tie Rings	NO TIE RINGS
Tie Rings Floor Mount	NO FLOOR TIE RINGS
BODY INTERIOR	Miscellaneous Body Interior Option

DOORS

Rear Door	REAR DOOR - ROLL-UP - WHITING - 1/4" DURAPLATE
Additional Rear Door Handle	NO ADDITIONAL DOOR HANDLE
Rear Door Strap	REAR DOOR STRAP - 19" STRAP - STANDARD - FOR DOORS 96" AND BELOW
Side Door	NO BODY SIDE DOOR SELECTED

MISCELLANEOUS

Backup Alarm Body	NO BACK-UP ALARM SELECTED ON THE BODY SPEC
Model Year	2025 MODEL YEAR
Country Domicile	USA DOMICILE
MISCELLANEOUS	DELETE ALL BODY COMPANY, DOOR, FLOOR AND LIFTGATE LOGOS, EXCEPT WHERE LEGALLY REQUIRED OR AGREED TO WITH SUPPLIER
	FLOOR HEIGHT - DEPENDING ON TIRE SIZE, CHASSIS, AND APPLICATION, WITH A MINIMUM OF 5-1/2" OF TIRE CLEARANCE
	MUD FLAPS - PLAIN BLACK, ANTI SPRAY WITH ANTI SAIL BRACKETS

POSITIONAL INFORMATION

E-TRACK - SURFACE MOUNTED BOTH SIDES OF BODY - CUSTOMER MUST SPECIFY HEIGHT AND QUANTITY (3)
All measurements are from floor to center line of the Track
Row(1): 30 inches
E-TRACK - SURFACE MOUNTED BOTH SIDES OF BODY - CUSTOMER MUST SPECIFY HEIGHT AND QUANTITY (3)
All measurements are from floor to center line of the Track
Row(2): 60 inches
E-TRACK - SURFACE MOUNTED BOTH SIDES OF BODY - CUSTOMER MUST SPECIFY HEIGHT AND QUANTITY (3)
All measurements are from floor to center line of the Track
Row(3): 79 inches

THIS COPYRIGHT-PROTECTED WORK MAY NOT BE COPIED, REPRODUCED OR DISTRIBUTED WITHOUT WRITTEN CONSENT OF PENSKE TRUCK LEASING CO., L.P. ANY UNAUTHORIZED USE IS EXPRESSLY PROHIBITED AND SHALL BE CONSIDERED COPYRIGHT INFRINGEMENT

Proposal Id - 876910-2858-33333, AccountId - 6182704-2858-33333, Associate Name - George Moleski, Status - Quoted, DealItemId - 5534083-2858-33333, Printed Date - 05/07/2025



Vehicle Lease Service Agreement
Schedule "S" Vehicle Specifications for Schedule "A" No. 25-01
Penske Location: 6800 ESSINGTON AVE, PHILADELPHIA, PA 19153
Customer: Cybercrunch Incorporated

Selected Options

BODY DIMENSIONS	
Height	91" High
BODY EXTERIOR	
Rear Vision Camera	BACK UP CAMERA SYSTEM - RVS Systems (SC-770613) WITH 7" LCD COLOR MONITOR - Note: All maintenance to the Back-Up Camera system is customer rebill
BODY INTERIOR	
Front Wall Reinforcement	REINFORCEMENT - 12 GAUGE GALVANIZED STEEL, 20" HIGH WITH 2" RETURN LEG ATTACHED TO FRONT CROSSMEMBER (INCLUDED IN FORKLIFT PACKAGE)
Kickboard/Scuff Plate	KICKBOARD - SIDES AND FRONT 5/8" X 12" EARTHWISE PLASTIC
Side Wall E-Track	E-TRACK - SURFACE MOUNTED BOTH SIDES OF BODY - CUSTOMER MUST SPECIFY HEIGHT AND QUANTITY

Schedule "S" annexed to and made a part of Vehicle Lease Service Agreement dated 04/26/2017 between Cybercrunch Incorporated and Penske Truck Leasing Co. L.P.

Penske Truck Leasing Co. L.P.

Signature: Christa Brand
 89DD63473E074FD

Title: Sr Mgr- Contract Admin Date: 5/21/2025

CUSTOMER: Cybercrunch Incorporated

Signature: Serdar Bankaci
 4DAA8B02276E42F

Title: President Date: 5/7/2025

THIS COPYRIGHT-PROTECTED WORK MAY NOT BE COPIED, REPRODUCED OR DISTRIBUTED WITHOUT WRITTEN CONSENT OF PENSKE TRUCK LEASING CO., L.P. ANY UNAUTHORIZED USE IS EXPRESSLY PROHIBITED AND SHALL BE CONSIDERED COPYRIGHT INFRINGEMENT

Proposal Id - 876910-2858-33333, AccountId - 6182704-2858-33333, Associate Name - George Moleski, Status - Quoted, DealItemId - 5534083-2858-33333, Printed Date - 05/07/2025



Vehicle Lease Service Agreement
Schedule "S" Vehicle Specifications for Schedule "A" No. 25-01
Penske Location: 6800 ESSINGTON AVE, PHILADELPHIA, PA 19153
Customer: Cybercrunch Incorporated

2025 WABASH Freight Aluminum Van

Dry

3,321 ETW / 18' L x 91" H x 96" W

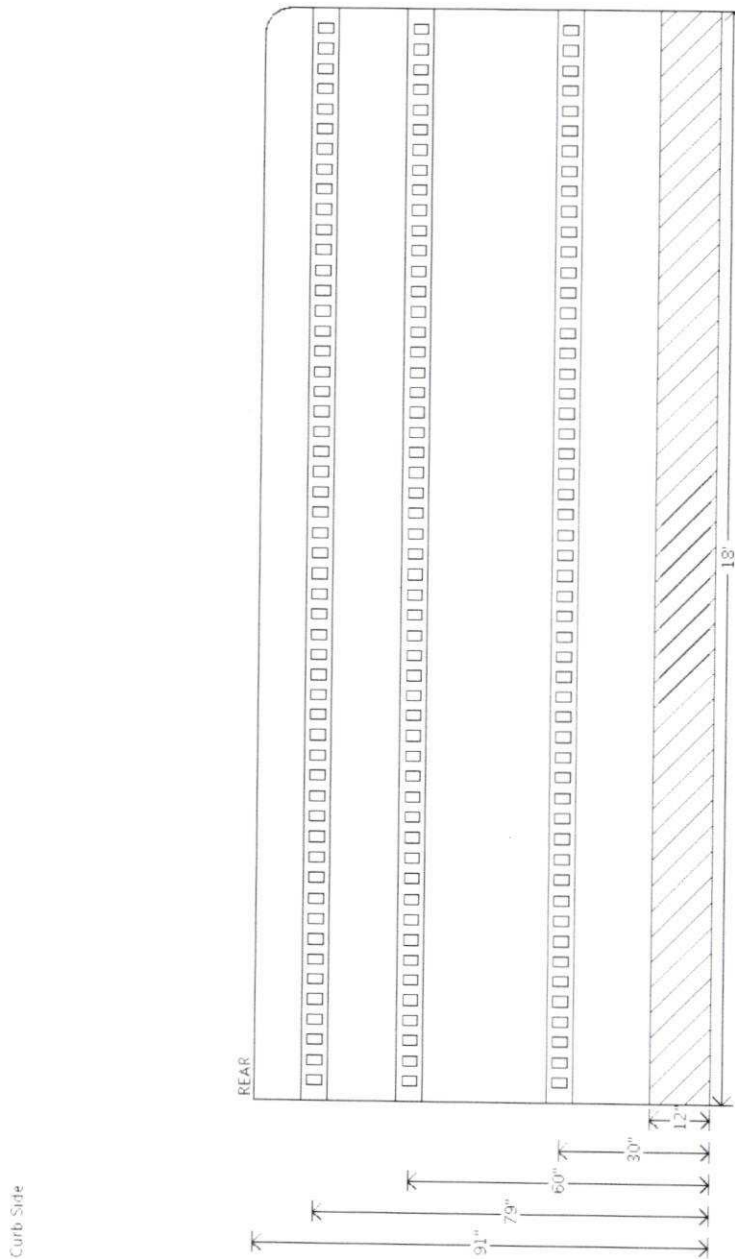

THIS COPYRIGHT-PROTECTED WORK MAY NOT BE COPIED, REPRODUCED OR DISTRIBUTED WITHOUT WRITTEN CONSENT OF PENSKE TRUCK LEASING CO., L.P. ANY UNAUTHORIZED USE IS EXPRESSLY PROHIBITED AND SHALL BE CONSIDERED COPYRIGHT INFRINGEMENT

Proposal Id - 876910-2858-33333, AccountId - 6182704-2858-33333, Associate Name - George Moleski, Status - Quoted, DealItemId - 5534083-2858-33333, Printed Date - 05/07/2025



Vehicle Lease Service Agreement
Schedule "S" Vehicle Specifications for Schedule "A" No. 25-01
Penske Location: 6800 ESSINGTON AVE, PHILADELPHIA, PA 19153
Customer: Cybercrunch Incorporated

2025 WABASH Freight Aluminum Van

Dry

3,321 ETW / 18' L x 91" H x 96" W

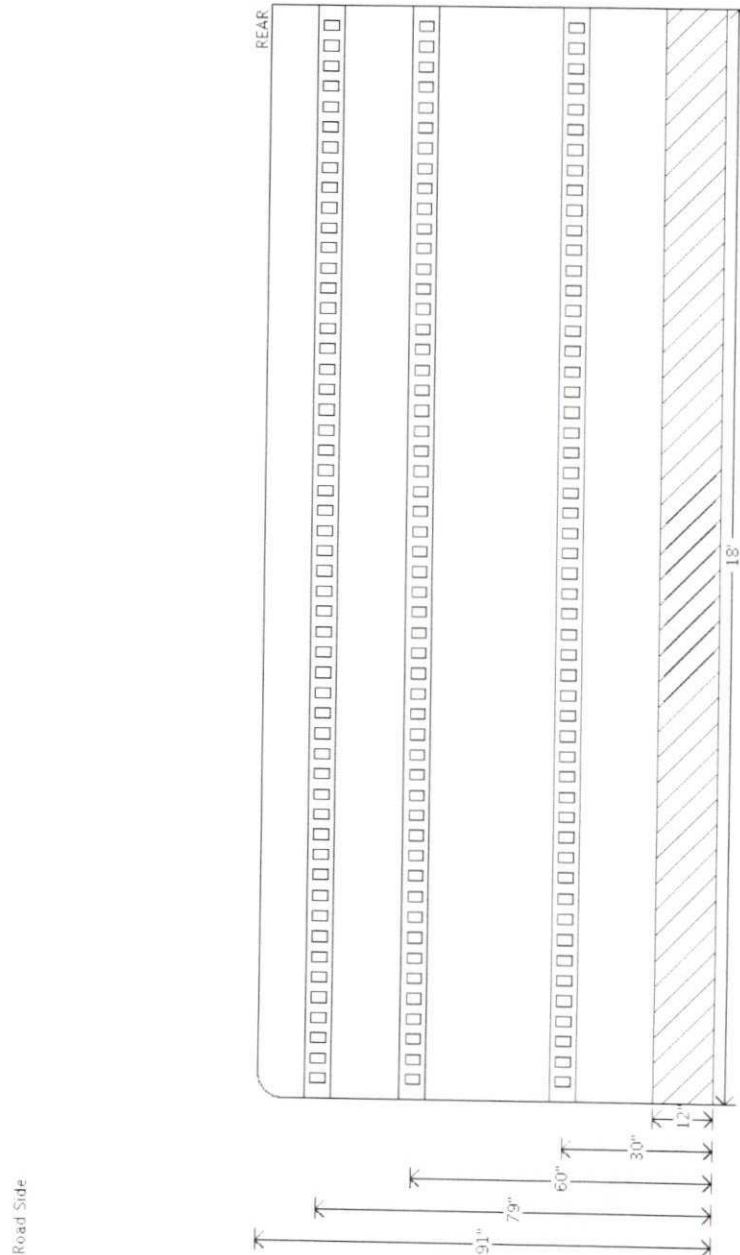

THIS COPYRIGHT-PROTECTED WORK MAY NOT BE COPIED, REPRODUCED OR DISTRIBUTED WITHOUT WRITTEN CONSENT OF PENSKE TRUCK LEASING CO., L.P. ANY UNAUTHORIZED USE IS EXPRESSLY PROHIBITED AND SHALL BE CONSIDERED COPYRIGHT INFRINGEMENT

Proposal Id - 876910-2858-33333, AccountId - 6182704-2858-33333, Associate Name - George Moleski, Status - Quoted, DealItemId - 5534083-2858-33333, Printed Date - 05/07/2025



Vehicle Lease Service Agreement
Schedule "S" Vehicle Specifications for Schedule "A" No. 25-01
Penske Location: 6800 ESSINGTON AVE, PHILADELPHIA, PA 19153
Customer: Cybercrunch Incorporated

2025 WABASH Freight Aluminum Van

Dry

3,321 ETW / 18' L x 91" H x 96" W

Front

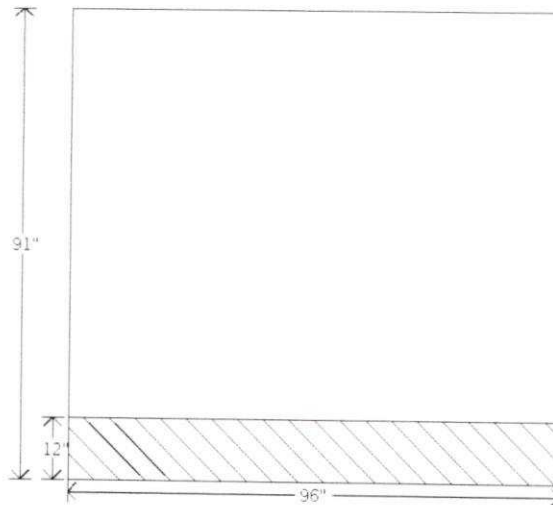

THIS COPYRIGHT-PROTECTED WORK MAY NOT BE COPIED, REPRODUCED OR DISTRIBUTED WITHOUT WRITTEN CONSENT OF PENSKE TRUCK LEASING CO., L.P. ANY UNAUTHORIZED USE IS EXPRESSLY PROHIBITED AND SHALL BE CONSIDERED COPYRIGHT INFRINGEMENT

Proposal Id - 876910-2858-33333, AccountId - 6182704-2858-33333, Associate Name - George Moleski, Status - Quoted, DealItemId - 5534083-2858-33333, Printed Date - 05/07/2025



Vehicle Lease Service Agreement
Schedule "S" Vehicle Specifications for Schedule "A" No. 25-01
Penske Location: 6800 ESSINGTON AVE, PHILADELPHIA, PA 19153
Customer: Cybercrunch Incorporated

2025 LIFTGATE OEM

Tuk-A-Way

755 ETW

LIFTGATE

Model	<i>Maxon TE-25L - 2,500 lb Capacity</i>
Bed Height Minimum	38" Minimum Bed Height
Type	Tuk-A-Way

LIFTGATE OPTIONS

Cart Stops	<i>Dual Cart Stops</i>
Cut-Off Switch	Cut-Off Switch in Cab with Indicator Light
Cycle Counter	Cycle counter for Maxon gates
Dual Controls	No Dual Liftgate Controls
Hand Held Remote Control	No Hand Held Remote Control
Material	Galvanized Liftgate
Mounting	Penske preferred mounting is Bolt On when available.
Operation	<i>Power Down</i>
Platform Finish	No special platform finish or coating
Pump Assembly	Single Pump Assembly
Solar Charger	No Solar Charger Kit
Outside Width	96" Outside Width
Platform	<i>48" X 80" Aluminum Wedge Platform</i>

MISCELLANEOUS

Body/Trailer Manufacturer	Wabash Dryvan
----------------------------------	---------------

THIS COPYRIGHT-PROTECTED WORK MAY NOT BE COPIED, REPRODUCED OR DISTRIBUTED WITHOUT WRITTEN CONSENT OF PENSKE TRUCK LEASING CO., L.P. ANY UNAUTHORIZED USE IS EXPRESSLY PROHIBITED AND SHALL BE CONSIDERED COPYRIGHT INFRINGEMENT

Proposal Id - 876910-2858-33333, AccountId - 6182704-2858-33333, Associate Name - George Moleski, Status - Quoted, DealItemId - 5534083-2858-33333, Printed Date - 05/07/2025



Vehicle Lease Service Agreement
Schedule "S" Vehicle Specifications for Schedule "A" No. 25-01
Penske Location: 6800 ESSINGTON AVE, PHILADELPHIA, PA 19153
Customer: Cybercrunch Incorporated

Selected Options

LIFTGATE	
Model	<i>Maxon TE-25L - 2,500 lb Capacity</i>
LIFTGATE OPTIONS	
Cart Stops	<i>Dual Cart Stops</i>
Operation	<i>Power Down</i>
Platform	<i>48" X 80" Aluminum Wedge Platform</i>

Schedule "S" annexed to and made a part of Vehicle Lease Service Agreement dated 04/26/2017 between Cybercrunch Incorporated and Penske Truck Leasing Co. L.P.

Penske Truck Leasing Co. L.P.

Signature: Christa Brand

89DD63473E074FD

Title: Sr Mgr- Contract Admin Date: 5/21/2025

CUSTOMER: Cybercrunch Incorporated

Signature: Serdar Bankaci

4DAA8B02276E42F

Title: President Date: 5/7/2025

THIS COPYRIGHT-PROTECTED WORK MAY NOT BE COPIED, REPRODUCED OR DISTRIBUTED WITHOUT WRITTEN CONSENT OF PENSKE TRUCK LEASING CO., L.P. ANY UNAUTHORIZED USE IS EXPRESSLY PROHIBITED AND SHALL BE CONSIDERED COPYRIGHT INFRINGEMENT

Proposal Id - 876910-2858-33333, AccountId - 6182704-2858-33333, Associate Name - George Moleski, Status - Quoted, DealItemId - 5534083-2858-33333, Printed Date - 05/07/2025