

**Section 1: Applicant Identification**

1. Applicant's Name: LEWES BOARD OF  
 Mailing Address: PUBLIC WORKS  
c/o Austin Calaman, Gen. Mgr.  
107 Franklin Ave., Lewes DE 19958

Telephone #: (302) 462-0049  
 Fax #: \_\_\_\_\_  
 E-mail: acalaman@lewesbpwde.gov

2. Consultant's Name: Evelyn Maurmeyer  
 Mailing Address: PO Box 674  
Lewes, DE 19958

Company Name: CER, Inc.  
 Telephone #: (302) 645-9610  
 Fax #: (302) 645-4332  
 E-mail: maurmeyer@udel.edu

3. Contractor's Name: Not yet selected  
 Mailing Address: \_\_\_\_\_

Company Name: \_\_\_\_\_  
 Telephone #: \_\_\_\_\_  
 Fax #: \_\_\_\_\_  
 E-mail: \_\_\_\_\_

**Section 2: Project Description**

4. Check those that apply:  
 New Project/addition to existing project?       Repair/Replace existing structure? (If checked, must answer #16)

5. Project Purpose (attach additional sheets as necessary):  
Applicant proposes to install 1,923 linear feet of 18" OD HDPE  
water main pipe by underground Horizontal Directional Drill (HDD).  
See attached Project Description for details.

6. Check each Appendix that is enclosed with this application:

<input type="checkbox"/> A. Boat Docking Facilities	<input type="checkbox"/> G. Bulkheads	<input type="checkbox"/> N. Preliminary Marina Checklist
<input type="checkbox"/> B. Boat Ramps	<input type="checkbox"/> H. Fill	<input type="checkbox"/> O. Marinas
<input type="checkbox"/> C. Road Crossings	<input type="checkbox"/> I. Rip-Rap Sills and Revetments	<input type="checkbox"/> P. Stormwater Management
<input type="checkbox"/> D. Channel Modifications/Dams	<input checked="" type="checkbox"/> J. Vegetative Stabilization	<input type="checkbox"/> Q. Ponds and Impoundments
<input checked="" type="checkbox"/> E. Utility Crossings	<input type="checkbox"/> K. Jetties, Groins, Breakwaters	<input type="checkbox"/> R. Maintenance Dredging
<input type="checkbox"/> F. Intake or Outfall Structures	<input type="checkbox"/> M. Activities in State Wetlands	<input type="checkbox"/> S. New Dredging

**Section 3: Project Location**

7. Project Site Address: Gills Neck Rd.  
to American Legion Rd.,  
Lewes, DE 19958

County:  N.C.  Kent  Sussex  
 Site owner name (if different from applicant): same  
 Address of site owner: "

8. Driving Directions: See Figures 1 and 2 for maps and directions.

(Attach a vicinity map identifying road names and the project location)

9. Tax Parcel ID Number: #335-8.08-1.00      Subdivision Name: The City of Lewes

WSLS Use Only:		Permit #s: _____	
Type	SP <input type="checkbox"/>	SL <input type="checkbox"/>	SU <input type="checkbox"/>
	WE <input type="checkbox"/>	WQ <input type="checkbox"/>	LA <input type="checkbox"/>
	SA <input type="checkbox"/>	MP <input type="checkbox"/>	WA <input type="checkbox"/>
Corps Permit:	SPGP 18 <input type="checkbox"/>	20 <input type="checkbox"/>	Nationwide Permit #: _____
Received Date:	_____	Project Scientist:	_____
Fee Received?	Yes <input type="checkbox"/>	No <input type="checkbox"/>	Amt: \$ _____
Public Notice #:	_____	Receipt #:	_____
Public Notice Dates:	ON _____	OFF _____	

Section 3: Project Location (Continued)

10. Name of waterbody at Project Location: Lewes and Rehoboth Canal waterbody is a tributary to: Delaware Bay

11. Is the waterbody:  Tidal  Non-tidal Waterbody width at mean low or ordinary high water 205' ±

12. Is the project:  On public subaqueous lands?  On private subaqueous lands?\*  
 In State-regulated wetlands?  In Federally-regulated wetlands?  
\* project will be under subaqueous lands and wetlands (HDD).

If the project is on private subaqueous lands, provide the name of the subaqueous lands owner:  
Lewes and Rehoboth Canal property of United States of America  
(Written permission from the private subaqueous lands owner must be included with this application)

13. Present Zoning:  Agricultural  Residential  Commercial  Industrial  Other

Section 4: Miscellaneous

14. A. List the names and complete mailing addresses of the immediately adjoining property owners on all sides of the project (attach additional sheets as necessary):  
See attached sheets

B. For wetlands and marina projects, list the names and complete mailing addresses of property owners within a 1,000 foot radius of the project (attach additional sheets as necessary):  
n/a

15. Provide the names of DNREC and/or Army Corps of Engineers representatives whom you have discussed the project with:  
Applicant's agent discussed proposed project with Matthew Jones, DNREC W&WS.

A. Have you had a State Jurisdictional Determination performed on the property?  Yes  No  
B. Has the project been reviewed in a monthly Joint Permit Processing Meeting?  Yes  No  
\*If yes, what was the date of the meeting? \_\_\_\_\_

16. Are there existing structures or fill at the project site in subaqueous lands?  Yes  No  
\*If yes, provide the permit and/or lease number(s):  
None

\*If no, were structures and/or fill in place prior to 1969?  Yes  No

17. Have you applied for or obtained a Federal permit from the Army Corps of Engineers? -  
 No  Pending  Issued  Denied Date: to be submitted

Type of Permit: NWP#58 (Utility line activities for water) Federal Permit or ID #: not yet available

18. Have you applied for permits from other Sections within DNREC?  
 No  Pending  Issued  Denied Date: \_\_\_\_\_ Permit or ID #: \_\_\_\_\_

Type of permit (circle all that apply):  Septic  Well  NPDES  Storm Water

Other: \_\_\_\_\_

**Section 4: Miscellaneous**

14. A. List the names and complete mailing addresses of the immediately adjoining property owners on all sides of the project. (See attached map).

<u>Tax Map Parcel #</u>	<u>Name, address of owner</u>
#335-8.00-55.00	Robert J. Kennedy, III, Trustee, and Janet Kennedy, 123 Henlopen Shores Circle, Lewes DE 19958
#335-9.00-22.00	Comm. Of Lewes, PO Box 518, Lewes DE 19958
#335-8.15-39.00 (Former railroad parcel)	State of Delaware, PO Box 778, Dover, DE 19903
#335-8.08-1.01	Comm. Of Lewes, PO Box 518, Lewes DE 19958
#335-8.08-150.00 (L&R Canal)	United States of America, PO Box 518, Lewes, DE 19958

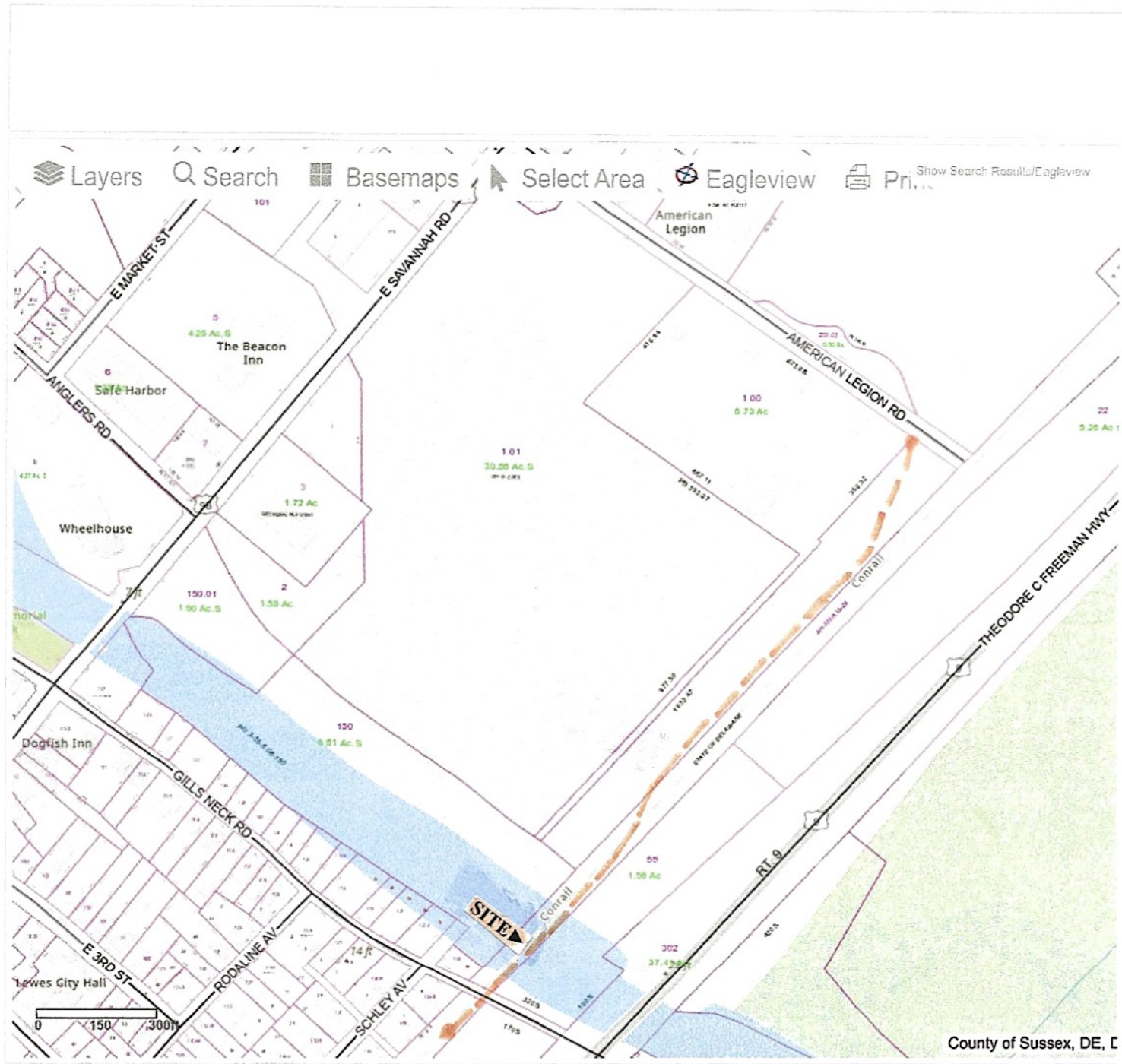

**Section 5: Signature Page****19. Agent Authorization:**

If you choose to complete this section, all future correspondence to the Department may be signed by the duly authorized agent. In addition, the agent will become the primary point of contact for all correspondence from the Department.

I do not wish to authorize an agent to act on my behalf

I wish to authorize an agent as indicated below

I, Austin Calaman, Gen. Mgr hereby designate and authorize Evelyn Maurmeyer, CER, Inc.  
 (Name of Applicant) Lewes, BPW (Name of Agent)  
 to act on my behalf in the processing of this application and to furnish any additional information requested by the Department.

Authorized Agent's Name: Evelyn Maurmeyer Telephone #: (302) 645-9610  
 Mailing Address: CER, Inc. Fax #: (302) 645-4332  
PO Box 674 E-mail: maurmeye@udel.edu  
Lewes DE 19958

**20. Agent's Signature:**

I hereby certify that the information on this form and on the attached plans are true and accurate to the best of my knowledge. I further understand that the Department may request information in addition to that set forth herein if deemed necessary to appropriately consider this application.

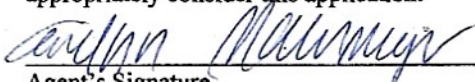
  
 Agent's Signature

1/16/2024  
 Date

**21. Applicant's Signature:**

I hereby certify that the information on this form and on the attached plans are true and accurate to the best of my knowledge and that I am required to inform the Department of any changes or updates to the information provided in this application. I further understand that the Department may request information in addition to that set forth herein if deemed necessary to appropriately consider this application. I grant permission to authorized Department representatives to enter upon the premises for inspection purposes during working hours.

  
 Applicant's Signature

1/11/24  
 Date

Austin Calaman  
 Print Name

**22. Contractor's Signature:**

I hereby certify that the information on this form and on the attached plans are true and accurate to the best of my knowledge, and that I am required to inform the Department of any changes or updates to the information provided in this application. I further understand that the Department may request information in addition to that set forth herein if deemed necessary to appropriately consider this application.

Not yet selected  
 Contractor's Name

\_\_\_\_\_  
 Date

\_\_\_\_\_  
 Print Name



**COASTAL & ESTUARINE RESEARCH, INC.**

Marine Studies Complex  
P.O. Box 674  
Lewes, Delaware 19958  
302-645-9610

January 2024

**PROJECT DESCRIPTION:  
UTILITY CROSSING (WATER MAIN)**

**Applicant**

Austin Calaman, General Manager  
Lewes Board of Public Works  
107 Franklin Avenue  
Lewes, DE 19958  
(302) 462-0049  
[acalaman@lewesbpwde.gov](mailto:acalaman@lewesbpwde.gov)

**Agent**

Evelyn Maurmeyer  
CER, Inc.  
PO Box 674  
Lewes, DE 19958  
(302) 645-9610  
[maurmeye@udel.edu](mailto:maurmeye@udel.edu)

**Project Architects/Engineers**

George, Miles & Buhr (GMB)

**Contractor**

Not yet selected.

**Project Location**

The proposed project is located in Lewes, Sussex County, Delaware, and will involve installation of 1,923 linear feet of 18" OD HDPE water main by underground Horizontal Directional Drill (HDD). The HDD entry point will be located off of Gills Neck Road (east of Schley Avenue), and will continue northward under the Lewes and Rehoboth Canal and under the adjacent wetlands to the exit point at American Legion Road, east of the Lewes Board of Public Works Howard Seymour Water Reclamation Plant. See Figures 1 and 2 for maps and directions; Figures 3a and 3b for aerial photographs showing location of project; and Figures 4a, 4b, and 4c for ground-level photographs. The project site is depicted on the USGS topographic map, Lewes, Delaware quadrangle (Figure 5), and will cross under the Lewes and Rehoboth Canal. The project site is depicted on State of Delaware DNREC wetland map #064, 1988 photobase (Figure 6). The HDD entry and exit points are mapped O (uplands or non-tidal wetlands less than 400 acres); the water main will pass below the Lewes and Rehoboth Canal (mapped W, water) and adjacent wetlands (mapped M, marsh). (Note: Water main installation will continue westward for another 1,500' via open trenching/backfilling in uplands along American Legion Road to E. Savannah Road, where the main will connect to an existing main. This section of the project is out of DNREC jurisdiction, therefore not included in this application.)

### **Project Description**

The proposed project is installation of 1,923 linear feet of 18" OD HDPE water main. The sequence of construction for the proposed project will be as follows:

1. Project entry point is located in uplands off of Gills Neck Road, east of Schley Avenue, south end of project site (see aerial photograph, Figure 3b, for location). Perimeter controls and temporary construction fencing will be installed at entrance point.
2. Perform Horizontal Directional Drilling (HDD), boring from entry point at southern end of project.
3. Pull water main pipe (18" OD HDPE) northward, under Lewes and Rehoboth Canal and adjacent wetlands to exit point, uplands at American Legion Road (see aerial photograph, Figure 3a, for location). Total distance = 1,923 linear feet.
4. Install water main by open cut trenching in uplands (out of DNREC WWS jurisdiction) along American Legion Road to E. Savannah Road; backfill.
5. Connect new water main to existing mains at Gills Neck Road, and E. Savannah Road.

### **Project Purpose**

There are currently only two (2) water mains crossing the Lewes and Rehoboth Canal from the south that provide water to the Lewes Beach area. A third water main, located on the bottom of the Canal in the vicinity of the proposed project, was damaged during removal of the railroad swing bridge across the Canal. Two temporary repairs were conducted, but failed. The third water main is necessary to serve the high demand for water use at Lewes Beach (north of the Lewes and Rehoboth Canal) in the summer months, as well as sufficient water flow for fire emergencies. It is requested that approval for the proposed project be expedited to insure that adequate water is provided.

### Utility Crossings

Please respond to each question. Questions left blank may result in the application being returned as incomplete. In addition, the answers to all of the questions in this Appendix must correspond accurately to the information on the plan and section view drawings for the project.

1. Please indicate the total number of subaqueous lands crossings associated with the project here:  
One (1) Complete a separate Appendix E for each crossing.
2. The information below is for Crossing # 1.

#### General Information

3. What type of utility is being installed and what is its diameter?  

<input type="checkbox"/> wastewater pipeline	<input type="checkbox"/> inches	<input type="checkbox"/> electric line	<input type="checkbox"/> inches
<input checked="" type="checkbox"/> water line	<u>18</u> inches (OD)	<input type="checkbox"/> TV/cable	<input type="checkbox"/> inches
<input type="checkbox"/> gas line	<input type="checkbox"/> inches	<input type="checkbox"/> fiber optic cable	<input type="checkbox"/> inches
<input type="checkbox"/> other (describe)	_____		<input type="checkbox"/> inches
4. What is the total length of the crossing relative to:  
MHW 265± ft. MLW 205± ft. OHW n/a ft.
5. What is the total area of impact for the crossing relative to:  
No impacts, crossing will be 25-35' below Lewes and Rehoboth Canal bottom.  
MHW 0 sq. ft. MLW 0 sqft. OHW n/a sq. ft.
6. What is the method of installation for the crossing:  
 underground  
 directional bore  trench  blasting  plow  
(HDD)  
If another method of installation will be utilized, please describe here:
7. Briefly outline the construction sequence for placement of the structure:  
See attached sheet.
8. Will dredging, excavating, or filling be required?  Yes  No  
If "yes", complete the appropriate dredging appendix and/or fill appendix and include them with your application.



**7. Briefly outline the construction sequence for placement of the structure.**

Installation of 1,923 linear feet of 18" OD HDPE water main will be conducted as follows:

1. Project entry point is located in uplands off of Gills Neck Road, east of Schley Avenue, south end of project site (see aerial photograph, Figure 3b, for location). Perimeter controls and temporary construction fencing will be installed at entrance point.
2. Perform Horizontal Directional Drilling (HDD), boring from entry point at southern end of project.
3. Pull water main pipe (18" OD HDPE) northward, under Lewes and Rehoboth Canal and adjacent wetlands to exit point, uplands at American Legion Road (see aerial photograph, Figure 3a, for location). Total distance = 1,923 linear feet.
4. Install water main by open cut trenching in uplands (out of DNREC WWS jurisdiction) along American Legion Road to E. Savannah Road; backfill.
5. Connect new water main to existing mains at Gills Neck Road, and E. Savannah Road.

9. Will there be any permanent towers, poles, platforms or other structures (excluding submarine cables) on subaqueous land or in wetlands?  Yes  No

If "yes", give the number of structures, and provide a description, including square footage and material (the location of all structures must be shown on the plans or the application cannot be processed).

10. At what depth will the subaqueous crossing be placed below the bottom of the waterbody? 25-35 ft. \*  
At what height will an aerial crossing be above MHW? n/a feet

\* see Figure 8b for cross-section

11. Is the crossing in, on, over or under public (undeeded) or private subaqueous lands?

Public  Private

If private, who is/are the property holder(s)? United States of America

Provide a copy of any deed, ROW or easement granting access if the private property owner is other than the applicant.

12. Is the crossing adjacent to subaqueous lands on State-owned property?  Yes  No

If so, which State agency is the owner? DeLDOT

Is the crossing within a DeLDOT right of way?  Yes  No

13. Please include evidence of written permission from the private land owner above (if other than the applicant).

Email approval from Richard Sinegar, DeLDOT, attached.

## Vincent A. Luciani

---

**From:** Sinegar, Richard (DeIDOT) <Richard.Sinegar@delaware.gov>  
**Sent:** Friday, August 4, 2023 2:07 PM  
**To:** Benjamin K. Hearn; Aglio, Anthony (DeIDOT); drathfon@kleinfelder.com; jhermes@kleinfelder.com; bconway@kleinfelder.com; bkisner@kleinfelder.com; Cimo, Eric (DeIDOT); Neidert, Scott (DeIDOT); Xu, Lei (DeIDOT)  
**Cc:** Vincent A. Luciani; Charles M. O'Donnell; Joshua Gritton; Ann Marie Townshend; Niezgod, Jeff (DeIDOT)  
**Subject:** RE: Lewes - Rehoboth Canal Watermain Crossing - DeIDOT Railroad ROW permitting  
**Attachments:** DeIDOT P\_W Application 8Jun21.pdf  
**Categories:** Filed by Mail Manager

Ben – DeIDOT's Railroad Section has reviewed the information provided and has agreed to allow LBPW to use the State Property for the installation of a watermain under the Lewes and Rehoboth Canal. I have attached the application that will need to be filled out and in the future a pipe crossing agreement will need to be executed. Note that all other permits and easements will need to be acquired prior to any work being allowed on state property. In addition, you will need to contact DeIDOT's Planning Section (Jeff Niezgod) and the City of Lewes (Ann Marie Townshend) to determine what will be required for relocating the trail and its associated impacts. Please keep us posted on the continuing progress and proposed schedule for this work.

Rich Sinegar  
Railroad Coordinator  
Delaware Dept. of Transportation  
P.O. Box 778, 800 S Bay Road  
Dover, DE 19903  
302-670-5545 (C)  
302-760-4882 (P)  
[richard.sinegar@delaware.gov](mailto:richard.sinegar@delaware.gov)

**From:** Benjamin K. Hearn <BHearn@gmbnet.com>  
**Sent:** Friday, July 21, 2023 3:24 PM  
**To:** Sinegar, Richard (DeIDOT) <Richard.Sinegar@delaware.gov>; Aglio, Anthony (DeIDOT) <Anthony.Aglia@delaware.gov>; drathfon@kleinfelder.com; jhermes@kleinfelder.com; bconway@kleinfelder.com; bkisner@kleinfelder.com; Cimo, Eric (DeIDOT) <Eric.Cimo@delaware.gov>; Neidert, Scott (DeIDOT) <Scott.Neidert@delaware.gov>; Xu, Lei (DeIDOT) <Lei.Xu@delaware.gov>  
**Cc:** Vincent A. Luciani <VLuciani@gmbnet.com>; Charles M. O'Donnell <codonnell@gmbnet.com>; Joshua Gritton <ACalaman@LewesBPW.com>; Ann Marie Townshend <atownshend@ci.lewes.de.us>  
**Subject:** RE: Lewes - Rehoboth Canal Watermain Crossing - DeIDOT Railroad ROW permitting

Rich,

Attached is an exhibit showing the proposed drilling area as it relates to Schley Avenue as well as document noting the various options considered and noted issues with those options.

Please let me know if you have any questions or concerns.

Thanks  
Ben

#### Schley Avenue:

- Schley Avenue, immediately adjacent to Gills Neck Road was removed from consideration due to the impacts of closing down a significant section of the roadway for 2-3 months of drilling would have. Discussion with drilling contractors produced a required drilling area to be 50' x 200' to accommodate all the equipment, which includes a mud recycler, needed for the long drill. The existing Schley Avenue ROW is approximately 40' wide and has electric poles on one side of the ROW, which would mean that the drilling area could not be centered on the roadway and would be offset and encroach approximately 10-15 feet into the property owner's yards for the duration, which includes dealing with trees and existing landscaping. Additionally, there are existing underground electrical lines crossing the canal, which are on an unknown path, which creates risk to the BPW and drilling contractor, which could be avoided. The locations of the existing underground electrical lines and the existing water mains within Schley Avenue do not provide separation that the HDD contractors are comfortable with.

#### Schley Avenue / Franklin Ave back by BPW Yard:

- Shifting the drill back by the BPW Yard / Parking lot would be a method to reduce the impacts to the public, however this additional length of main ~900 feet and the additional cost associated with it ~\$450,000, could be better spent elsewhere in the system and why we eliminated this option, when better options were present. The addition of this pipe provided no additional benefits hydraulically to the water distribution system. Additionally, there are existing underground electrical lines crossing the canal, that are on an unknown path, which creates risk to the BPW and drilling contractor, which could be avoided.

#### Drilling from American Legion Road to Schley:

- While this is a viable option, the work would either need to be completed from within the wetlands or block the bike/walking trail connection to American Legion Road. The bending radii would not work to be setup to drill from within American Legion Road and be able to get to Schley Ave. To drill from the wetlands would most likely require an area larger than 50'x200' to allow for staging of materials, travel to the drill area, etc. Due to the desire not to impact the bike/walking trail for a 2-3 month duration, as well as the desire not to construct within the wetlands, this option was not further considered. Additionally, there would be an exit pit for the drill on Schley which would necessitate road closure for a period of time, as well as the need for space to lay down the pipe and weld it together. Finally, there is an existing electrical crossing of the canal, that is on an unknown path, where very precise drilling would be needed. This creates excessive risk to the BPW and drilling contractor, which could be avoided.

#### Drilling from American Legion Road to Kennedy property:

- This is a viable option but requires crossing the State of Delaware lands at a non-perpendicular angle, the ability to do this is unknown at this point. There may be impacts to the trail with drilling from American Legion Road as the bending radii of the drilling equipment may necessitate impacting the trail as well as wetlands. With better options present, this was not further considered.

Tax Parcel No.: 335-8.08-1.00

Prepared By and Return To:  
Michael J. Hoffman, Esquire  
Tarabicos, Grosso & Hoffman, LLP  
One Corporate Commons  
100 W. Commons Blvd., Suite 415  
New Castle, DE 19720

**No Title Search Requested**  
**No Title Search Performed**

**DEED**

**THIS DEED**, made this 3<sup>rd</sup> day of November, 2023,

**BETWEEN, THE CITY OF LEWES**, a municipal corporation of the State of Delaware, for the benefit of its **BOARD OF PUBLIC WORKS**, a chartered utilities board of the State of Delaware, party of the first part,

**A N D**

**THE CITY OF LEWES**, a municipal corporation of the State of Delaware, jointly with **THE BOARD OF PUBLIC WORKS OF THE CITY OF LEWES**, a chartered utilities board of the State of Delaware, parties of the second part,

**WITNESSETH**, that the said party of the first part, for and in consideration of the sum of Ten and 00/100 Dollars (\$10.00) lawful money of the United States of America, the receipt whereof is hereby acknowledged, hereby grants and conveys unto the parties of the second part, their successors or assigns, in fee, in:

**ALL THAT CERTAIN** Wastewater Treatment Facility Subdivided Lot, as more particularly bounded and described by courses and distances on Exhibit 1 appended hereto, prepared by George, Miles & Buhr, LLC, land surveyors and planners, lying and being situate in the City of Lewes, Lewes and Rehoboth Hundred, Sussex County, State of Delaware, in accordance with a plot of lands known and identified as American Legion Road Subdivision Plan, prepared by George, Miles & Buhr, LLC, dated February 2023, and recorded in the Office of the Recorder of Deeds of Sussex County, Delaware, in Plot Book 393, Page 27 (the "Plan").

**TOGETHER WITH** the outfall easement as shown on the Plan.

**TOGETHER WITH AND SUBJECT TO** all covenants, conditions, restrictions, plans, and easements of record with respect to the property described above, this reference to which shall not be construed to reimpose any such covenants, conditions, restrictions, plans and

easements which have otherwise lapsed, expired or have been terminated in accordance with their terms or otherwise, as applicable.

Grantee's address:

City of Lewes  
114 E. Third Street  
P.O. Box 227  
Lewes, DE 19958

The Board of Public Works of the City of Lewes  
107 Franklin Avenue  
Lewes, DE 19958

*[Signature Page Follows]*



SCHEDULE TO SUSSEX COUNTY TRANSFER TAX AFFIDAVIT  
GRANTEES/BUYERS

THE BOARD OF PUBLIC WORKS OF THE  
CITY OF LEWES  
107 Franklin Street  
Lewes, DE 19958  
EIN: 51-0004670

  
Buyer's Signature

Sworn and subscribed before me on this 3<sup>rd</sup> day of November, 2023.

  
Notary Public

SHARON CLARINDA SEXTON  
Notary Public  
State of Delaware  
My Commission Expires On  
June 14, 2025

THE CITY OF LEWES  
114 E. Third Street  
P.O. Box 430  
Georgetown, DE 19947  
EIN: 51-6000162

  
Buyer's Signature

Sworn and subscribed before me on this 3<sup>rd</sup> day of November, 2023.

  
Notary Public

ELLEN LORRAINE McCABE  
NOTARY PUBLIC  
STATE OF DELAWARE  
My Commission Expires April 20, 2024



**Exhibit 1**

**Wastewater Treatment Facility Subdivision Plan  
“American Legion Road Subdivision Plan”**

**BEGINNING** at a point on the right-of-way line of American Legion Road and the North Easterly property corner of the proposed lot, the following courses and distances:

1. Thence running in a Southwesterly direction along the proposed lot line South 42 degrees 44 minutes 34 seconds West, 350.32 feet to a point,
2. Thence turning and running South 47 degrees 03 minutes 16 seconds East, 11.67 feet to a point,
3. Thence turning and running South 42 degrees 56 minutes 44 seconds West, 1,032.47 feet to a point,
4. Thence turning and running North 58 degrees 18 minutes 36 seconds West, 20.39 feet to a point,
5. Thence turning and running North 42 degrees 56 minutes 44 seconds East, 977.50 feet to a point,
6. Thence turning and running North 55 degrees 52 minutes 46 seconds West, 667.11 feet to a point,
7. Thence turning and running North 43 degrees 03 minutes 21 seconds East, 410.94 feet to a point along the right-of-way of American Legion Road.
8. Thence turning and running South 55 degrees 39 minutes 25 seconds East, 673.08 feet to the point of Beginning.

Containing an area of 293,174 square feet, or 6.73 acres, more or less. Being the same land shown on a drawing prepared by George, Miles & Buhr, LLC entitled “Wastewater Treatment Facility Subdivision Plan” dated January 2023.

