



STATE OF DELAWARE

**DEPARTMENT OF NATURAL RESOURCES AND
ENVIRONMENTAL CONTROL**

DIVISION OF WATER

RICHARDSON & ROBBINS BUILDING

89 KINGS HIGHWAY

DOVER, DELAWARE 19901

Residential Services
Section

Phone
(302) 739-9947

November 18, 2025

Jason Resendez
Regional Sales
Champion Pump
1102 Myers Parkway
Ashland, Ohio 448055

RE: Champion Pump

Dear Mr. Resendez,

The Division of Water has received your request for product approval for Champion Pumps models: CPE, CPES, CPEW, CPG, CPS3, CPSE, CPSEV, CPSTEP, and CPW. DNREC is pleased to inform you that, after review and approval by third-party vendor Davis, Bowen & Friedel Inc., the following pumps have met the State's standards and are approved for use in pumped dosing applications for On-site Wastewater Treatment and Disposal Systems: CPE, CPES, CPEW, CPSE, CPSTEP, and CPW.

Additionally, DNREC is happy to announce that, as reviewed and approved by third-party vendor Davis, Bowen & Friedel Inc., the grinder pump model CPG meets the State's standards and is suitable for use in grinder pump applications associated with lift stations for larger On-site Wastewater Treatment and Disposal Systems.

Please note that the installation of the approved Champion pumps must be carried out in accordance with the manufacturer's guidelines, the designer's proposed components, and the specified permit conditions. As a condition of this approval, no substitutions are permitted.

If you have any questions, please contact the Department at 302-739-9947.

Sincerely,

A handwritten signature in cursive script that reads "James Powell".

James Powell
Program Manager I, Residential Services Section
Division of Water

*Ring W. Lardner, P.E.
W. Zachary Crouch, P.E.
Michael E. Wheedleton, AIA, LEED GA
Jason P. Loar, P.E.
Jamie L. Sechler, P.E.*

November 3, 2025

State of Delaware
Department of Natural Resources & Environmental Control
Division of Water
89 Kings Highway
Dover, DE 19901

Attn: Mr. Matthew T. Grabowski
Environmental Administrator

RE: Engineering & Technical Support
Product Approval Review
Manufacturer: Champion Pump Company
DBF #1945F001.B01

Dear Mr. Grabowski:

Davis, Bowen & Friedel, Inc., received submittals of products manufactured by Champion Pump Company for review. The following items were included in this review:

- Pump Model CPE
- Pump Model CPES
- Pump Model CPEW
- Pump Model CPG
- Pump Model CPS3
- Pump Model CPSE
- Pump Model CPSEV
- Pump Model CPSTEP
- Pump Model CPW

We find that the following submittals meet the expectations of the State and are suitable for use in pumped dosing applications for onsite wastewater treatment and disposal systems: Pump Models CPE, CPES, CPEW, CPSE, CPSTEP & CPW.

We find that the following submittals meet the expectations of the State are suitable for use in grinder pump applications associated with lift station for larger onsite wastewater treatment and disposal systems: Pump Model CPG.

Mr. Matthew T. Grabowski
November 3, 2025
Page 2

We find that the following submittals do NOT meet the expectations of State and are NOT suitable for use for onsite wastewater treatment and disposal systems: Pump Models CPSEV and CPS3.

Should you have any questions, comments, or would like to discuss this further please give me a call at your convenience.

Sincerely,
DAVIS, BOWEN & FRIEDEL, INC.

A handwritten signature in blue ink, consisting of a large, stylized 'S' followed by a horizontal line that curves upwards to the right.

Sharon K. Cruz, P.E., AICP
Associate

Every pump tested in water to ensure pump meets performance curve.



FEATURES/BENEFITS

PERFORMANCE

- Heads up to 65' TDH
- Flows up to 86 GPM

MOTOR

- High efficient, 115v or 230v, oil filled, permanent split capacitor motor with upper and lower ball bearings and thermal overload protection
- Constant bearing lubrication
- Maximum motor cooling
- Runs cooler and lasts longer
- Internal overload protection
- Quiet operation
- Fasteners and shaft made from rugged, corrosion resistant stainless steel

SEAL DESIGN

- Type 21 inboard seal design with secondary exclusion seal
- Rotating components of seal are in the motor housing, being lubricated by the motor oil preventing foreign matter from wrapping around the seal components
- Seal will last longer if the pump runs dry
- Secondary exclusion seal keeps debris from entering the seal cavity

IMPELLER DESIGN

- Non-clog style, cast-iron vortex impeller (CPEH Thermoplastic Vortex)
- Designed to help reduce clogging by foreign material

POWER CORD

- Sealed entry quick disconnect power cords
- Prevents water from entering the motor housing through a cut cord
- Easy to replace in the field
- Available in lengths up to 100'

SWITCH

- Piggy-back switch design
- Defective switches can be diagnosed over the phone
- Pump can be operated manually or supplied with other piggy-back switches
- Switch can be replaced without having to replace the pump

APPLICATIONS

Dewatering, septic systems, residential and commercial developments, elevator pits and STEP systems



Vertical Float

Wide-Angle Float

4/10-1/2 HP submersible pumps that handle up to 3/4" solids with 2" discharge

PERFORMANCE CURVE

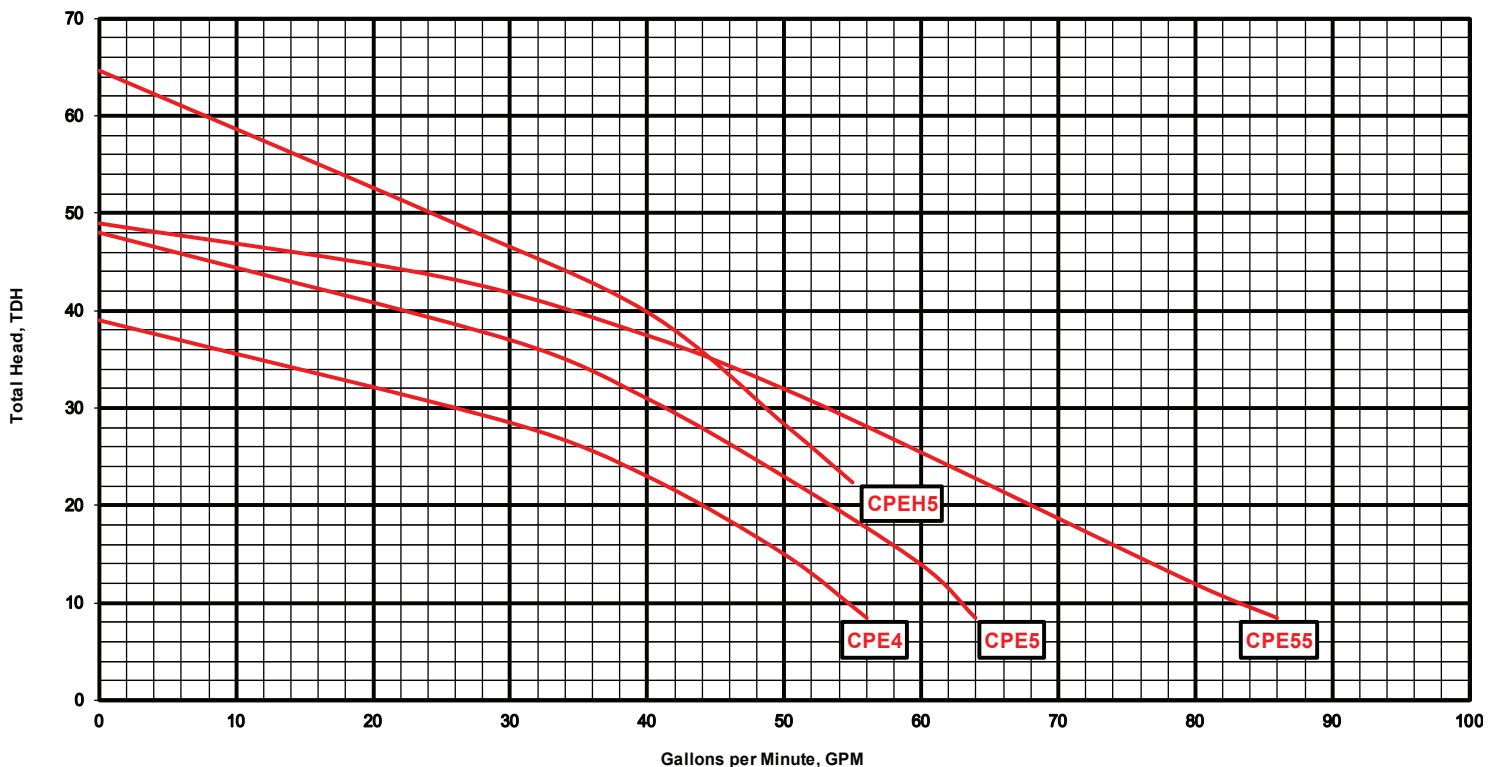

TECHNICAL DATA

DISCHARGE	2" NPT. vertical standard
LIQUID TEMPERATURE	140 Degrees F. (Intermittent)
MOTOR HOUSING	Cast Iron
VOLUTE	Cast Iron
SEAL PLATE	Cast Iron
IMPELLER	Cast Iron / Vortex (CPEH thermoplastic vortex)
SOLIDS HANDLING	3/4"
SHAFT	Stainless Steel
SHAFT SEAL (SINGLE SEAL)	Inboard mechanical with secondary exclusion V-Seal, carbon rotating face, ceramic stationary face, Buna-N elastomer, 300 series stainless steel hardware
BEARINGS (UPPER & LOWER)	Single row, ball, oil lubricated
HARDWARE	300 Series stainless steel
O-RINGS	Buna-N
CORD	20' Length standard. Up to 100' available. (UL/CUL) Listed 16 AWG, Type SJTW
MOTOR (SINGLE PHASE)	4/10-1/2 HP 3450 RPM, 60 Hz, NEMA L Includes Overload Protection in the motor, oil filled, class B permanent split capacitor
WEIGHT	37 lbs. (Manual)

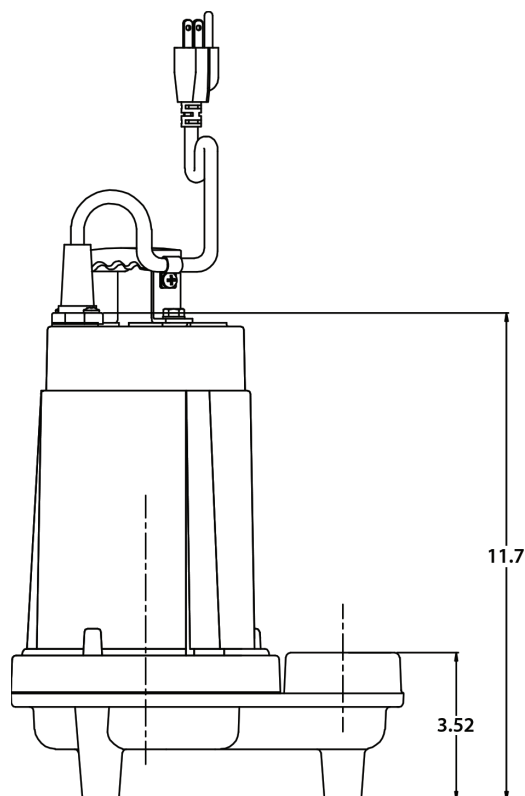
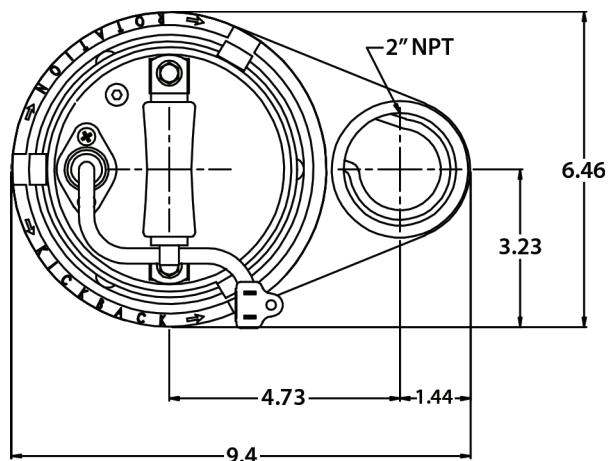

MODEL(S) INFORMATION

MODEL	HP	VOLTS	PHASE	AMPS	CORD LENGTH	SWITCH
CPE4-12 / CPE5-12 / CPE55-12 / CPEH5-12	4/10 - 1/2	115	1	6.6 / 8.5 / 10.5 / 11.5	20'	Manual
CPE4-13 / CPE5-13 / CPE55-13 / CPEH5-13	4/10 - 1/2	115	1	6.6 / 8.5 / 10.5 / 11.5	30'	Manual
CPE4-15 / CPE5-15 / CPE55-15 / CPEH5-15	4/10 - 1/2	115	1	6.6 / 8.5 / 10.5 / 11.5	50'	Manual
CPE4A-12 / CPE5A-12 / CPE55A-12 / CPEH5A-12	4/10 - 1/2	115	1	6.6 / 8.5 / 10.5 / 11.5	20'	Wide-Angle Float
CPE4A-13 / CPE5A-13 / CPE55A-13 / CPEH5A-13	4/10 - 1/2	115	1	6.6 / 8.5 / 10.5 / 11.5	30'	Wide-Angle Float
CPE4V-12 / CPE5V-12 / CPE55V-12 / CPEH5V-12	4/10 - 1/2	115	1	6.6 / 8.5 / 10.5 / 11.5	20'	Vertical Float
CPE4V-13 / CPE5V-13 / CPE55V-13 / CPEH5V-13	4/10 - 1/2	115	1	6.6 / 8.5 / 10.5 / 11.5	30'	Vertical Float
CPE4-22 / CPE5-22 / CPE55-22 / CPEH5-22	4/10 - 1/2	230	1	3.3 / 4.3 / 5.75 / 5.75	20'	Manual
CPE4A-22 / CPE5A-22 / CPE55A-22 / CPEH5A-22	4/10 - 1/2	230	1	3.3 / 4.3 / 5.75 / 5.75	20'	Wide-Angle Float
CPE4V-22 / CPE5V-22 / CPE55V-22 / CPEH5V-22	4/10 - 1/2	230	1	3.3 / 4.3 / 5.75 / 5.75	20'	Vertical Float

Every pump tested in water to ensure pump meets performance curve.



FEATURES/BENEFITS

PERFORMANCE

Heads up to 37' TDH
Flows up to 72 GPM

MOTOR

High efficient, 115v, oil filled, permanent split capacitor motor with upper and lower ball bearings and thermal overload protection

- Constant bearing lubrication
- Maximum motor cooling
- Runs cooler and lasts longer
- Internal overload protection
- Quiet operation
- Fasteners and shaft made from rugged, corrosion resistant stainless steel

SEAL DESIGN

Mechanical with secondary dynamic lip seal

- Provides added leakage protection

IMPELLER DESIGN

Non-clog style vortex impeller

- Designed to help reduce clogging by foreign material

POWER CORD

Sealed entry quick disconnect power cords

- Prevents water from entering the motor housing through a cut cord
- Easy to replace in the field
- Available in lengths up to 100'

SWITCH

Piggy-back switch design

- Defective switches can be diagnosed over the phone
- Pump can be operated manually or supplied with other piggy-back switches
- Switch can be replaced without having to replace the pump

APPLICATIONS

Basements, dewatering, septic systems, residential and commercial developments and elevator pits



Wide-Angle Float



Vertical Float

1/3-1/2 HP submersible pumps that handle up to 3/4" solids with 2" discharge with 1 1/2" adapter

PERFORMANCE CURVE

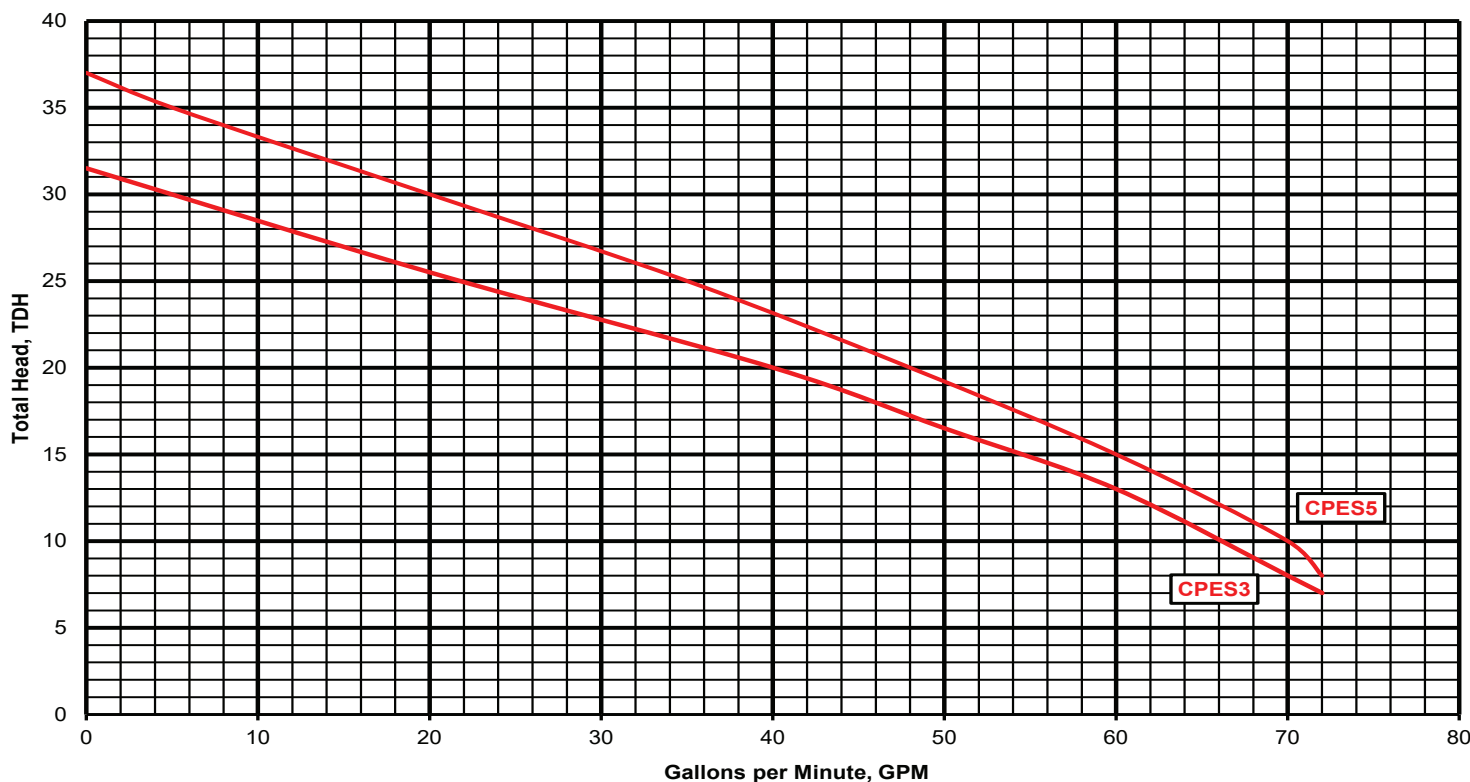

TECHNICAL DATA

DISCHARGE	2" NPT. with 1-1/2" adapter included
SOLIDS HANDLING	3/4"
LIQUID TEMPERATURE	140 Degrees F. (Intermittent)
MOTOR HOUSING	Cast Iron
VOLUTE	Engineered glass filled thermoplastic
SEAL PLATE	Cast Iron
IMPELLER	Engineered glass filled thermoplastic/ Vortex
SHAFT	Stainless Steel
SHAFT SEAL (SINGLE SEAL)	Mechanical with secondary dynamic lip seal, carbon rotating face, ceramic stationary face, Buna-N elastomer, 300 series stainless steel hardware
BEARINGS (UPPER & LOWER)	Single row, ball, oil lubricated
HARDWARE	300 Series stainless steel
O-RINGS	Buna-N
CORD	10' Length standard. Up to 100' available. (UL/CUL) Listed 16 AWG, Type SJTW
MOTOR (SINGLE PHASE)	1/3-1/2 HP 3450 RPM, 60 Hz, NEMA L Includes overload protection in the motor, oil filled, class B permanent split capacitor
WEIGHT	25 lbs. (Manual)

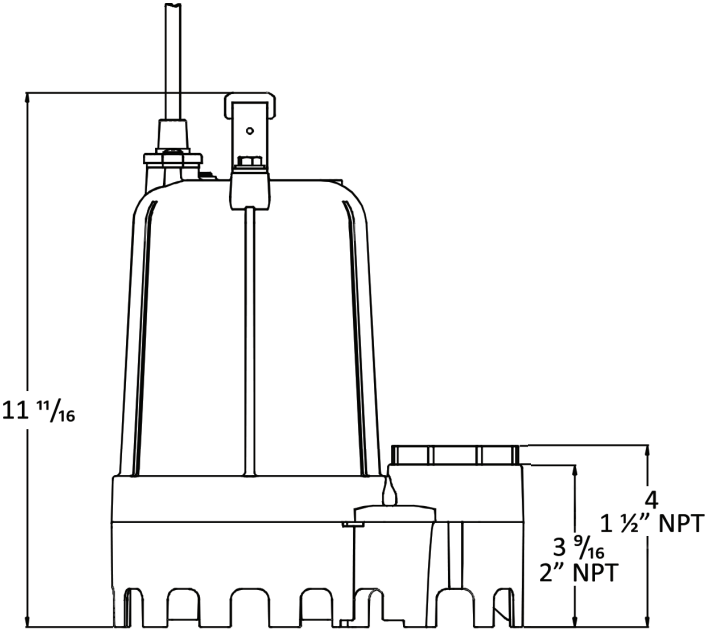
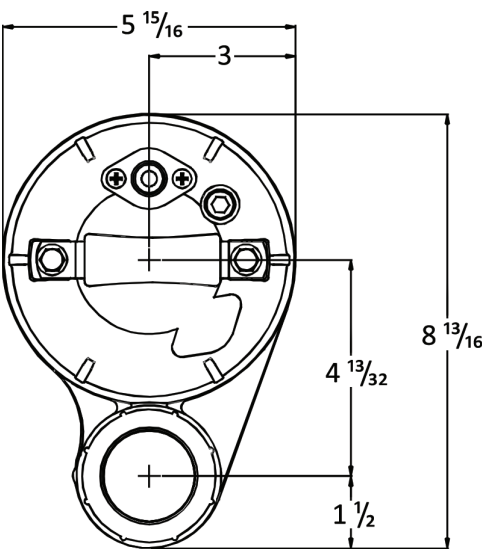

MODEL	HP	VOLTS	PHASE	AMPS	CORD LENGTH	SWITCH
CPES3-11 / CPES5-11	1/3-1/2	115	1	7.9 / 8.9	10'	Manual
CPES3-12 / CPES5-12	1/3-1/2	115	1	7.9 / 8.9	20'	Manual
CPES3-13 / CPES5-13	1/3-1/2	115	1	7.9 / 8.9	30'	Manual
CPES3-15 / CPES5-15	1/3-1/2	115	1	7.9 / 8.9	50'	Manual
CPES3A-11 / CPES5A-11	1/3-1/2	115	1	7.9 / 8.9	10'	Wide-Angle Float
CPES3A-12 / CPES5A-12	1/3-1/2	115	1	7.9 / 8.9	20'	Wide-Angle Float
CPES3A-13 / CPES5A-13	1/3-1/2	115	1	7.9 / 8.9	30'	Wide-Angle Float
CPES3V-11 / CPES5V-11	1/3-1/2	115	1	7.9 / 8.9	10'	Vertical Float
CPES3V-12 / CPES5V-12	1/3-1/2	115	1	7.9 / 8.9	20'	Vertical Float
CPES3V-13 / CPES5V-13	1/3-1/2	115	1	7.9 / 8.9	30'	Vertical Float

Every pump tested in water to ensure pump meets performance curve.



FEATURES/BENEFITS

PERFORMANCE

- Heads up to 23' TDH
- Flows up to 90 GPM

MOTOR

- High efficient, 115v, oil filled, permanent split capacitor motor with upper and lower ball bearings and thermal overload protection
- Constant bearing lubrication
- Maximum motor cooling
- Runs cooler and lasts longer
- Internal overload protection
- Quiet operation
- Fasteners and shaft made from rugged, corrosion resistant stainless steel

SEAL DESIGN

- Mechanical with secondary dynamic lip seal
- Provides added leakage protection

IMPELLER DESIGN

- Non-clog style vortex impeller
- Designed to help reduce clogging by foreign material

POWER CORD

- Sealed entry quick disconnect power cords
- Prevents water from entering the motor housing through a cut cord
- Easy to replace in the field
- Available in lengths up to 100'

SWITCH

- Piggy-back switch design
- Defective switches can be diagnosed over the phone
- Pump can be operated manually or supplied with other piggy-back switches
- Switch can be replaced without having to replace the pump

APPLICATIONS

Basements, dewatering, septic systems, sewage lift stations, add-a-baths and truck docks



Wide-Angle Float



Vertical Float

1/2 HP submersible pumps that handle up to 2" solids with 2" discharge

PERFORMANCE CURVE



TECHNICAL DATA

DISCHARGE	2" NPT. vertical standard
SOLIDS HANDLING	2"
LIQUID TEMPERATURE	140 Degrees F. (Intermittent)
MOTOR HOUSING	Cast Iron
VOLUTE	Engineered glass filled thermoplastic
SEAL PLATE	Cast Iron
IMPELLER	Engineered glass filled thermoplastic/ Vortex
SHAFT	Stainless Steel
SHAFT SEAL (SINGLE SEAL)	Mechanical with secondary dynamic lip seal, carbon rotating face, ceramic stationary face, Buna-N elastomer, 300 series stainless steel hardware
BEARINGS (UPPER & LOWER)	Single row, ball, oil lubricated
HARDWARE	300 Series stainless steel
O-RINGS	Buna-N
CORD	10' Length standard. Up to 100' available. (UL/CUL) Listed 16 AWG, Type SJTW
MOTOR (SINGLE PHASE)	1/2 HP 3450 RPM, 60 Hz, NEMA L Includes overload protection in the motor, oil filled, class B permanent split capacitor
WEIGHT	25 lbs. (Manual)

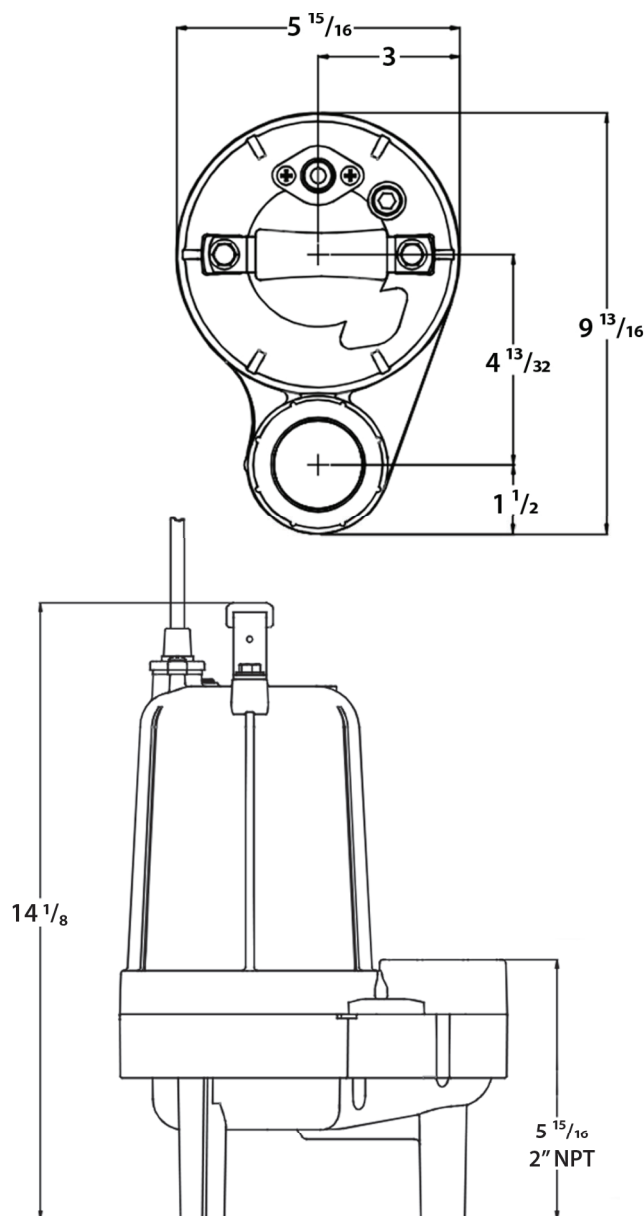

MODEL(S) INFORMATION

MODEL	HP	VOLTS	PHASE	AMPS	CORD LENGTH	SWITCH
CPEW5-11	1/2	115	1	9.5	10'	Manual
CPEW5-12	1/2	115	1	9.5	20'	Manual
CPEW5-13	1/2	115	1	9.5	30'	Manual
CPEW5-15	1/2	115	1	9.5	50'	Manual
CPEW5A-11	1/2	115	1	9.5	10'	Wide-Angle Float
CPEW5A-12	1/2	115	1	9.5	20'	Wide-Angle Float
CPEW5A-13	1/2	115	1	9.5	30'	Wide-Angle Float
CPEW5A-15	1/2	115	1	9.5	50'	Wide-Angle Float
CPEW5V-11	1/2	115	1	9.5	10'	Vertical Float
CPEW5V-12	1/2	115	1	9.5	20'	Vertical Float
CPEW5V-13	1/2	115	1	9.5	30'	Vertical Float
CPEW5V-15	1/2	115	1	9.5	50'	Vertical Float

Every pump tested in water to ensure pump meets performance curve.



FEATURES/BENEFITS

PERFORMANCE

Heads up to 80' TDH
Flows up to 222 GPM

MOTOR (Single Phase)

High efficient, 115v or 230v, oil filled, permanent split capacitor motor with upper and lower ball bearings and thermal overload protection

- Constant bearing lubrication
- Maximum motor cooling
- Runs cooler and lasts longer
- Internal overload protection
- Quiet operation

- Fasteners and shaft made from rugged, corrosion resistant stainless steel

MOTOR (3 Phase)

230v or 460v, requires control panel

SEAL DESIGN

Single, mechanical, oil filled chamber

- Optional double series models available that provides additional protection and optional moisture sensing capabilities
- Optional seal failure feature that will alert you when the seal has failed

IMPELLER DESIGN

2 vane, cast iron impeller

- Designed to help reduce clogging by foreign material

POWER CORD

Sealed entry quick disconnect power cords

- Prevents water from entering the motor housing through a cut cord
- Easy to replace in the field
- Available in lengths up to 100'

SWITCH

Piggy-back switch design (Single Phase)

- Defective switches can be diagnosed over the phone
- Pump can be operated manually or supplied with other piggy-back switches
- Switch can be replaced without having to replace the pump

APPLICATIONS

Residential developments, commercial developments and wastewater applications



1/2-2 HP cast iron sewage pumps that handle up to 2" solids with 2" or 3" discharge

PERFORMANCE CURVE

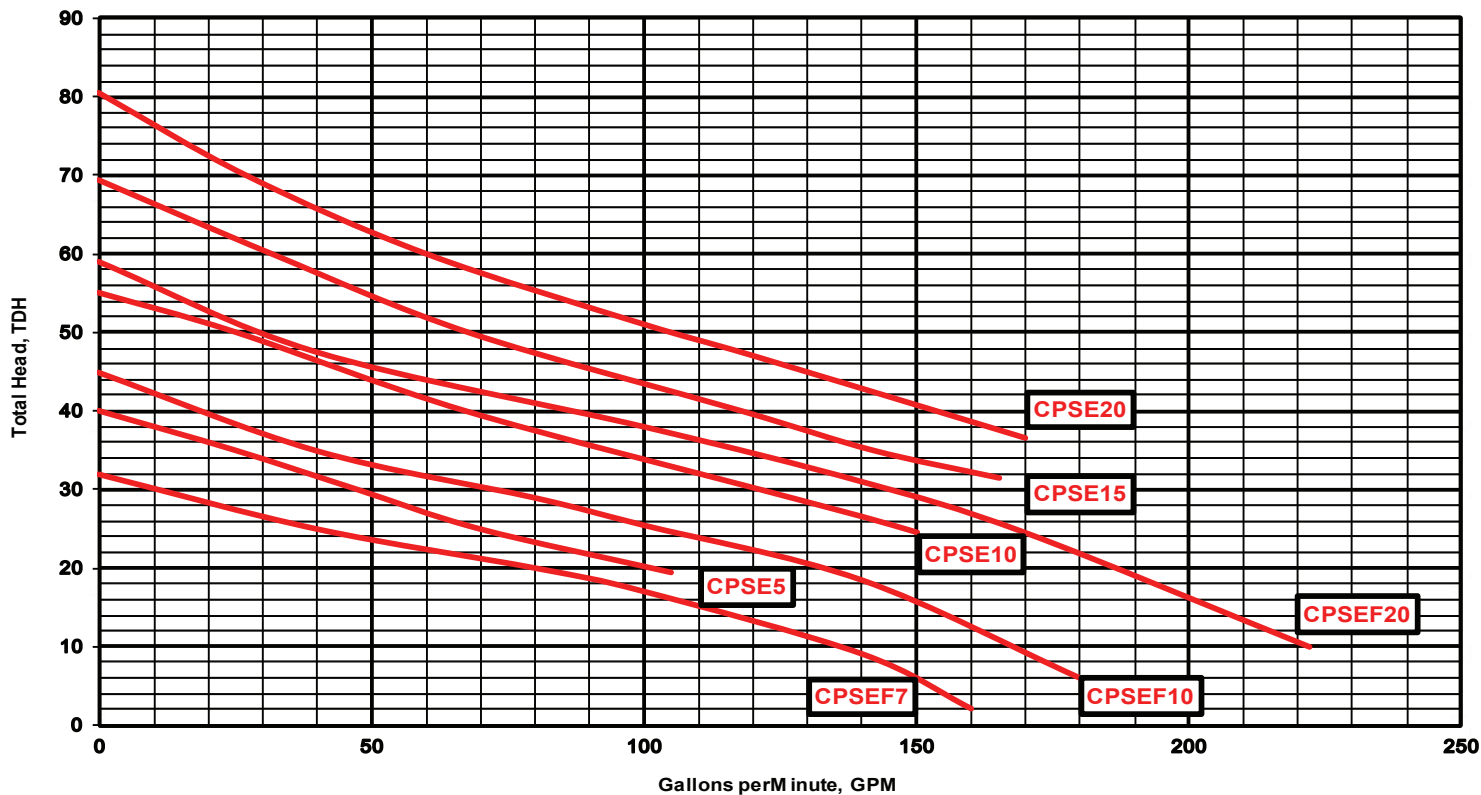

TECHNICAL DATA

DISCHARGE	2" NPT. vertical standard, 3" optional
SOLIDS HANDLING	2"
LIQUID TEMPERATURE	140 Degrees F. (Intermittent)
MOTOR HOUSING	Cast Iron
VOLUTE	Cast Iron
SEAL PLATE	Cast Iron
IMPELLER	Cast Iron / 2 Vane
SHAFT	Stainless Steel
SHAFT SEAL (SINGLE SEAL)	Single mechanical, carbon rotating face, ceramic stationary face, Buna-N elastomer, 300 series stainless steel hardware
SHAFT SEAL (DOUBLE SEAL)	Tandem double mechanical upper & lower, carbon ceramic, Buna-N elastomer, 300 stainless steel hardware
BEARINGS (UPPER & LOWER)	Single row, ball, oil lubricated
HARDWARE	300 Series stainless steel
O-RINGS	Buna-N
CORD	Quick disconnect 20' cord standard. Up to 30' with a plug and 100' available without a plug. 3 phase 30' cord standard. UL/CSA (SJOW) 14/3 (.375 OD) * UL/CSA (SO) Cord 14 Ga. (.60)
MOTOR (SINGLE PHASE)	1/2-2 HP 3450 RPM. 60 Hz, Includes Overload Protection in the Motor. Oil Filled, Class F Permanent Split Capacitor
MOTOR (THREE PHASE)	1/2-2 HP 3450 RPM. 60 Hz, oil filled, requires overload protection to be included in control panel
WEIGHT	80 lbs. (Manual)

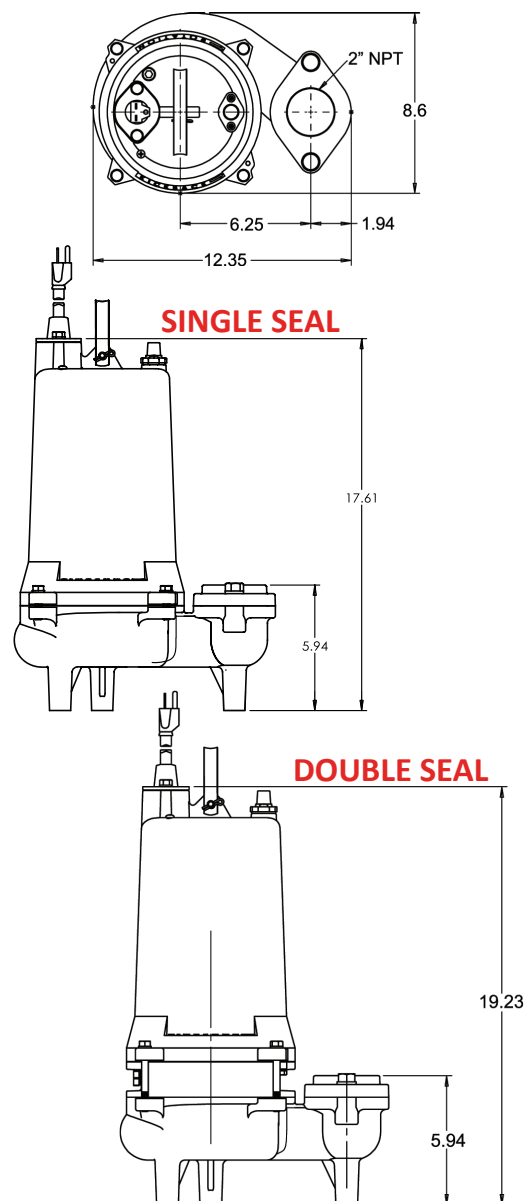

MODEL(S) INFORMATION

MODEL	HP	VOLTS	PHASE	AMPS	CORD LENGTH	SWITCH	REQUIRES PANEL
CPSE512(A)	1/2	115	1	14.5	20'	M (Wide-Angle Float)	No
CPSE522(A)	1/2	230	1	7.3	20'	M (Wide-Angle Float)	No
CPSE533	1/2	230	3	5.3	30'	Manual	Yes
*CPSE543	1/2	460	3	2.7	30'	Manual	Yes
CPSEF712(A)	3/4	115	1	12	20'	M (Wide-Angle Float)	No
CPSEF722(A)	3/4	230	1	6	20'	M (Wide-Angle Float)	No
CPSEF733	3/4	230	3	5	30'	Manual	Yes
*CPSEF743	3/4	460	3	2.5	30'	Manual	Yes
CPSE1022(A)	1	208/230	1	11.5/10.4	20'	M (Wide-Angle Float)	No
CPSEF1022(A)	1	208/230	1	12.2/11	20'	M (Wide-Angle Float)	No
CPSE1033	1	230	3	7.6	30'	Manual	Yes
CPSEF1033	1	230	3	8	30'	Manual	Yes
*CPSE1043	1	460	3	3.8	30'	Manual	Yes
*CPSEF1043	1	460	3	4	30'	Manual	Yes
CPSE1522(A)	1-1/2	208/230	1	14.7/13.3	20'	M (Wide-Angle Float)	No
CPSE1533	1-1/2	208/230	3	10.5/9.5	30'	Manual	Yes
*CPSE1543	1-1/2	460	3	4.8	30'	Manual	Yes
CPSE2022(A)	2	208/230	1	16.4/14.8	20'	M (Wide-Angle Float)	No
CPSEF2022(A)	2	208/230	1	16.4/14.8	20'	M (Wide-Angle Float)	No
CPSE2033	2	208/230	3	12.1/11	30'	Manual	Yes
CPSEF2033	2	208/230	3	12.1/11	30'	Manual	Yes
*CPSE2043	2	460	3	5.5	30'	Manual	Yes
*CPSEF2043	2	460	3	5.5	30'	Manual	Yes

Champion
+ Pump

CPSTEP

1/2 - 2HP
EFFLUENT

Every pump tested in water to ensure pump
meets performance curve.



FEATURES/BENEFITS

PERFORMANCE

Heads up to 124' TDH
Flows up to 122 GPM

MOTOR (Single Phase)

High efficient, 115v or 230v, oil filled,
permanent split capacitor motor with upper
and lower ball bearings and thermal overload
protection

- Constant bearing lubrication
- Maximum motor cooling
- Runs cooler and lasts longer
- Internal overload protection
- Quiet operation
- Fasteners and shaft made from rugged,
corrosion resistant stainless steel

SEAL DESIGN

Single, mechanical, oil filled chamber

- Optional double seal series models
available that provides additional protection
and moisture sensing capabilities
- Optional seal failure feature that will alert
you when the seal has failed

IMPELLER DESIGN

1 or 2 vane cast iron impeller

- Designed to help reduce clogging by foreign
material

POWER CORD

Sealed entry quick disconnect power cords

- Prevents water from entering the motor
housing through a cut cord
- Easy to replace in the field
- Available in lengths up to 100'

SWITCH

Piggy-back switch design (Single Phase)

- Defective switches can be diagnosed over
the phone
- Pump can be operated manually or
supplied with other piggy-back switches
- Switch can be replaced without having to
replace the pump

APPLICATIONS

Dewatering, septic systems, residential
and commercial developments, elevator
pits and STEP systems



1/2-2 HP high head effluent pumps that handle
up to 3/4" solids with 2" discharge

PERFORMANCE CURVE

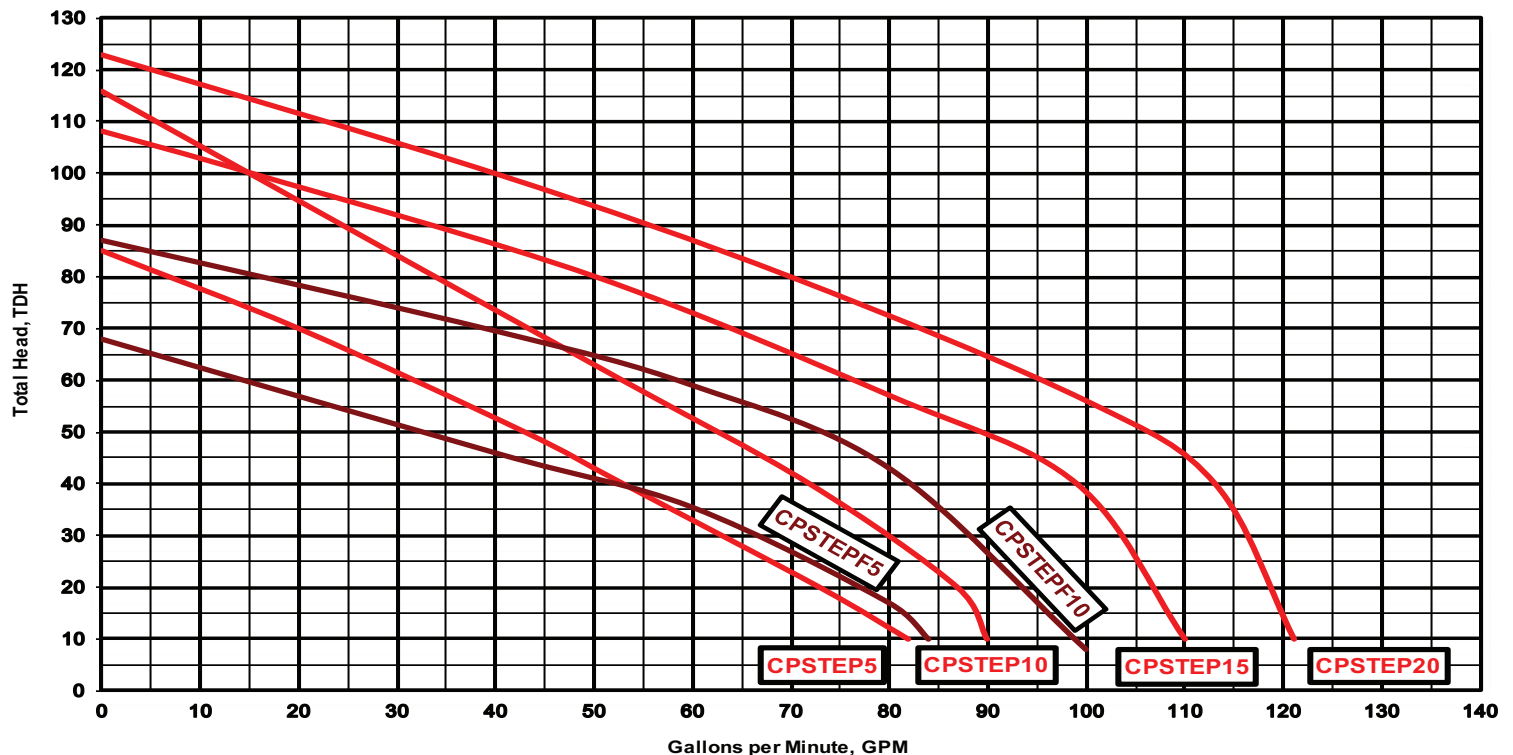

Champion Pump Company, Inc • P.O. Box 528 • Ashland, OH 44805
Phone 419-281-4500 • Fax 419-616-1100 • www.championpump.com

REV 0817

TECHNICAL DATA

DISCHARGE	2" NPT. vertical standard
SOLIDS HANDLING	3/4"
LIQUID TEMPERATURE	140 Degrees F. (Intermittent)
MOTOR HOUSING	Cast Iron
VOLUTE	Cast Iron
SEAL PLATE	Cast Iron
IMPELLER	Cast Iron / 1 or 2 Vane
SHAFT	Stainless Steel
SHAFT SEAL (SINGLE SEAL)	Single mechanical, carbon rotating face, ceramic stationary face, Buna-N elastomer, 300 series stainless steel hardware
SHAFT SEAL (DOUBLE SEAL)	Tandem double mechanical upper & lower, carbon ceramic, Buna-N elastomer, 300 stainless steel hardware
BEARINGS (UPPER & LOWER)	Single row, ball, oil lubricated
HARDWARE	300 Series stainless steel
O-RINGS	Buna-N
CORD	20' Length standard. Up to 100' available. UL/CSA (SJOW) 14/3 (.375 OD) Quick disconnect pin terminals *UL/CSA (SO) Cord 14 Ga. (.60 OD)
MOTOR (SINGLE PHASE)	1/2-2 HP 3450 RPM. 60 Hz, Includes overload protection in the motor, oil filled, class F permanent split capacitor
MOTOR (THREE PHASE)	1/2-2 HP 3450 RPM. 60 Hz, oil filled, requires overload protection to be included in control panel
WEIGHT	72 lbs. (Manual)

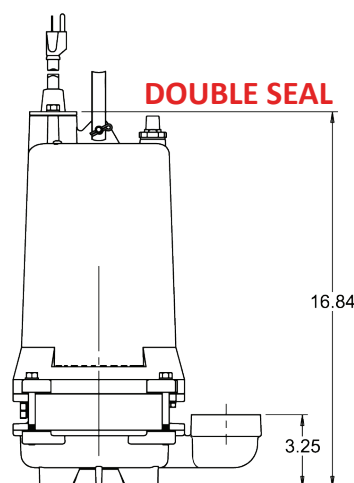
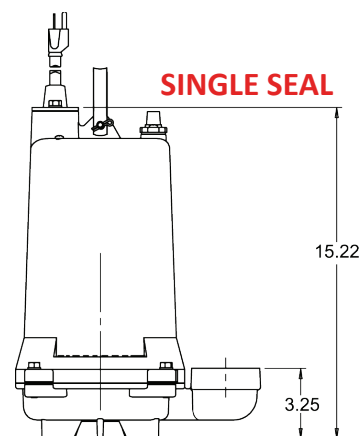
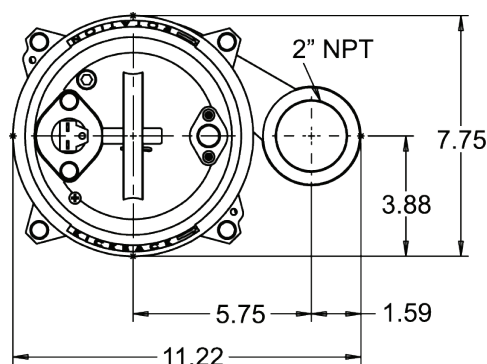

MODEL(S) INFORMATION

MODEL	HP	VOLTS	PHASE	AMPS	CORD LENGTH	SWITCH	REQUIRES PANEL
CPSTEP512(A)	1/2	115	1	13.8	20'	M (Wide-Angle Float)	No
CPSTEP522(A)	1/2	230	1	6.9	20'	M (Wide-Angle Float)	No
CPSTEP532	1/2	230	3	4.6	20'	Manual	Yes
CPSTEP542	1/2	460	3	2.3	20'	Manual	Yes
CPSTEP1022(A)	1	230	1	10.4	20'	M (Wide-Angle Float)	No
CPSTEP1032	1	230	3	7.6	20'	Manual	Yes
CPSTEP1042	1	460	3	3.8	20'	Manual	Yes
CPSTEP1522(A)	1-1/2	230	1	12	20'	M (Wide-Angle Float)	No
CPSTEP1532	1-1/2	230	3	8.4	20'	Manual	Yes
CPSTEP1542	1-1/2	460	3	4.2	20'	Manual	Yes
CPSTEP2022(A)	2	230	1	14.8	20'	M (Wide-Angle Float)	No
CPSTEP2032	2	230	3	11	20'	Manual	Yes
CPSTEP2042	2	460	3	5.5	20'	Manual	Yes

Champion Pump Company, Inc • P.O. Box 528 • Ashland, OH 44805
Phone 419-281-4500 • Fax 419-616-1100 • www.championpump.com

REV 0817

Every pump tested in water to ensure pump meets performance curve.



FEATURES/BENEFITS

PERFORMANCE

Heads up to 34' TDH
Flows up to 109 GPM

MOTOR

High efficient, 115v or 230v, oil filled, permanent split capacitor motor with upper and lower ball bearings and thermal overload protection

- Constant bearing lubrication
- Maximum motor cooling
- Runs cooler and lasts longer
- Internal overload protection
- Quiet operation
- Fasteners and shaft made from rugged, corrosion resistant stainless steel

SEAL DESIGN

Type 21 inboard seal design with secondary exclusion seal

- Rotating components of seal are in the motor housing, being lubricated by the motor oil preventing foreign matter from wrapping around the seal components
- Seal will last longer if the pump runs dry
- Secondary exclusion seal keeps debris from entering the seal cavity

IMPELLER DESIGN

Non-clog style, cast-iron vortex impeller

- Designed to help reduce clogging by foreign material

POWER CORD

Sealed entry quick disconnect power cords

- Prevents water from entering the motor housing through a cut cord
- Easy to replace in the field
- Available in lengths up to 100'

SWITCH

Piggy-back switch design

- Defective switches can be diagnosed over the phone
- Pump can be operated manually or supplied with other piggy-back switches
- Switch can be replaced without having to replace the pump

APPLICATIONS

Basements, dewatering, septic systems, sewage lift stations, add-a-baths and truck docks



Wide-angle Float

Vertical Float

1/2 HP submersible pumps that handle up to 2" solids with 2" discharge

PERFORMANCE CURVE

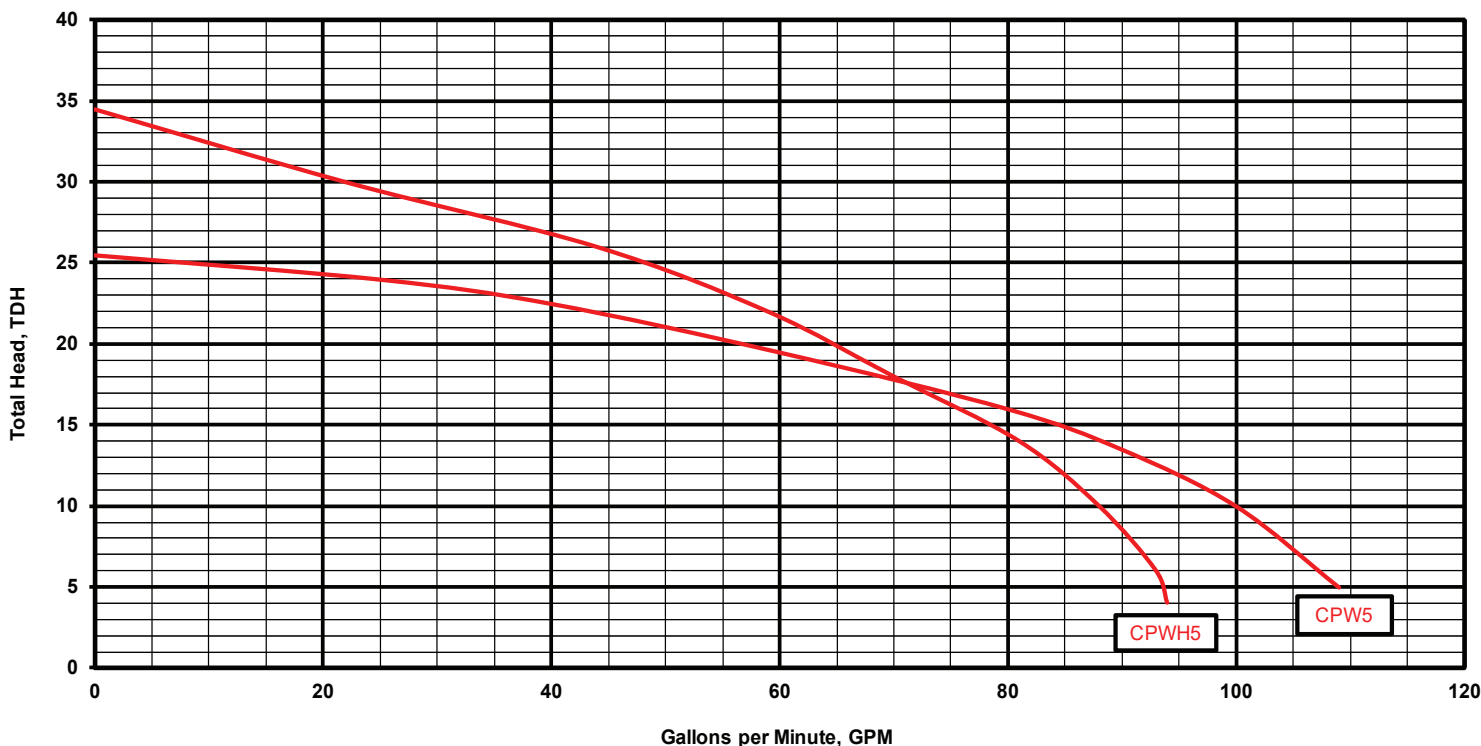

TECHNICAL DATA

DISCHARGE	2" NPT. vertical standard
SOLIDS HANDLING	2" CPW, 1-1/2" CPWH
LIQUID TEMPERATURE	140 Degrees F. (Intermittent)
MOTOR HOUSING	Cast Iron
VOLUTE	Cast Iron
SEAL PLATE	Cast Iron
IMPELLER	Cast Iron / Vortex
SHAFT	Stainless Steel
SHAFT SEAL (SINGLE SEAL)	Inboard mechanical with secondary exclusion V-Seal, carbon rotating face, ceramic stationary face, Buna-N elastomer, 300 series stainless steel hardware
BEARINGS (UPPER & LOWER)	Single row, ball, oil lubricated
HARDWARE	300 Series stainless steel
O-RINGS	Buna-N
CORD	10' Length standard. Up to 100' available. (UL/CUL) Listed 16 AWG, Type SJTW
MOTOR (SINGLE PHASE)	1/2 HP 3450 RPM, 60 Hz, NEMA L Includes overload protection in the motor, oil filled, class B permanent split capacitor
WEIGHT	37 lbs. (Manual)

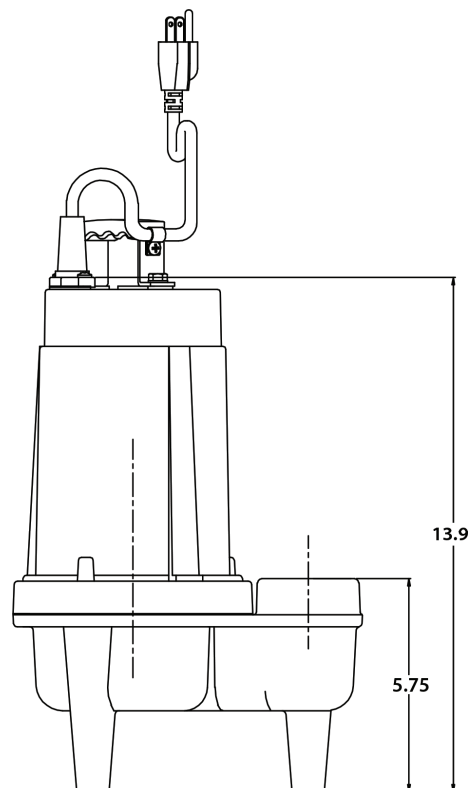
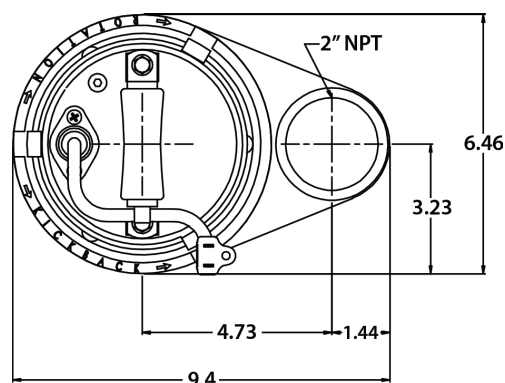

MODEL(S) INFORMATION

MODEL	HP	VOLTS	PHASE	AMPS	CORD LENGTH	SWITCH
CPW5-11 / CPWH5-11	1/2	115	1	11.5	10'	Manual
CPW5-12 / CPWH5-12	1/2	115	1	11.5	20'	Manual
CPW5-13 / CPWH5-13	1/2	115	1	11.5	30'	Manual
CPW5-15 / CPWH5-15	1/2	115	1	11.5	50'	Manual
CPW5A-11 / CPWH5A-11	1/2	115	1	11.5	10'	Wide-Angle Float
CPW5A-12 / CPWH5A-12	1/2	115	1	11.5	20'	Wide-Angle Float
CPW5A-13 / CPWH5A-13	1/2	115	1	11.5	30'	Wide-Angle Float
CPW5V-11 / CPWH5V-11	1/2	115	1	11.5	10'	Vertical Float
CPW5V-12 / CPWH5V-12	1/2	115	1	11.5	20'	Vertical Float
CPW5V-13 / CPWH5V-13	1/2	115	1	11.5	30'	Vertical Float
CPW5-22 / CPWH5-22	1/2	230	1	5.75	20'	Manual
CPW5A-22 / CPWH5A-22	1/2	230	1	5.75	20'	Wide-Angle Float
CPW5V-22 / CPWH5V-22	1/2	230	1	5.75	20'	Vertical Float

Every pump tested in water to ensure pump meets performance curve.



FEATURES/BENEFITS

PERFORMANCE

Heads up to 133' TDH
Flows up to 44 GPM

MOTOR

Internal capacitor run 115v or 208-230v, oil filled motors with upper and lower ball bearings and thermal overload protection.

- Constant bearing lubrication
- Maximum motor cooling
- Runs cooler and lasts longer
- Internal overload protection
- Quiet operation
- Fasteners and shaft made from rugged, corrosion resistant stainless steel

SEAL DESIGN

Single, mechanical, running in oil filled chamber allowing dry run and cooling

IMPELLER DESIGN

Non-clog style, cast-iron vortex impeller

- Designed to generate higher heads and reduce clogging by foreign materials
- Provides non-overloading performance

CUTTER ASSEMBLY

440 SST (56-60 Rockwell)

- 24,000 cuts per second and 1.5 million cuts a minute
- Designed to reduce over loading and clogging

POWER CORD

Sealed entry quick disconnect power cords

- Prevents water from entering the motor housing through a cut cord
- Easy to replace in the field without having to run a new power cord
- Available in lengths up to 100'

SWITCH

Piggy-back switch design

- Defective switches can be diagnosed over the phone
- Pump can be operated manually or supplied with other piggy-back switches
- Switch can be replaced

APPLICATIONS

Residential developments, commercial developments and wastewater applications



1 & 2 HP grinder pumps that have a 1 1/4" vertical discharge (optional 2" adapter available), and can grind up to 3" solids, and be installed on a rail system or with the supplied legs

PERFORMANCE CURVE

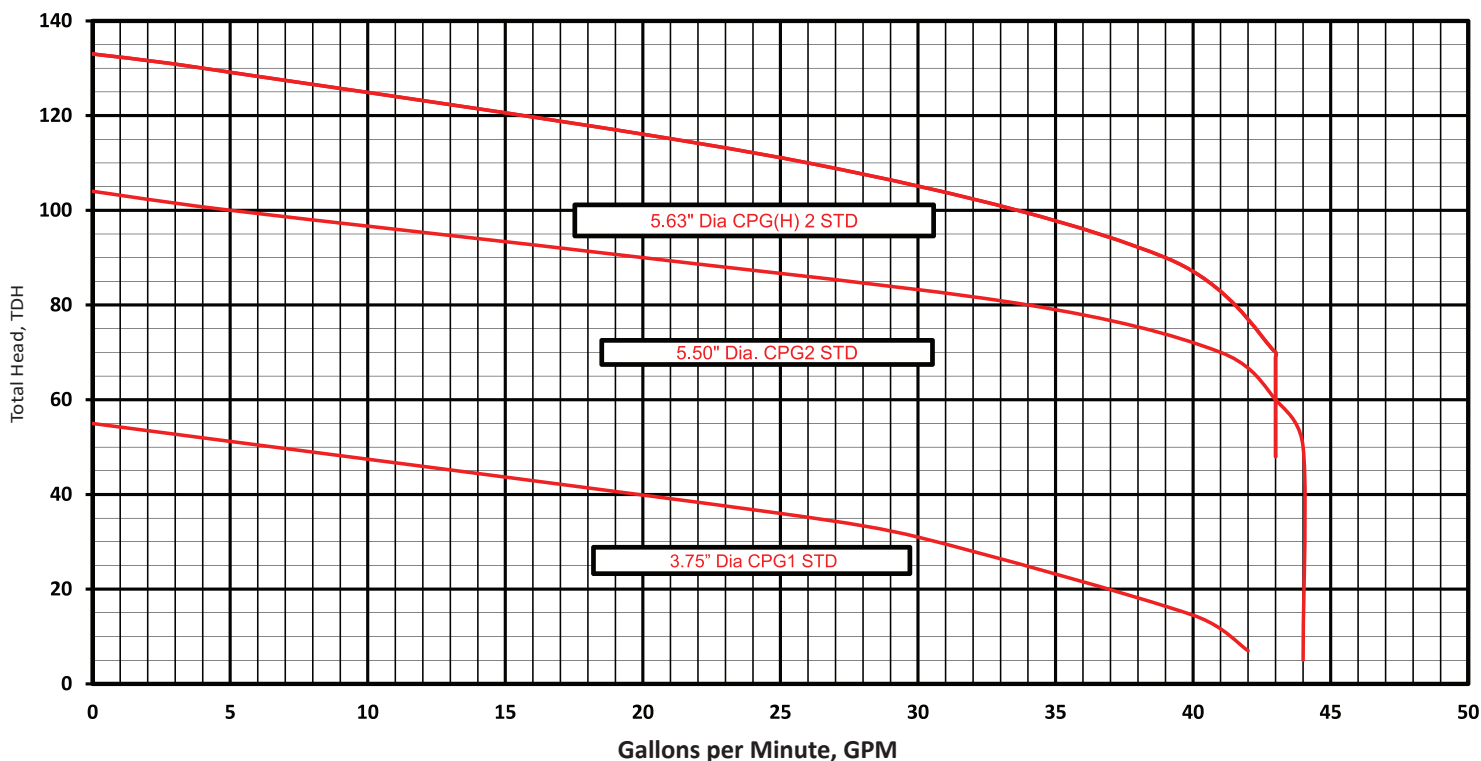

TECHNICAL DATA

DISCHARGE	1 1/4" NPT. Vertical standard or optional 2"
LIQUID TEMPERATURE	140 Degrees F. (Intermittent)
MOTOR HOUSING	Cast Iron
VOLUTE	Cast Iron
SEAL PLATE	Cast Iron
IMPELLER	Cast Iron / Vortex
SOLIDS HANDLING	3"
SHAFT	Stainless Steel
SEAL PLATE	Cast Iron
SHAFT SEAL (SINGLE SEAL)	Single Mechanical, Carbon-Rotating Face, Ceramic-Stationary Face, Buna-N Elastomer, 300 Series Stainless Steel Hardware
BEARINGS (UPPER & LOWER)	Single Row, Ball, Oil Lubricated
HARDWARE	300 Series Stainless Steel
O-RINGS	Buna-N
CORD	10' Length standard. Up to 30' with plug and 100' without plug. (UL/CSA) (SO) 14 AWG (.375 OD), Type SJOW
MOTOR (SINGLE PHASE)	1 or 2 HP 3450 RPM. 60Hz, Includes Overload Protection in the Motor. Oil Filled, Class F Permanent Split Capacitor
WEIGHT	78 lbs. (Manual)

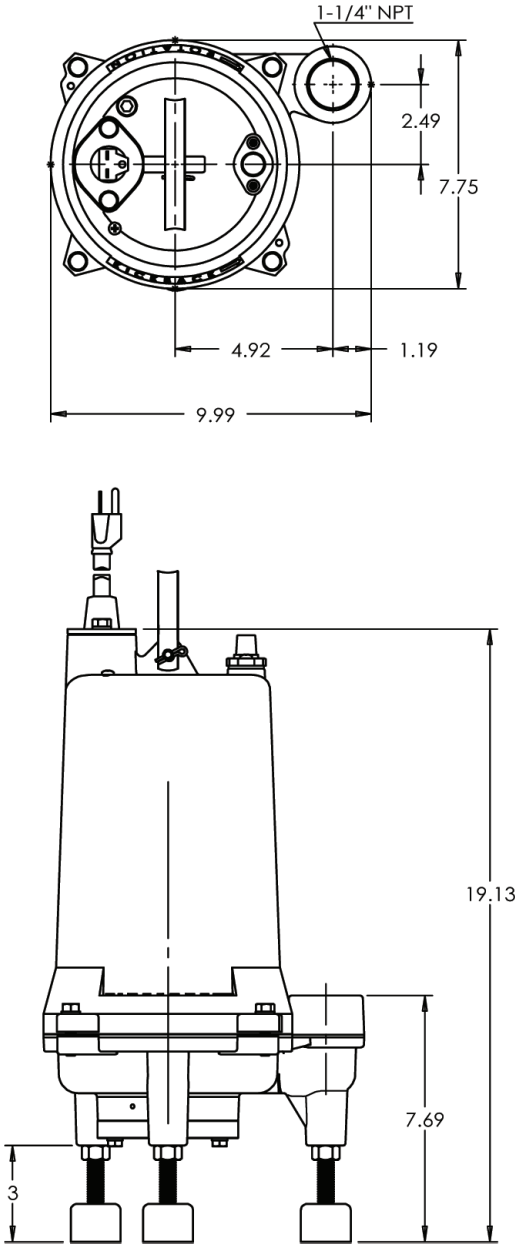

MODEL(S) INFORMATION

MODEL	HP	VOLTS	PHASE	AMPS	CORD LENGTH	SWITCH	REQUIRES PANEL
CPG1011V	1	115	1	13	10'	Vertical Float	No
CPG1012V	1	115	1	13	20'	Vertical Float	No
CPG1011(A)	1	115	1	13	10'	M (Wide-Angle Float)	No
CPG1012(A)	1	115	1	13	20'	M (Wide-Angle Float)	No
CPG1022(A)	1	208/230	1	7.2/6.5	20'	M (Wide-Angle Float)	No
CPG2021(A)	2	208/230	1	17/15	10'	M (Wide-Angle Float)	No
CPG2022(A)	2	208/230	1	17/15	20'	M (Wide-Angle Float)	No
CPGH2021(A)	2	208/230	1	17/15	10'	M (Wide-Angle Float)	No
CPGH2022(A)	2	208/230	1	17/15	20'	M (Wide-Angle Float)	No