

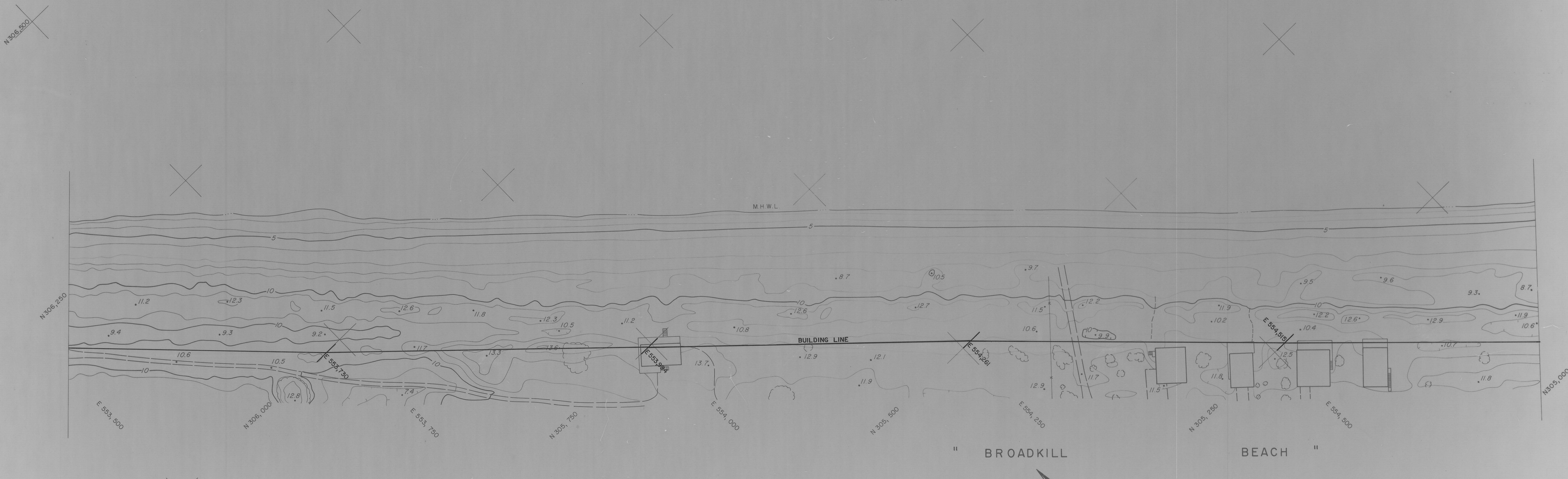

DELAWARE BAY



DATE OF PHOTOGRAPHY: AUGUST 31, 1979

APPROVED: *Thomas E. Selma*  
PROFESSIONAL LAND SURVEYOR

STATE OF DELAWARE  
DEPARTMENT OF NATURAL RESOURCES AND ENVIRONMENTAL CONTROL  
DIVISION OF SOIL AND WATER CONSERVATION  
TOPOGRAPHIC MAPPING OF DELAWARE BEACHES  
PICKERING BEACH TO CAPE HENLOPEN

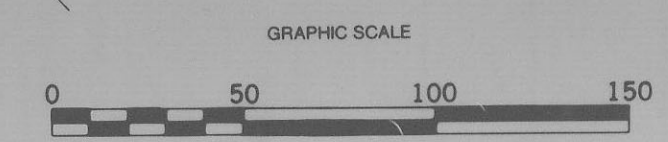

PREPARED BY  
PHOTO SCIENCE, INC.  
GAITHERSBURG, MARYLAND

VANDEMARK & LYNCH, INC.  
CONSULTANTS-ENGINEERS-SURVEYORS  
4305 MILLER ROAD - P.O. BOX 2047  
WILMINGTON, DELAWARE 19899

DATE	SEPTEMBER 1979	DRAWING NO	15479-19555-B
SCALE	1" = 50'	SHEET	28 OF 79