

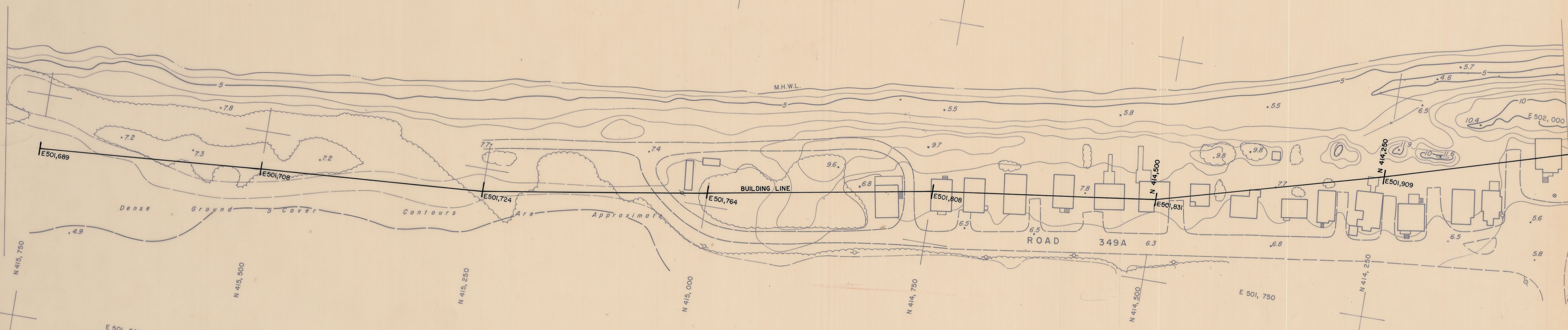

DELAWARE BAY



PICKERING BEACH

DATE OF PHOTOGRAPHY OCTOBER 22, 1979

STATE OF DELAWARE  
 DEPARTMENT OF NATURAL RESOURCES AND ENVIRONMENTAL CONTROL  
 DIVISION OF SOIL AND WATER CONSERVATION  
 TOPOGRAPHIC MAPPING OF DELAWARE BEACHES  
 PICKERING BEACH TO CAPE HENLOPEN

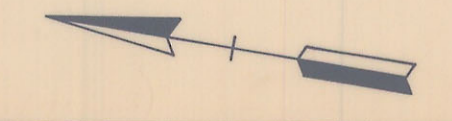
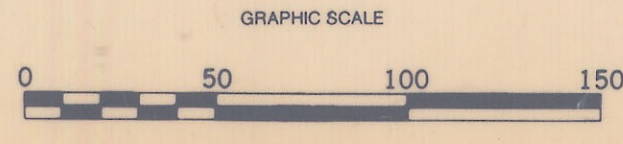

APPROVED: *William D. DeLoach*  
 PROFESSIONAL LAND SURVEYOR

PREPARED BY  
 PHOTO SCIENCE, INC.  
 GAITHERSBURG, MARYLAND

VANDEMARK & LYNCH, INC.  
 CONSULTANTS-ENGINEERS-SURVEYORS  
 4305 MILLER ROAD - P.O. BOX 2047  
 WILMINGTON, DELAWARE 19899

DATE	SEPTEMBER 1979	DRAWING NO	15479-19555-B
SCALE	1" = 50'	SHEET	79 OF 79